

PRECINCT STANDARD TABLE

ALL DIMENSIONS IN MILLIMETRES - DO NOT SCALE

2400mm TABLE - BOLT BELOW

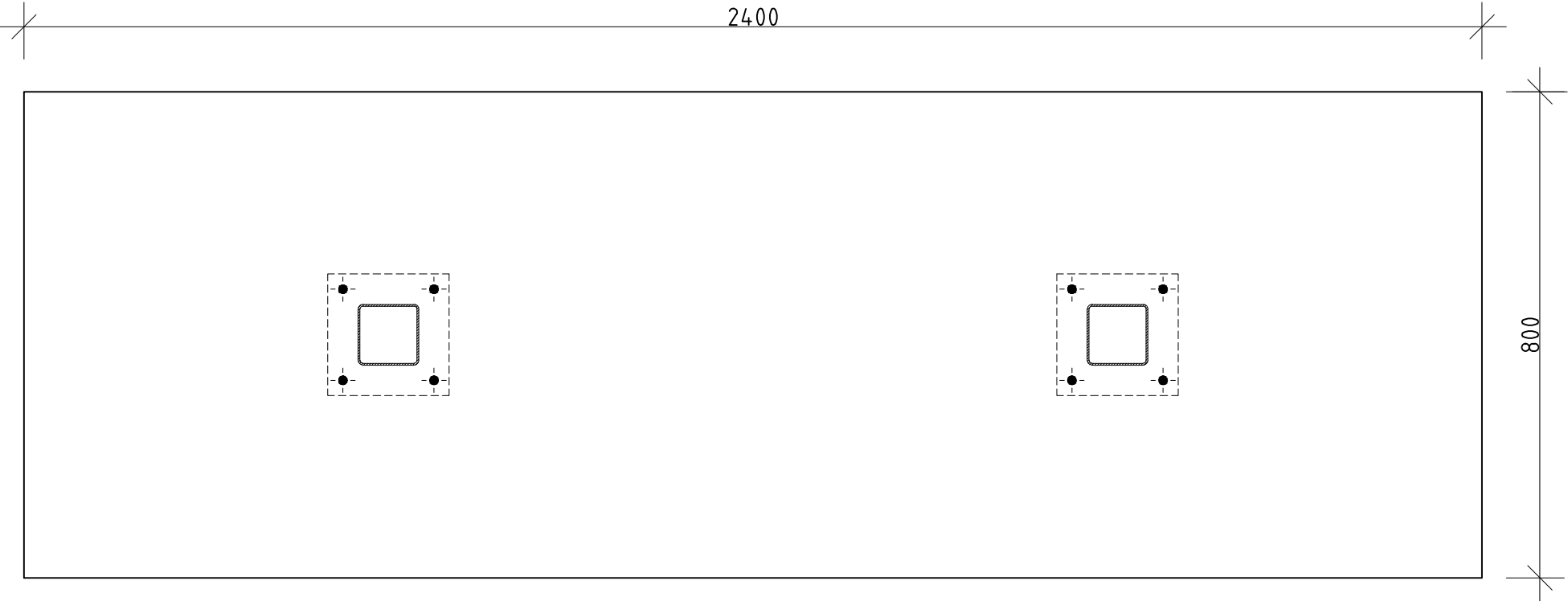

1 PLAN
1:10 @ A3

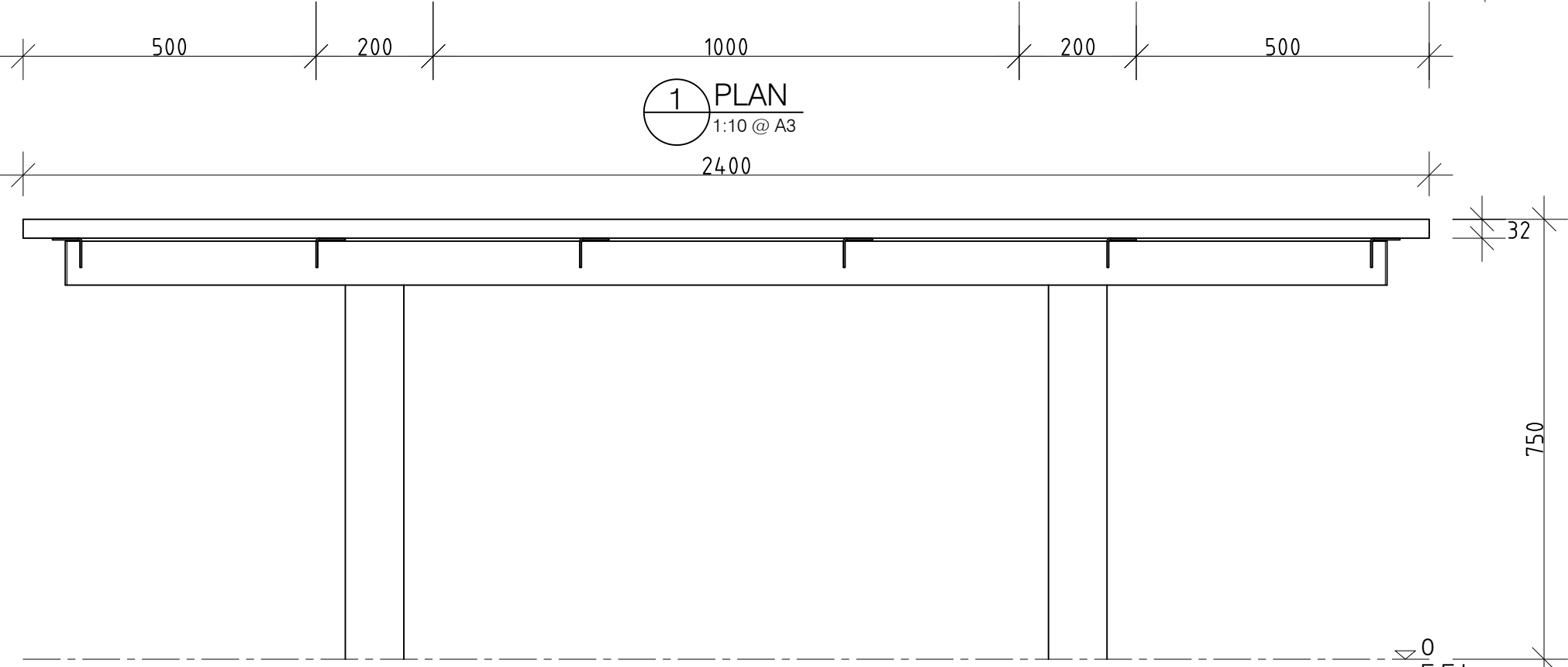

2 FRONT ELEVATION
1:10 @ A3



4 PERSPECTIVE
N.T.S.

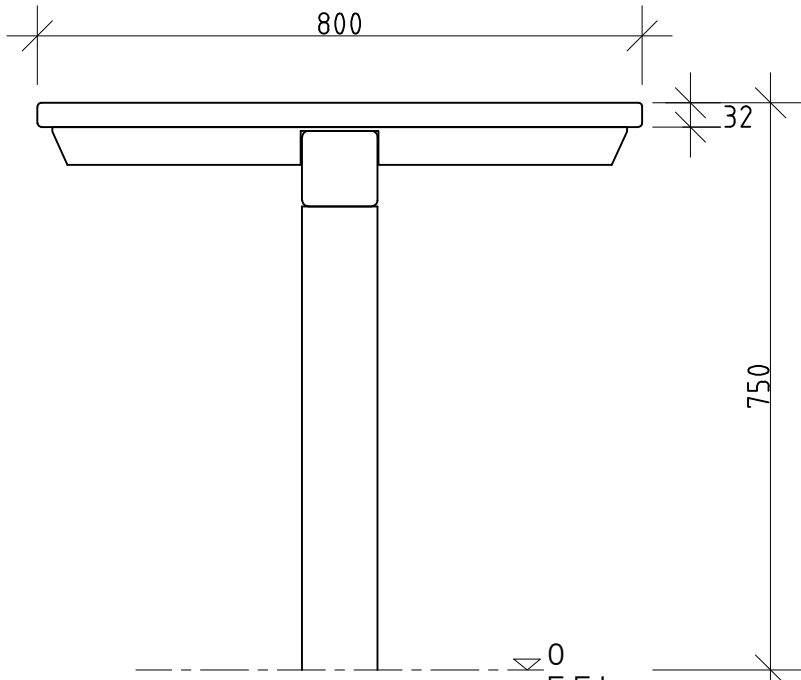

3 END ELEVATION
1:10 @ A3

REVISION		DATE:	DRAWN BY.	 © FURPHY FOUNDRY PTY LTD THIS DOCUMENT IS AND SHALL REMAIN THE PROPERTY OF FURPHY FOUNDRY. UNAUTHORISED USE OF THIS DOCUMENT IN ANY FORM IS PROHIBITED.	 Furphy Foundry Pty Ltd PH: (03) 5831 2777 A.B.N. 24 007 195 913 FAX: (03) 5831 2681 21 Drummond Rd, www.furphyfoundry.com.au Shepparton VIC 3630 sales@furphyfoundry.com.au	CLIENT NAME FURPHY FOUNDRY		PROJECT No. FFSB003500	PAGE A3
6	-	-	-			PROJECT PRECINCT RANGE PRECINCT TABLE - 2400mm	DATE: 18-12-19	DRAWN PS	
5	-	-	-			DRAWING No. FFSB003500	SCALE NOTED		
4	-	-	-			DRAWING TITLE PRELIMINARY	SHEET No. 001	REV. 0	
3	-	-	-						
2	-	-	-						
1	-	-	-						

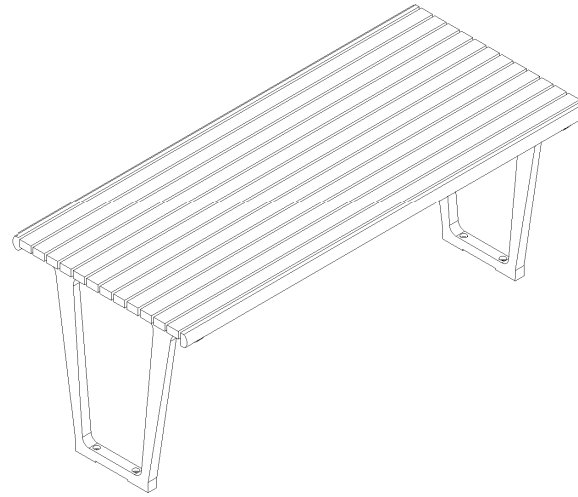
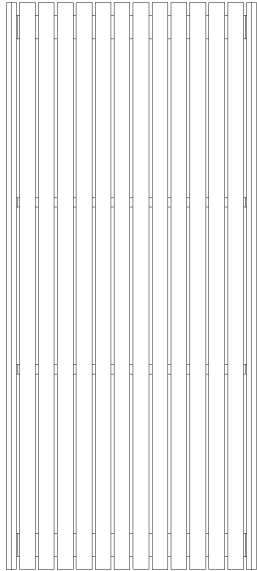

SPECIFICATION:

MATERIALS:

Main construction - Cast aluminium
Timbers - Hard wood
Straps - Stainless steel
Fixings - Stainless steel

DIMENSIONS:

mm unless otherwise stated

FINISH:

Castings - Mill Finish or Powdercoat
Timber - Oil based

GROUND FIXINGS:

Bolt down



Quality
ISO 9001
SAI GLOBAL

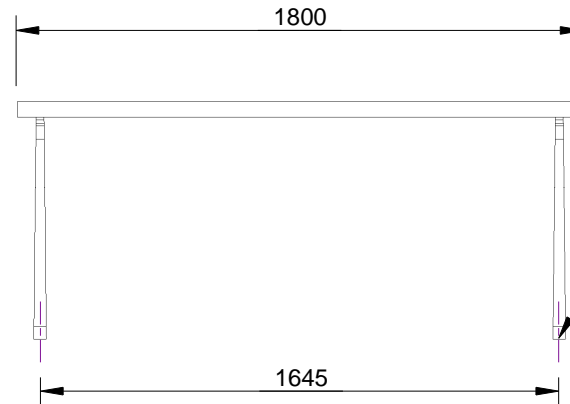
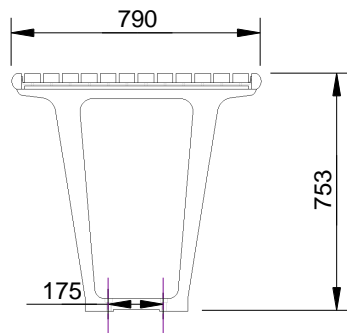

BOLT DOWN DETAIL

Ø14 THRU
Ø24 C.B.
4 LOCATIONS



CONFIDENTIAL

REVISION	#	DESCRIPTION	BY	DATE	DRAWN	DRAWN DATE	CHECKED	CHECKED DATE	SCALE	A4
	1	ORIGINAL DRAWING	DN	22.9.10	R.CRIGTON	4.12.13			N/A	
	2	FULL PRODUCT REVIEW	RBC	4.12.13			METRO TABLE SPEC.			
	3									
	4									
	5									
									FFSA003001	REV. 2

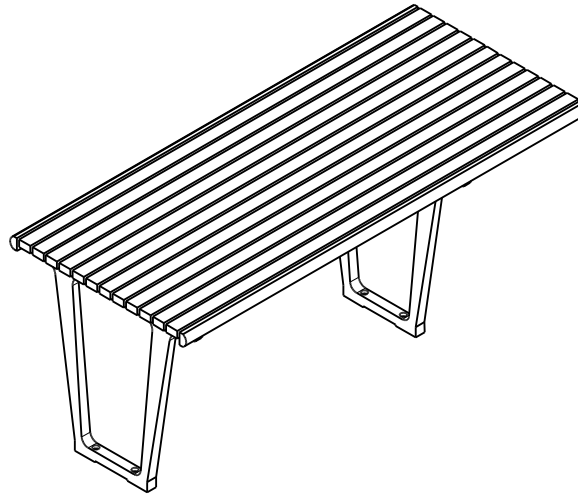
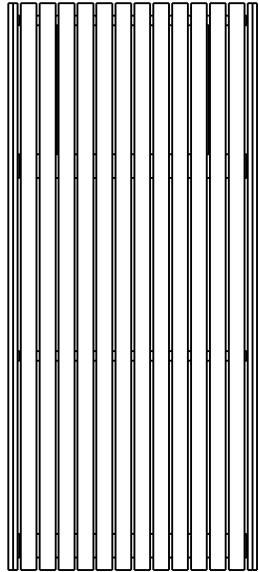

SPECIFICATION:

MATERIALS:

Main construction - Cast aluminium
Timbers - Hard wood
Straps - Stainless steel
Fixings - Stainless steel

DIMENSIONS:

mm unless otherwise stated

FINISH:

Castings - Mill Finish or Powdercoat
Timber - Oil based

GROUND FIXINGS:

Bolt down

WHEEL CHAIR ACCESS:

One end

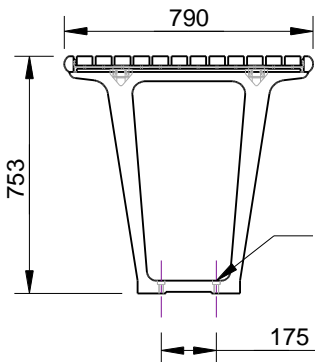

BOLT DOWN DETAIL
Ø14 THRU
Ø24 C.B.
4 LOCATIONS

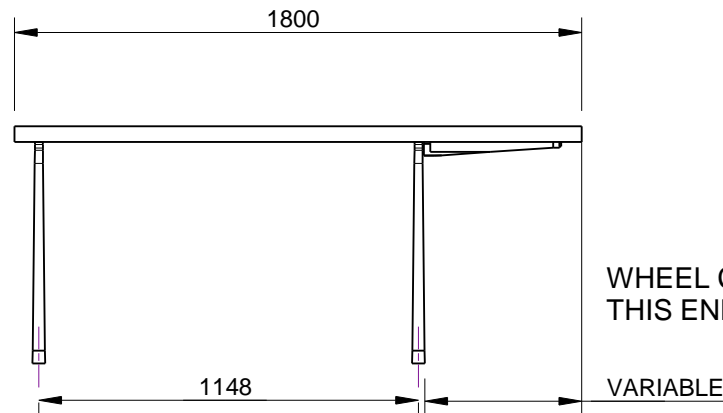

WHEEL CHAIR ACCESS
THIS END

© copyright

CONFIDENTIAL

REVISION	#	DESCRIPTION	BY	DATE	DRAWN	DRAWN DATE	CHECKED	CHECKED DATE	SCALE	A4
	1	ORIGINAL DRAWING	DN	19.10.10	R.CRIGTON	4.12.13			N/A	
	2	FULL PRODUCT REVIEW	RBC	4.12.13						
	3									
	4									
	5									
						METRO TABLE WCA - ONE END SPEC.				
						FFSA003002		REV. 2	SHEET 1 OF 3	

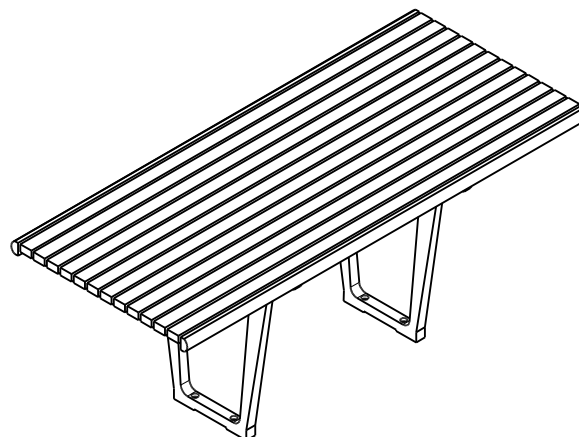
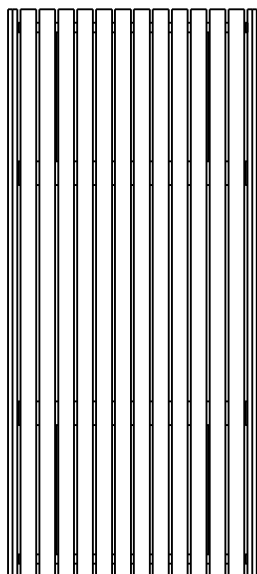

SPECIFICATION:

MATERIALS:

Main construction - Cast aluminium
Timbers - Hard wood
Straps - Stainless steel
Fixings - Stainless steel



Quality
ISO 9001
SAI GLOBAL

DIMENSIONS:

mm unless otherwise stated

FINISH:

Castings - natural
Timber - Oil based

GROUND FIXINGS:

Bolt down

WHEEL CHAIR ACCESS:

Both ends

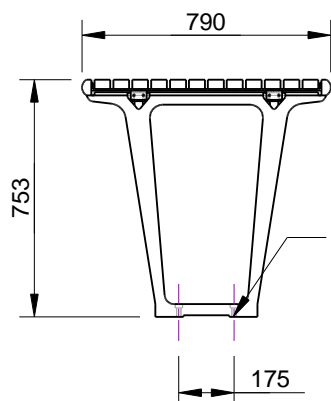

BOLT DOWN DETAIL

Ø14 THRU
Ø24 C.B.
4 LOCATIONS

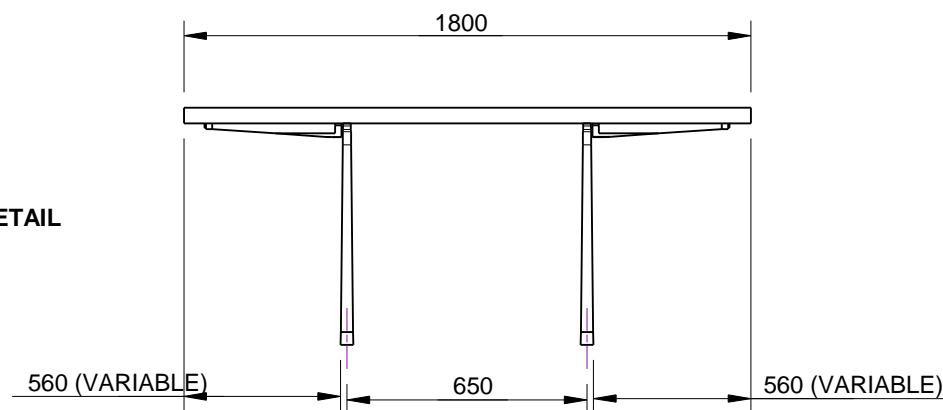

copyright

CONFIDENTIAL

REVISION	#	DESCRIPTION	BY	DATE	DRAWN	DRAWN DATE	CHECKED	CHECKED DATE	SCALE	A4
	1	ORIGINAL DRAWING	DN	22.9.10	R.CRIGTON	4.12.13			N/A	
	2	FULL PRODUCT REVIEW	RBC	4.12.13						
	3									
	4									
	5									
						METRO TABLE WCA - BOTH ENDS SPEC.				
						FFSA003003			REV. 2	SHEET 1 OF 3

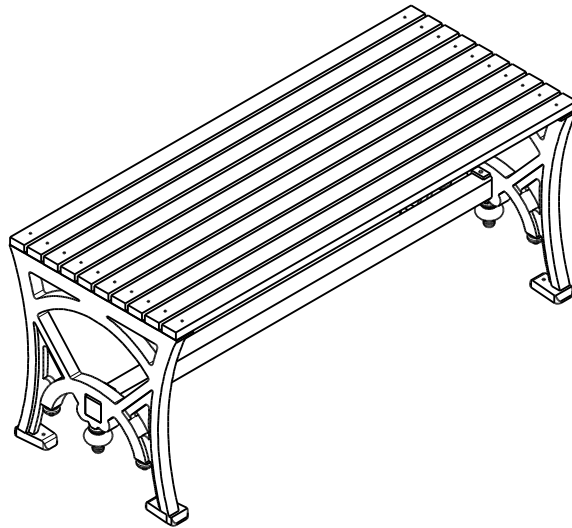
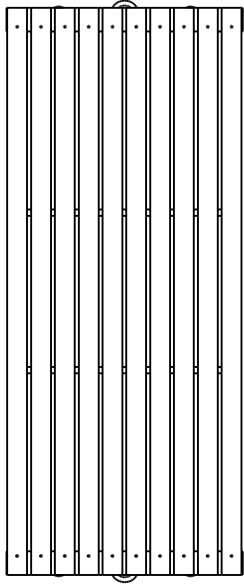

SPECIFICATION:

MATERIALS:

Main construction - Cast aluminium
Timbers - Hard wood
Straps - Powdercoat
Fixings - Zinc

DIMENSIONS:

mm unless otherwise stated

FINISH:

Castings - Powdercoat
Timber - Oil based

GROUND FIXINGS:

Bolt down



Quality
ISO 9001
SAI GLOBAL

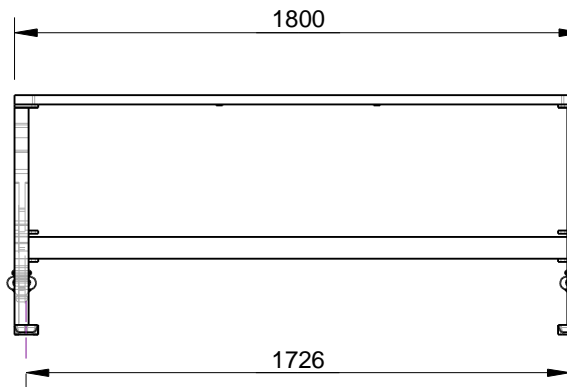
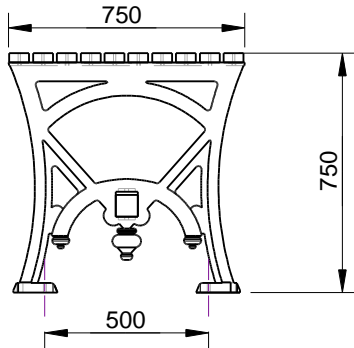

BOLT DOWN DETAIL

Ø10 THRU
4 LOCATIONS

© copyright

CONFIDENTIAL

REVISION	#	DESCRIPTION	BY	DATE	DRAWN	DRAWN DATE	CHECKED	CHECKED DATE	SCALE	A4
	1	ORIGINAL DRAWING	DN	17.9.10	R.CRIGTON	4.12.13			N/A	
	2	FULL PRODUCT REVIEW	RBC	4.12.13						
	3									
	4									
	5									
						HERITAGE TABLE SPEC.				
						FFSA003006		REV. 2	SHEET 1 OF 3	

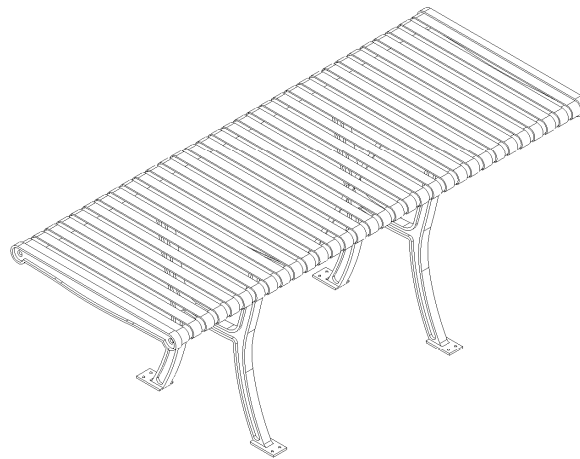
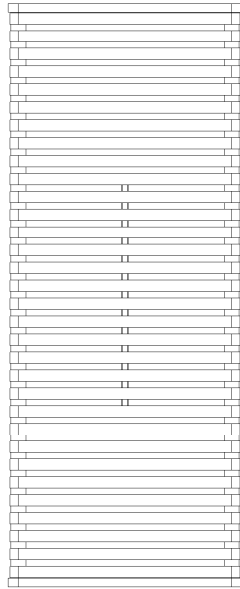

SPECIFICATION:

MATERIALS:

Main construction - Cast aluminium
Slats - Mild Steel
Support pipes - Mild Steel

DIMENSIONS:

mm unless otherwise stated

FINISH:

Castings - Milled or Powder coat (optional)
Slats - Galvanised with optional powder coat

GROUND FIXINGS:

Bolt down

WHEEL CHAIR ACCESS:

Both ends



Quality
ISO 9001

SAI GLOBAL

BOLT DOWN DETAIL

Ø10 THRU
8 LOCATIONS

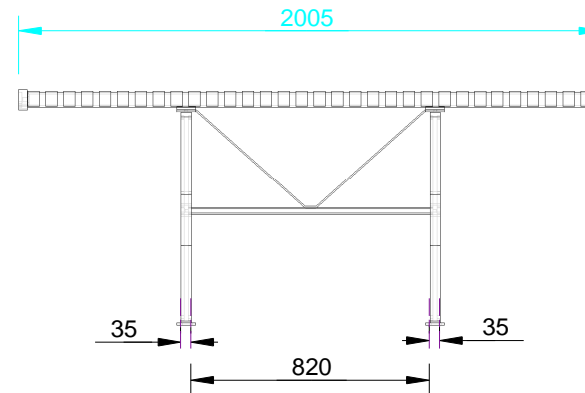
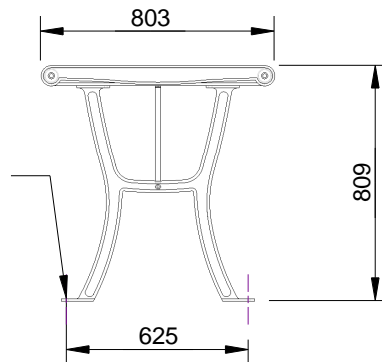

© copyright

CONFIDENTIAL

REVISION	#	DESCRIPTION	BY	DATE	DRAWN	DRAWN DATE	CHECKED	CHECKED DATE	SCALE	A4	
	1	ORIGINAL DRAWING	DN	17.11.10	R.CRIGTON	5.12.13			N/A		
	2	FULL PRODUCT REVIEW	RBC	5.12.13			STEEL SLATTED COUNCIL TABLE SPEC.				
	3										
	4						FFSA003007				
	5										REV. 2

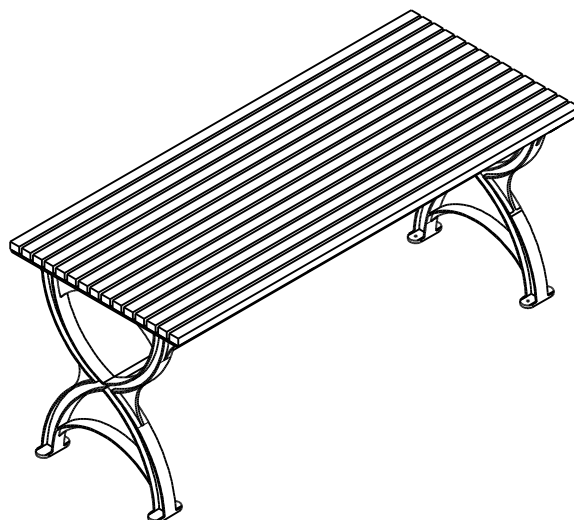
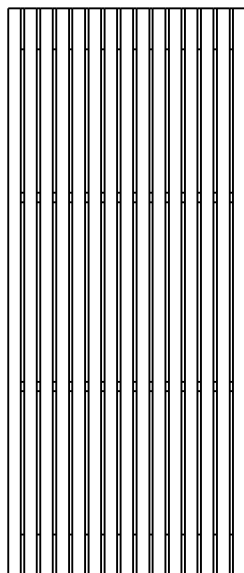

SPECIFICATION:

MATERIALS:

Main construction - Cast Aluminium
Slats - Harwood Timber
Pipes & Brace - Mild Steel
Straps - Stainless Steel 304

DIMENSIONS:

mm unless otherwise stated

FINISH:

Castings - Milled or Powder coat (optional)
Timbers - Oil Based
Pipes & Brace - Powder coat or galvanised

GROUND FIXINGS:

Bolt down



Quality
ISO 9001
SAI GLOBAL

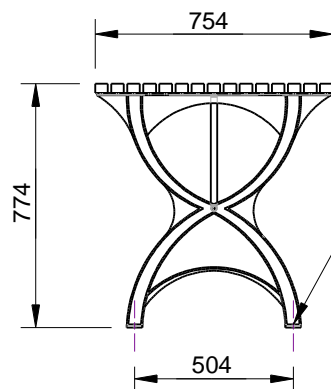

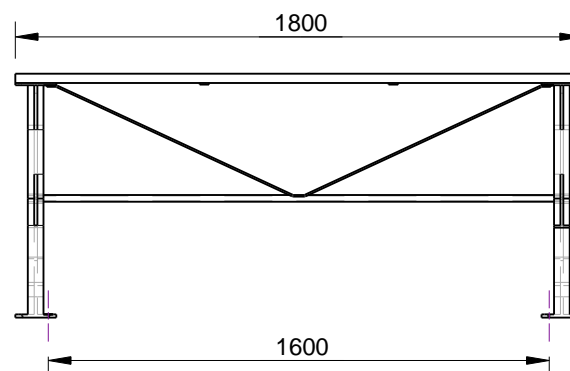

BOLT DOWN DETAIL

Ø10 THRU
4 LOCATIONS

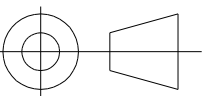

© copyright

CONFIDENTIAL

REVISION	#	DESCRIPTION	BY	DATE	DRAWN	DRAWN DATE	CHECKED	CHECKED DATE	SCALE	A4
	1	ORIGINAL DRAWING	DN	19.11.10	R.CRIGTON	5.12.13			N/A	
	2	FULL PRODUCT REVIEW	RBC	5.12.13						
	3									
	4									
	5									
							OMEGA TABLE SPEC.			
							FFSA003008	REV. 2	SHEET 1 OF 3	

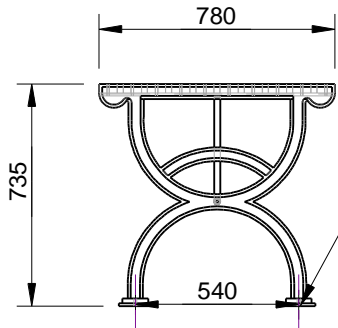
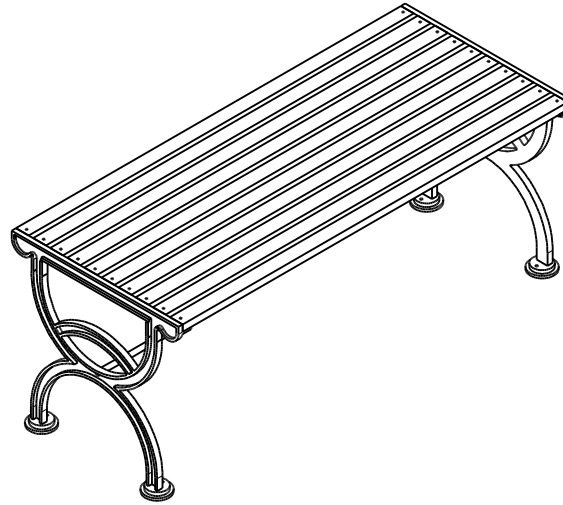
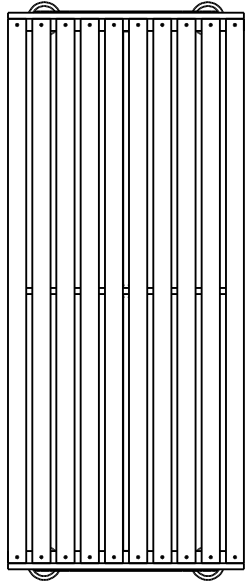

BOLT DOWN DETAIL
 Ø10 THRU
 4 LOCATIONS

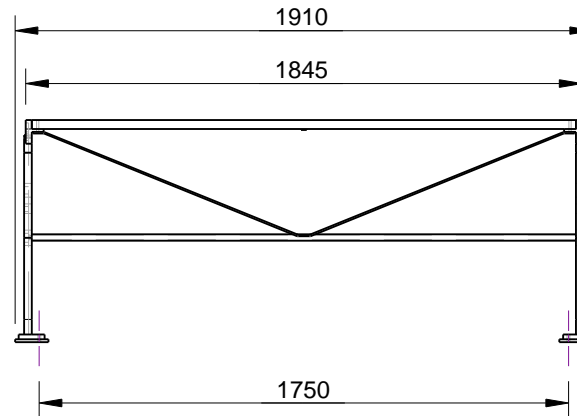

SPECIFICATION:

MATERIALS:

Main construction - Cast Aluminium
 Slats - Harwood Timber
 Pipes & Brace - Mild Steel
 Strap - Stainless Steel

DIMENSIONS:

mm unless otherwise stated

FINISH:

Castings - Milled or Powder coat (optional)
 Timbers - Oil Based
 Pipes & Brace - Powder coat

GROUND FIXINGS:

Bolt down



Quality
 ISO 9001
 SAI GLOBAL

© copyright

CONFIDENTIAL

REVISION	#	DESCRIPTION	BY	DATE	DRAWN	DRAWN DATE	CHECKED	CHECKED DATE	SCALE	A4	
	1	ORIGINAL DRAWING	DN	26.11.10	R.CRIGTON	5.12.13			N/A		
	2	FULL PRODUCT REVIEW	RBC	5.12.13			PLAZA TABLE SPEC.				
	3										
	4						FFSA003010				
	5										REV. 2

PROCEDURE:

CASTINGS & STRAPS:

1. Inspect and repair any imperfections, then fettie castings.
2. Using correct jigs, mark timber mounting holes to casting, centre punch and drill to 3/8.
3. Drill and countersink fixing hole for pipe brace in end castings to 7/16 and counter sink to 11/16.
4. Drill 5/16 hole for the angled brace to fix to end castings, the hole is central in end castings (see sheet 3)
3. Using correct jig, mark & drill straps to 9/32.
5. Using correct jig, mark & drill feet of castings to 7/16.
6. Using correct jig & dies bend 20x5 flat bar to create angled brace drill both ends to 5/16 before pressing brace.
7. Weld 3/8 nuts in both ends of pipe support for fixing to end castings clean and finish welds.
8. Weld angled brace to pipe support using correct jig.
9. Remove sharps and deburr holes.

TIMBERS:

1. Using correct jig, drill timber slat ends to 7/16.

ASSEMBLY:

1. Ensure you have all components.
2. Loosely bolt one timber to castings and stand upright.
3. Loosely bolt angled brace and pipe support in position.
3. Bolt remaining timbers in place.
4. Ensure table is square and timber gaps are uniform.
5. Tighten bolts.
6. Turn table upside down and using tek screws, fix straps in position, at equal distancing.
7. INSPECTION

ITEM	PART NUMBER	DESCRIPTION	QTY
1	WIPCASTGOV25	FIESTA TABLE END CASTING	2
2	RSCHS15NBM	PIPE 15NB STD WEIGHT, 1770 LG	1
3	RSFB20X5	M/S FLAT 20x5 1910 LG V BRACE	1
4	RSFB20X3	FLAT 20x3 740 LG TABLE STRAP	2
5	TIMCHA63X30X1800	TIMBER SLAT 63x30 1800 LG	10
6	PFIX0900029	TIMBER TEKS	20
7	PFIX0900008	COACH BOLT, 5/16" x 2" LG c/w NUT	20
8	PFIX0900107	3/8" COUNTERSUNK HEAD BOLT c/w NUT	2
9	PFIX0900020	COUNTERSUNK HEAD BOLT 1/4 X 1" C/W NUT	2

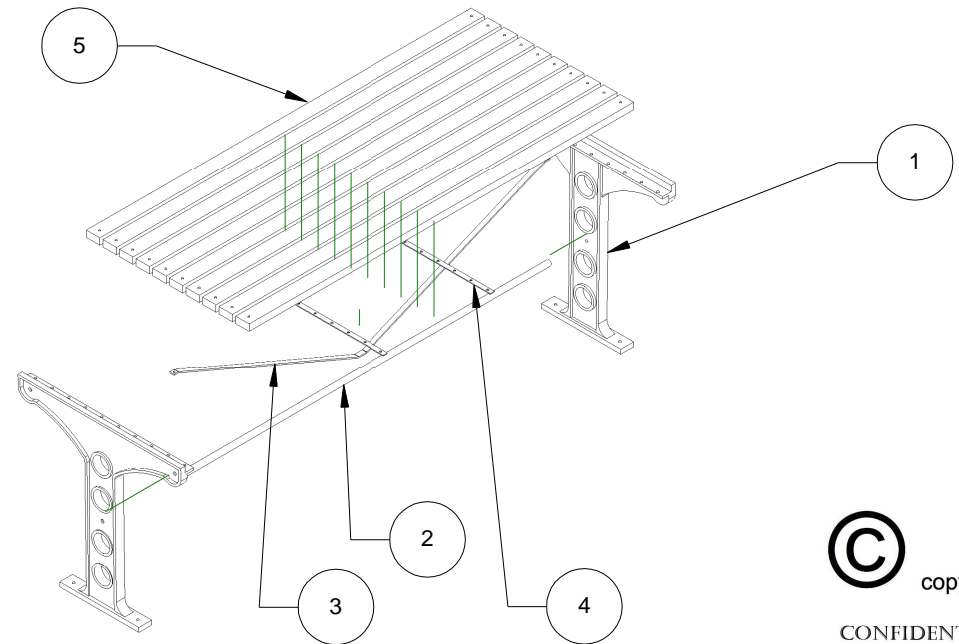

© copyright
CONFIDENTIAL

REVISION	#	DESCRIPTION	BY	DATE	DRAWN	DRAWN DATE	CHECKED	CHECKED DATE	SCALE	A4
	1	ORIGINAL DRAWING	DN	8.10.10	R.CRIGTON	6.12.13			N/A	
	2	FULL PRODUCT REVIEW	RBC	6.12.13			FIESTA TABLE BOM, PROCEDURE & ASSEMBLY			
	3									
	4						FFSA003012			
	5									

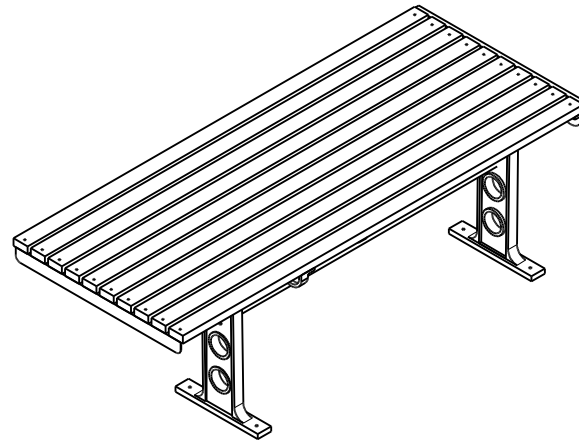
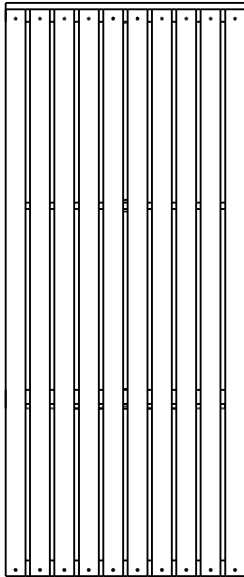

SPECIFICATION:

MATERIALS:

Main construction - Cast Aluminium
Slats - Harwood Timber
Pipes & Brace - Mild Steel
Strap - Stainless Steel

DIMENSIONS:

mm unless otherwise stated

FINISH:

Castings - Milled or Powder coat (optional)
Timbers - Oil Based
Pipes & Brace - Powder coat

GROUND FIXINGS:

Bolt down

WHEELCHAIR ACCESS:

One end



Quality
ISO 9001
SAI GLOBAL

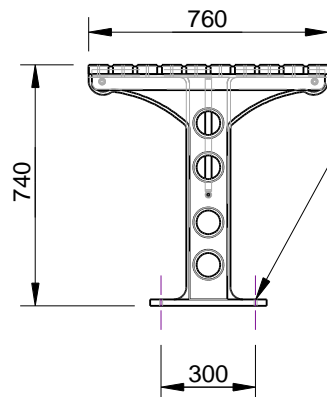

BOLT DOWN DETAIL

Ø10 THRU
4 LOCATIONS

WHEEL
CHAIR
ACCESS

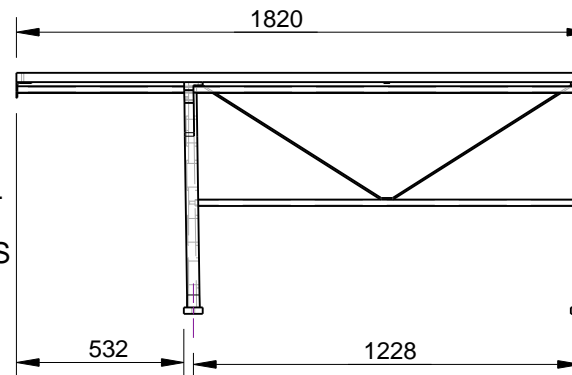

CONFIDENTIAL

REVISION	#	DESCRIPTION	BY	DATE	DRAWN	DRAWN DATE	CHECKED	CHECKED DATE	SCALE	A4
	1	ORIGINAL DRAWING	DN	19.10.10	R.CRIGTON	8.12.13			N/A	
	2	FULL PRODUCT REVIEW	RBC	8.12.13						
	3									
	4									
	5									
						FIESTA TABLE WCA - ONE END SPEC.				
						FFSA003013		REV. 2	SHEET 1 OF 4	



REVISION	#	DESCRIPTION	BY	DATE	DRAWN	DRAWN DATE	CHECKED	CHECKED DATE	SCALE	A4
	1	ORIGINAL DRAWING	DN	19.10.10	R.CRIGTON	8.12.13			N/A	
	2	FULL PRODUCT REVIEW	RBC	8.12.13	 	PROMENADE TABLE - BOLT DOWN SPEC.				
	3					FFSA003016 <div>REV. 2</div> <div>SHEET 1 OF 4</div>				
	4									
	5									

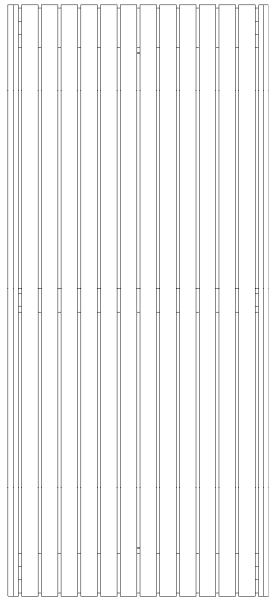

SPECIFICATION:

MATERIAL:

Bench Ends & Centre Support - Recycled Cast Aluminium
 Legs - Stainless Steel
 Timber Slats - Hardwood Timber
 Fixings - Stainless Steel

DIMENSIONS:

mm unless otherwise stated

FINISH:

Castings - Mill Finish
 Timber - Oil Based

GROUND FIXING:

In ground

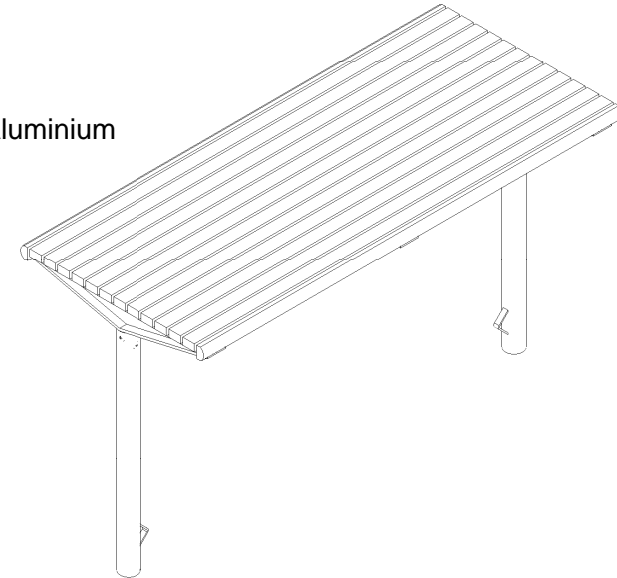

Quality
 ISO 9001
 SAI GLOBAL

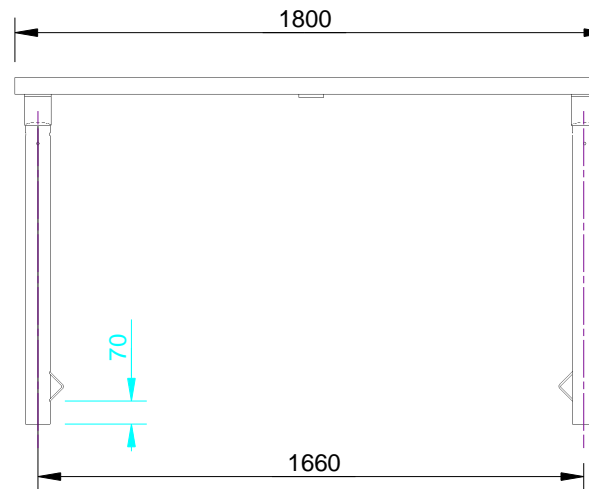
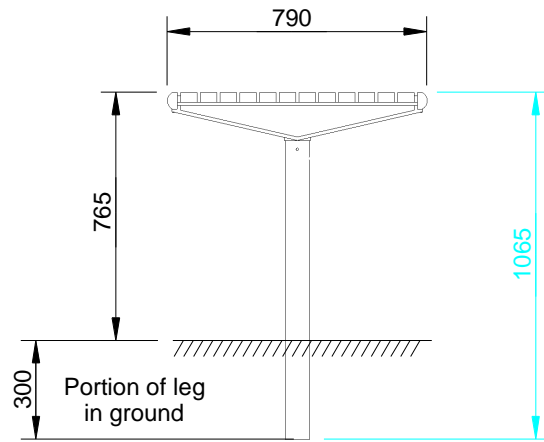

© copyright

CONFIDENTIAL

REVISION	#	DESCRIPTION	BY	DATE	DRAWN	DRAWN DATE	CHECKED	CHECKED DATE	SCALE	A4
	1	ORIGINAL DRAWING	DN	12.8.10	R.CRIGTON	8.12.13			N/A	
	2	FULL PRODUCT REVIEW	RBC	8.12.13						
	3									
	4									
	5									
						PROMENADE TABLE - IN GROUND SPEC.				
						FFSA003017		REV. 2	SHEET 1 OF 4	



Quality
ISO 9001
SAI GLOBAL

SPECIFICATION:

MATERIAL:

Table Ends & Centre Support - Recycled Cast Aluminium
Legs - Stainless Steel
Timber Slats - Hardwood Timber
Fixings - Stainless Steel

DIMENSIONS:

mm unless otherwise stated

FINISH:

Castings - Mill Finish
Timber - Oil Based

GROUND FIXING:

Bolt down

WHEELCHAIR ACCESS:

One end

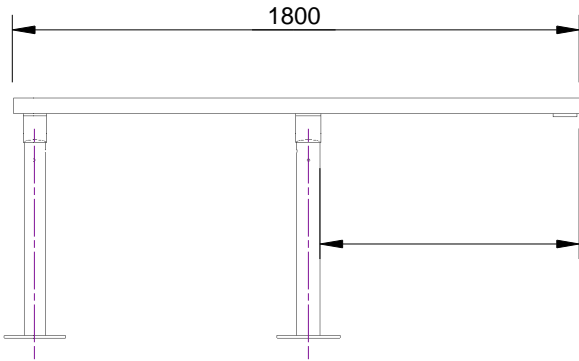
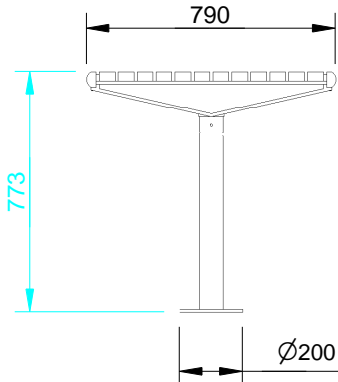
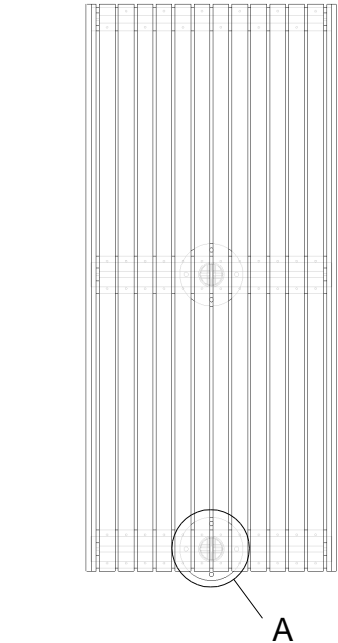
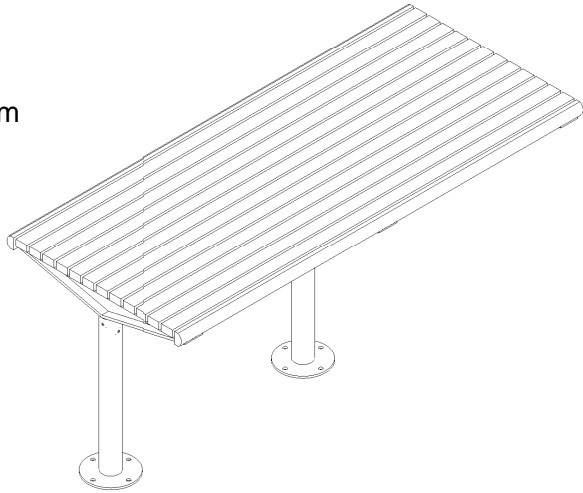

WHEELCHAIR ACCESS
DIM. A VARIABLE
WITHIN AUSTRALIAN
STANDARD

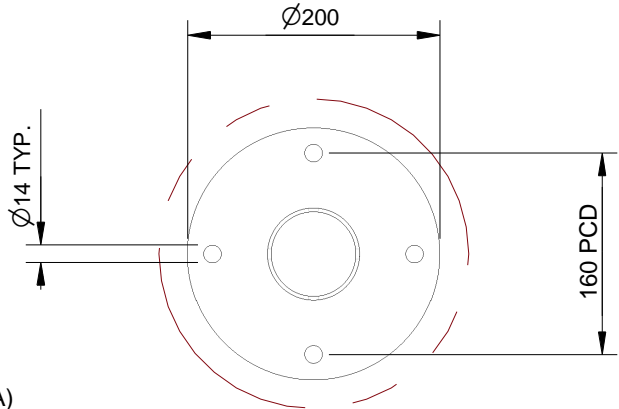

Detail A
BOLT DOWN DETAIL
TIMBERS & CASTING
HIDDEN FOR CLARRITY

© copyright
CONFIDENTIAL

REVISION	#	DESCRIPTION	BY	DATE	DRAWN	DRAWN DATE	CHECKED	CHECKED DATE	SCALE	A4
	1	ORIGINAL DRAWING	DN	19.10.10	R.CRIGTON	9.12.13			N/A	
	2	FULL PRODUCT REVIEW	RBC	9.12.13			PROMENADE TABLE WCA - BOLT DOWN SPEC.			
	3						FFSA003018	REV. 2	SHEET 1 OF 4	
	4									
	5									

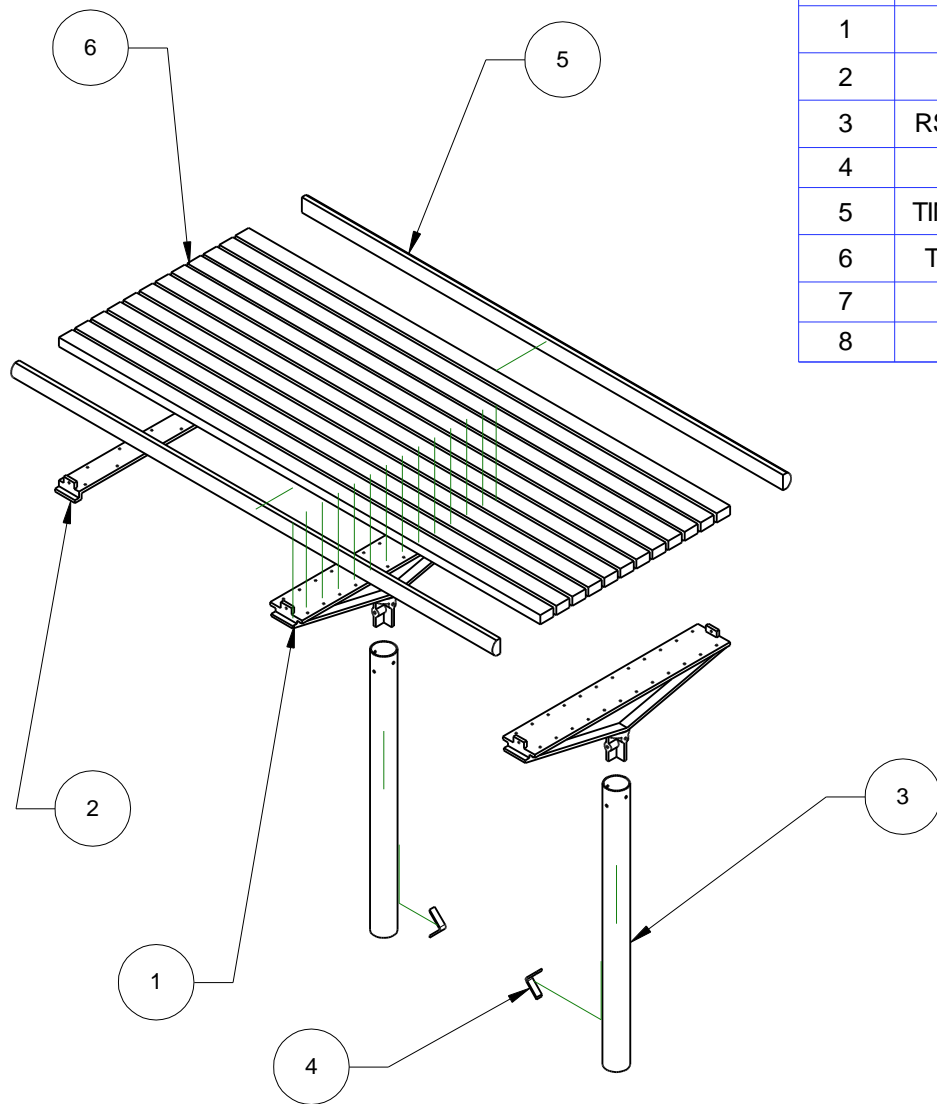

ITEM	PART NUMBER	DESCRIPTION	QTY
1	UNKNOWN	PROMENADE TABLE END CASTING	2
2	UNKNOWN	PROMENADE TABLE CENTRE CASTING	1
3	RSSPI65NB-304SC10	PIPE 65 NB SCH 10 910 LG 304SS	2
4	RSSFB30X5	IN GROUND LUG, FLAT 30x5 120 LG	2
5	TIMBOW50X30BN50E	BULLNOSE TIMBER SLAT 50x30 1800LG	2
6	TIMCHA50X30X1800	TIMBER SLAT 50x30 1800LG	12
7	RSSRB8-304	DOWEL 8MM S/S ROD @ 32MM	8
8	PFIX0900060	BUTTON SECURITY SCREW T25 STAINLESS	66



© copyright
CONFIDENTIAL

REVISION	#	DESCRIPTION	BY	DATE	DRAWN	DRAWN DATE	CHECKED	CHECKED DATE	SCALE	A4
	1	ORIGINAL DRAWING	DN	12.8.10	R.CRIGTON	9.12.13			N/A	
	2	FULL PRODUCT REVIEW	RBC	9.12.13						
	3									
	4									
	5									
						PROMENADE TABLE WCA - IN GROUND BOM				
						FFSA003019			REV. 2	SHEET 2 OF 4

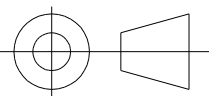



Quality
ISO 9001
SAI GLOBAL

SPECIFICATION:

MATERIALS:

Main construction - Cast aluminium
Slats - Hardwood timber
Floor mount brackets - Galvanised mild steel
Fixings - Stainless steel
Strap - Stainless steel

DIMENSIONS:

mm unless otherwise stated

FINISH:

Castings - Natural
Timber - Oil Based

NOTE:

This product is also available with wheel chair access, one or both ends.



CONFIDENTIAL

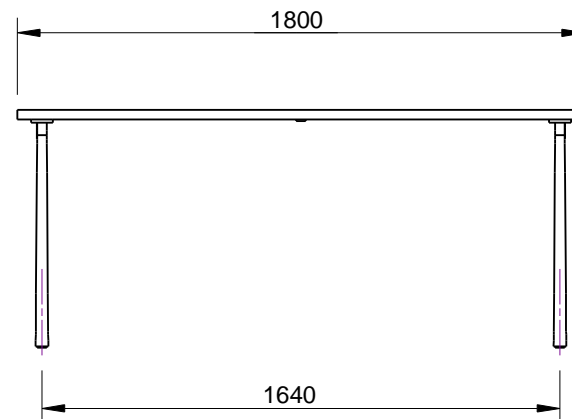
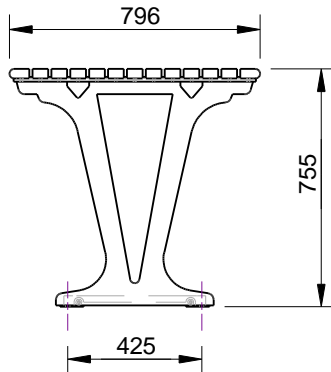
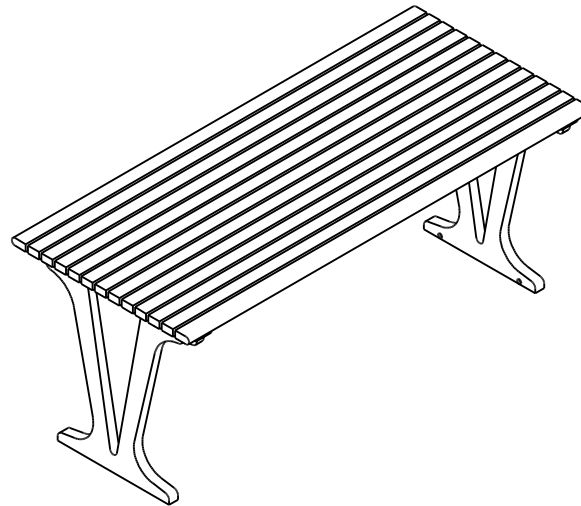
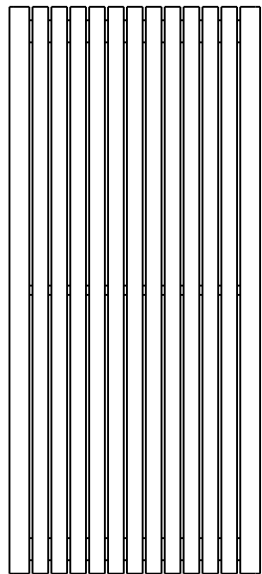

REVISION	#	DESCRIPTION	BY	DATE	DRAWN	DRAWN DATE	CHECKED	CHECKED DATE	SCALE	A4
	1	ORIGINAL DRAWING	RBC	7.11.13	R.CRIGTON	7.11.13			N/A	
	2						FULCRUM TABLE SPEC.			
	3									
	4						FFSA003020	REV. 1	SHEET 1 OF 5	
	5									

ITEM	PART NUMBER	DESCRIPTION	QTY	COMMENT
1	TIMBOW63X30BN30E	BULLNOSE TIMBER SLAT 63x30 1800LG	2	
2		FULCRUM TABLE END CASTING	1	
3	RSSF30X5	FLAT 30x5 750 LG 304SS (FULCRUM TABLE CENTRE STRAP)	1	
4	TIMCHA50X30X1800	TIMBER SLAT 50x30 1800LG	11	
5	PCOM0900590	FLOOR MOUNT BRACKET (TABLE)	2	
6		FULCRUM TABLE END CASTING – WCA	1	
7		FULCRUM TABLE WCA OUT RIGGER	2	
8		FULCRUM TABLE WCA END SUPPORT	1	
9	PFIX0900060	BUTTON SECURITY SCREW T25 S/S	58	
10		COUNTER SUNK BOLT M10 x 20 LG	4	
11	PFIX0900161	SS 3/8" x 2" C.S. BOLT	4	
12	PFIX0900139	C.S. BOLT 1/4" x 1 1/4" 304 SS	4	

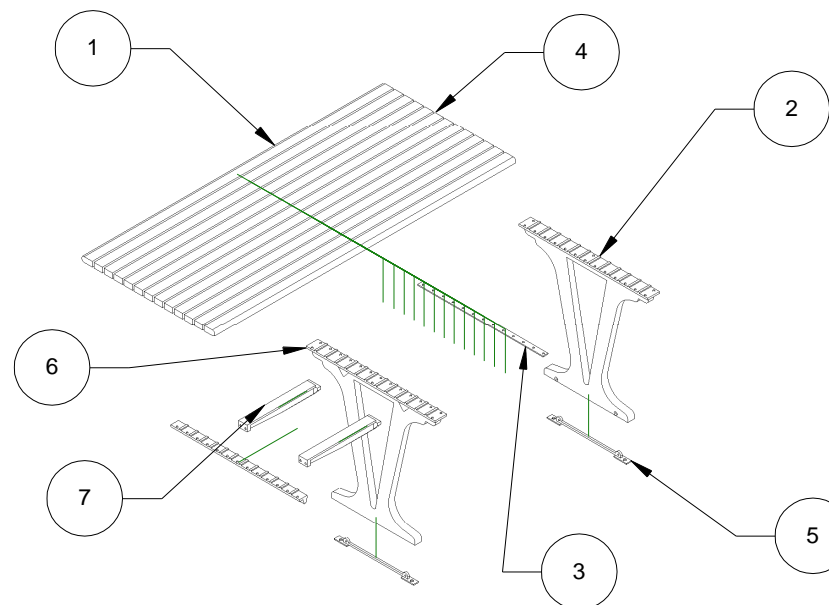

Quality
ISO 9001
SAI GLOBAL

© copyright
CONFIDENTIAL

REVISION	#	DESCRIPTION	BY	DATE	DRAWN	DRAWN DATE	CHECKED	CHECKED DATE	SCALE	A4
	1	ORIGINAL DRAWING	DN	19.10.10	R.CRIGTON	8.11.13			N/A	
	2	FULL PRODUCT REVIEW	RBC	8.11.13						
	3									
	4									
	5									
							FULCRUM TABLE WCA - ONE END BOM			
							FFSA003021	REV. 2	SHEET 2 OF 5	



Both Ends

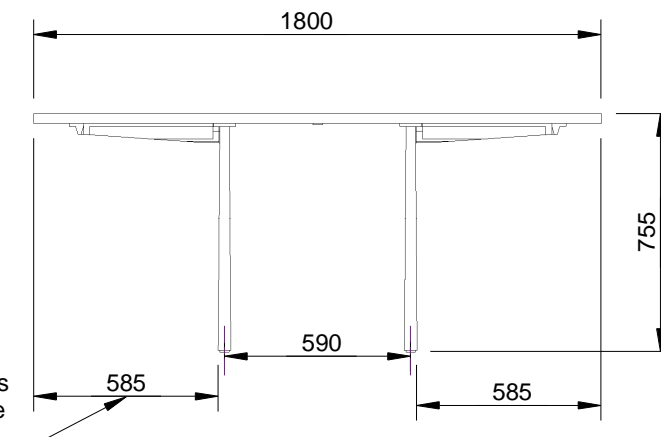

Wheel chair access
Dimension variable
within Australian
standards



CONFIDENTIAL

REVISION	#	DESCRIPTION	BY	DATE	DRAWN	DRAWN DATE	CHECKED	CHECKED DATE	SCALE	A4
	1	ORIGINAL DRAWING	RBC	8.11.13	R.CRIGTON	8.11.13			N/A	
	2						FULCRUM TABLE WCA - BOTH ENDS SPEC.			
	3									
	4							FFSA003022	REV. 1	SHEET 1 OF 5
	5									

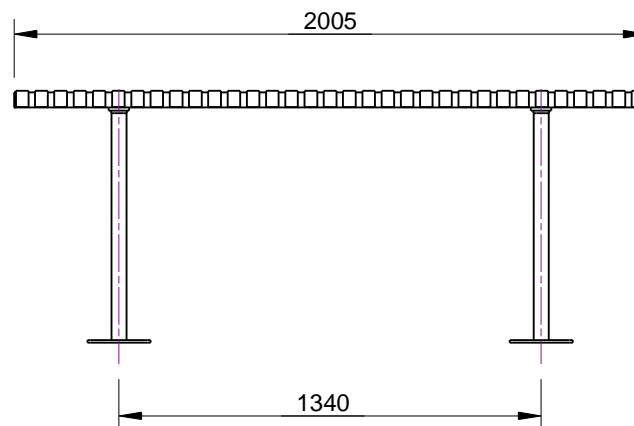
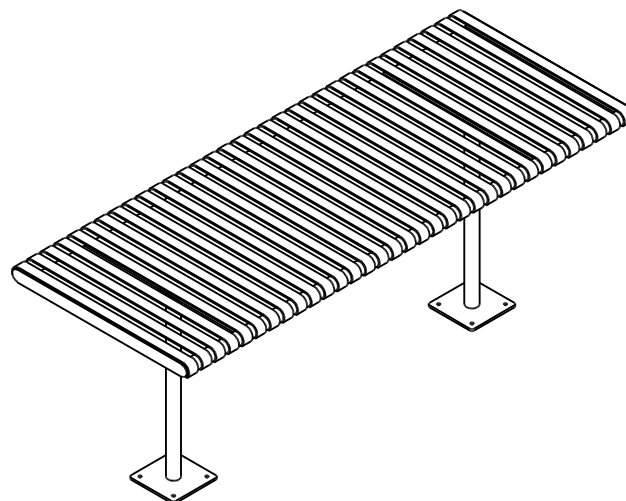
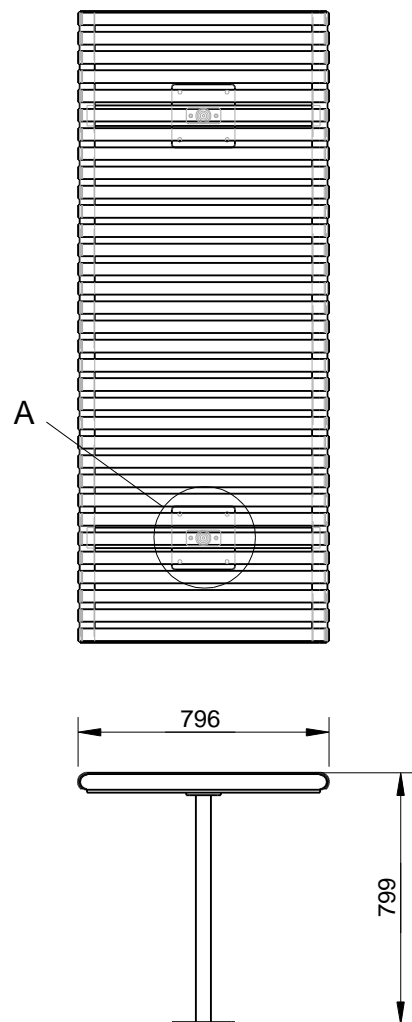

SPECIFICATION:

Material:
Frame & Slats: Mild Steel Construction

Dimensions:
All in mm unless otherwise stated

Finish:
Steel - Galvanised and optional Powder Coat

Ground Fixings:
Bolt Down



Quality
ISO 9001
SAI GLOBAL

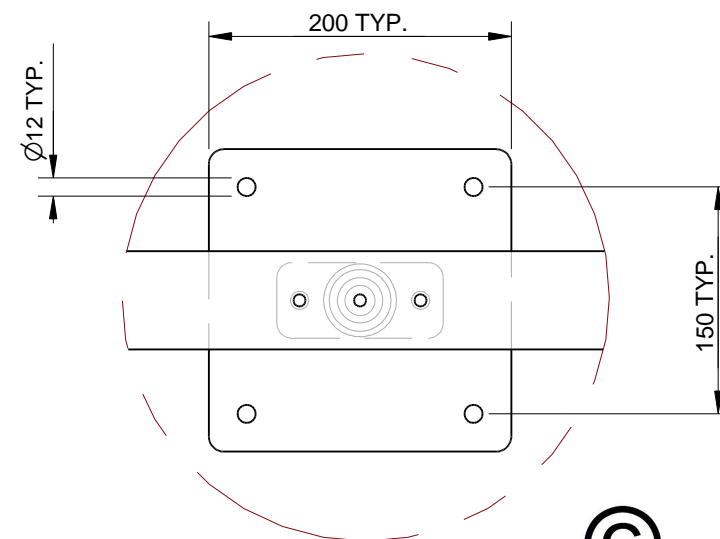

DETAIL A
SLATS REMOVED
FOR CLARITY

© copyright
CONFIDENTIAL

REVISION	#	DESCRIPTION	BY	DATE	DRAWN	DRAWN DATE	CHECKED	CHECKED DATE	SCALE	A4
	1	ORIGINAL DRAWING	DN	20.7.10	R.CRIGTON	12.12.13			N/A	
	2	FULL PRODUCT REVIEW	RBC	12.12.13						
	3									
	4									
	5									
							STEEL SLATTED TABLE - BOLT DOWN SPEC.			
							FFSB003001	REV. 2	SHEET 1 OF 2	

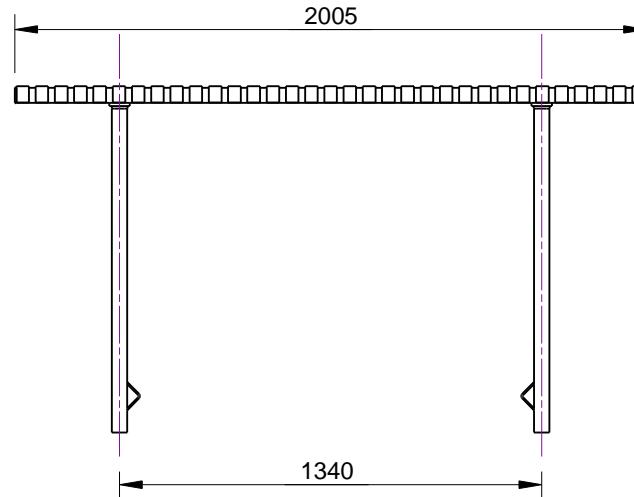
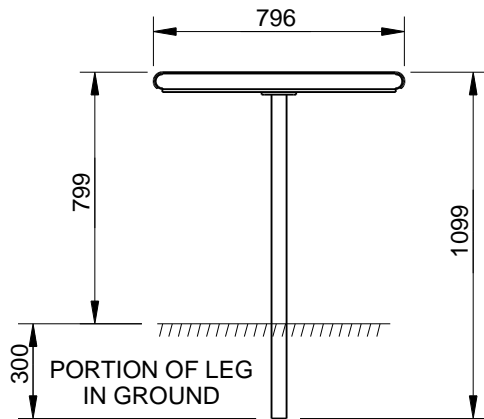
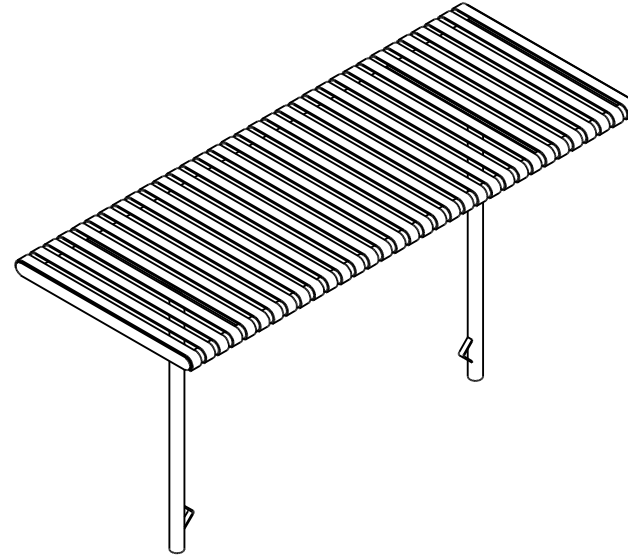
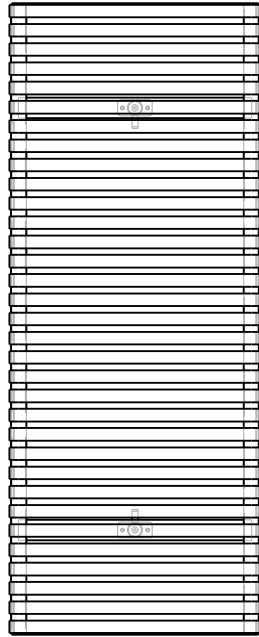

SPECIFICATION:

Material:
Frame & Slats: Mild Steel Construction

Dimensions:
All in mm unless otherwise stated

Finish:
Steel - Galvanised and optional Powder Coat

Ground Fixings:
In ground



Quality
ISO 9001
SAI GLOBAL



CONFIDENTIAL

REVISION	#	DESCRIPTION	BY	DATE	DRAWN	DRAWN DATE	CHECKED	CHECKED DATE	SCALE	A4
	1	ORIGINAL DRAWING	DN	20.7.10	R.CRIGTON	12.12.13			N/A	
	2	FULL PRODUCT REVIEW	RBC	12.12.13						
	3									
	4									
	5									
							STEEL SLATTED TABLE - IN GROUND SPEC.			
							FFSB003002		REV. 2	SHEET 1 OF 2

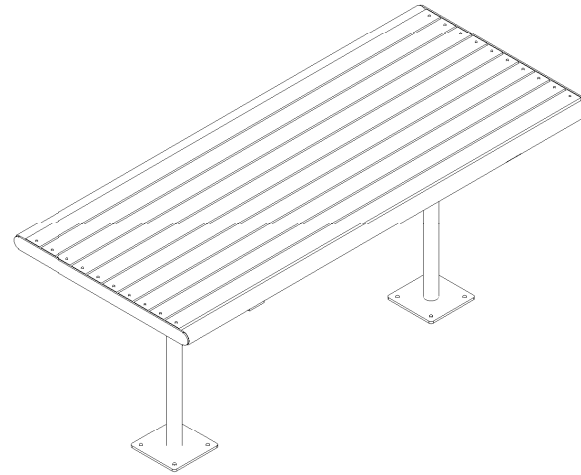
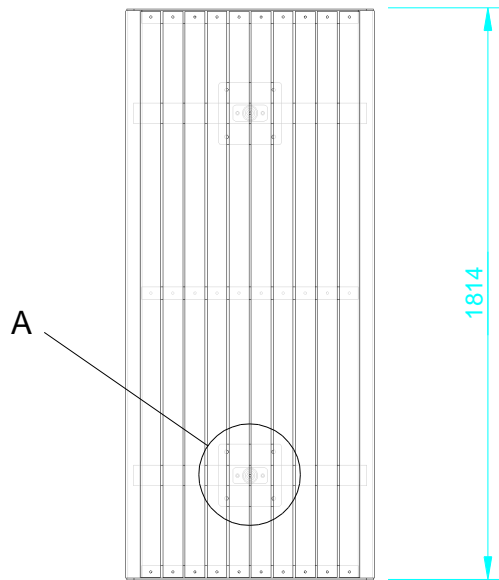

SPECIFICATION:

Material:

Mild steel unless otherwise stated
Slats: Hardwood Timber 63x30mm

Dimensions:

All in mm unless otherwise stated

Finish:

Steel - Galvanised and optional Powder Coat
Timber - Oil Based

Ground Fixings:

Bolt down



Quality

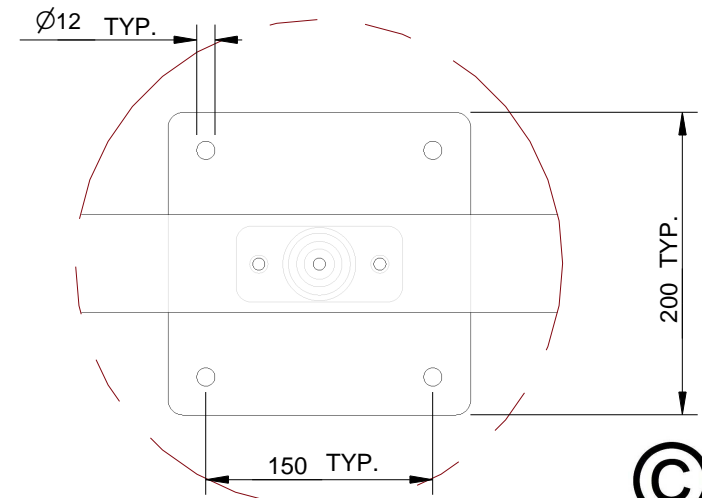
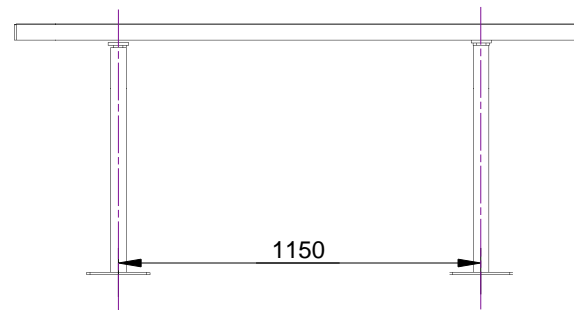
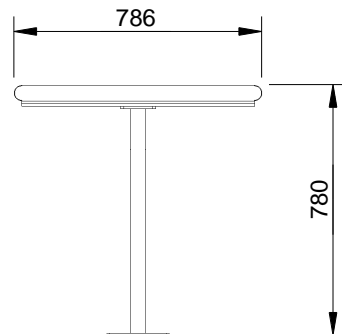

ISO 9001

SAI GLOBAL



copyright

CONFIDENTIAL

REVISION	#	DESCRIPTION	BY	DATE	DRAWN	DRAWN DATE	CHECKED	CHECKED DATE	SCALE	A4
	1	ORIGINAL DRAWING	DN	18.8.10	R.CRIGTON	4.11.13			N/A	
	2	FULL PRODUCT REVIEW	RBC	4.11.13			WOODGROVE TABLE - BOLT DOWN SPEC.			
	3									
	4									
	5									
									FFSB003004	

SPECIFICATION:

Material:

Mild steel unless otherwise stated
Slats - Hardwood timber 63x30mm

Dimensions:

All in mm unless otherwise stated

Finish:

Steel - Galvanised and optional Powder Coat
Timber - Oil Based

Weight:

50kg Approx.

Ground Fixings:

In Ground



Quality

ISO 9001

SAI GLOBAL

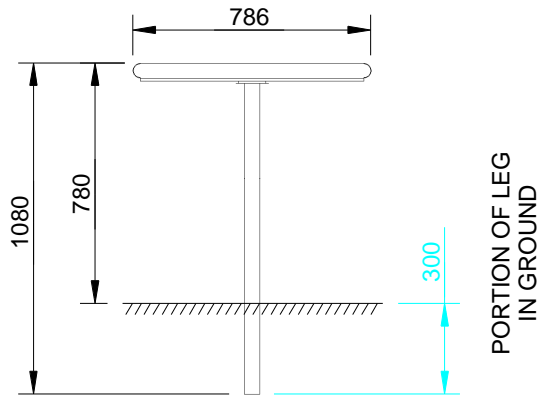
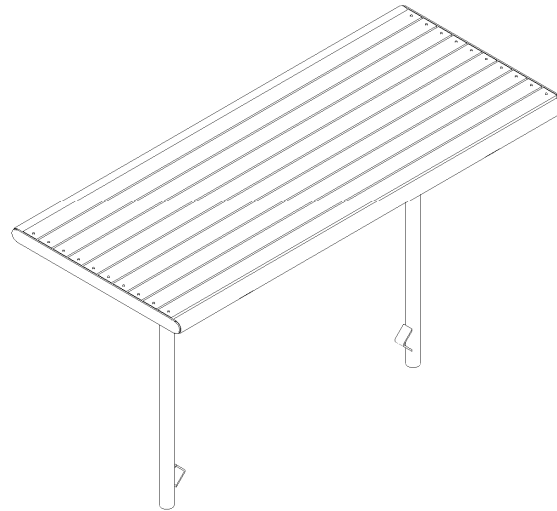
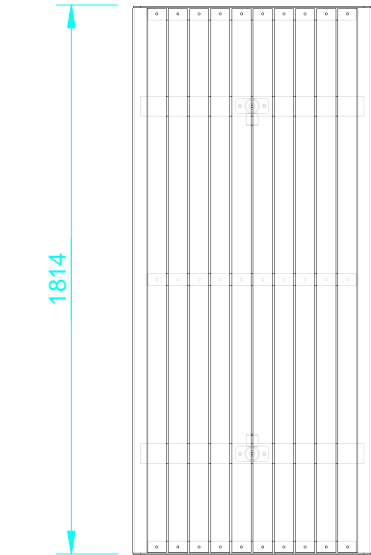

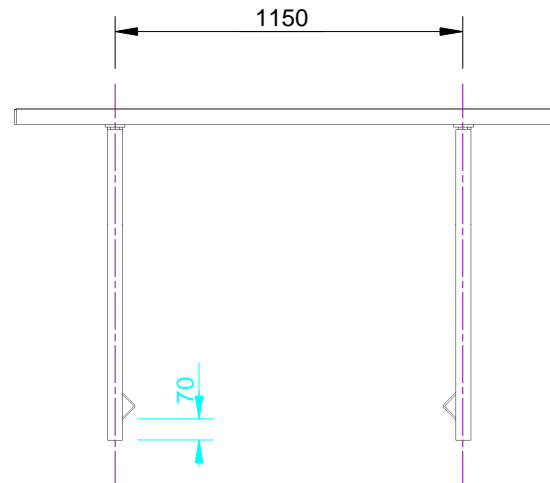

PORTION OF LEG
IN GROUND

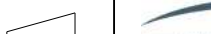

© copyright

CONFIDENTIAL

REVISION	#	DESCRIPTION	BY	DATE	DRAWN	DRAWN DATE	CHECKED	CHECKED DATE	SCALE	A4		
	1	ORIGINAL DRAWING	DN	19.8.10	R.CRIGTON	4.11.13			N/A			
	2	FULL PRODUCT REVIEW	RBC	4.11.13			WOODGROVE TABLE - IN GROUND SPEC.					
	3											
	4						FFSB003005				REV. 2	SHEET 1 OF 3
	5											

ITEM	PART NUMBER	DESCRIPTION	QTY
1	PCOM0900653	511221 CIVIC TABLE CENTRE STRAP	1
2	PCOM0900653	511931 CIVIC TABLE FOLDED END	2
3	TIMCHA63X30X1800	TIMBER SLAT 63x30 1800 LG	10
4	PFIX0900008	COACH BOLT, 5/16" x 2" LG c/w NUT	20
5	PFIX0900029	TIMBER TEKS	10

ASSEMBLY PROCEDURE

TIMBERS:

- Using correct jig, drill timber, through 9/32.
- Ensure you have correct components
- Remove all sharps and debur all laser edges.
- Weld off all designated positions
- Clean all welds back to suit profiles and remove all spatter

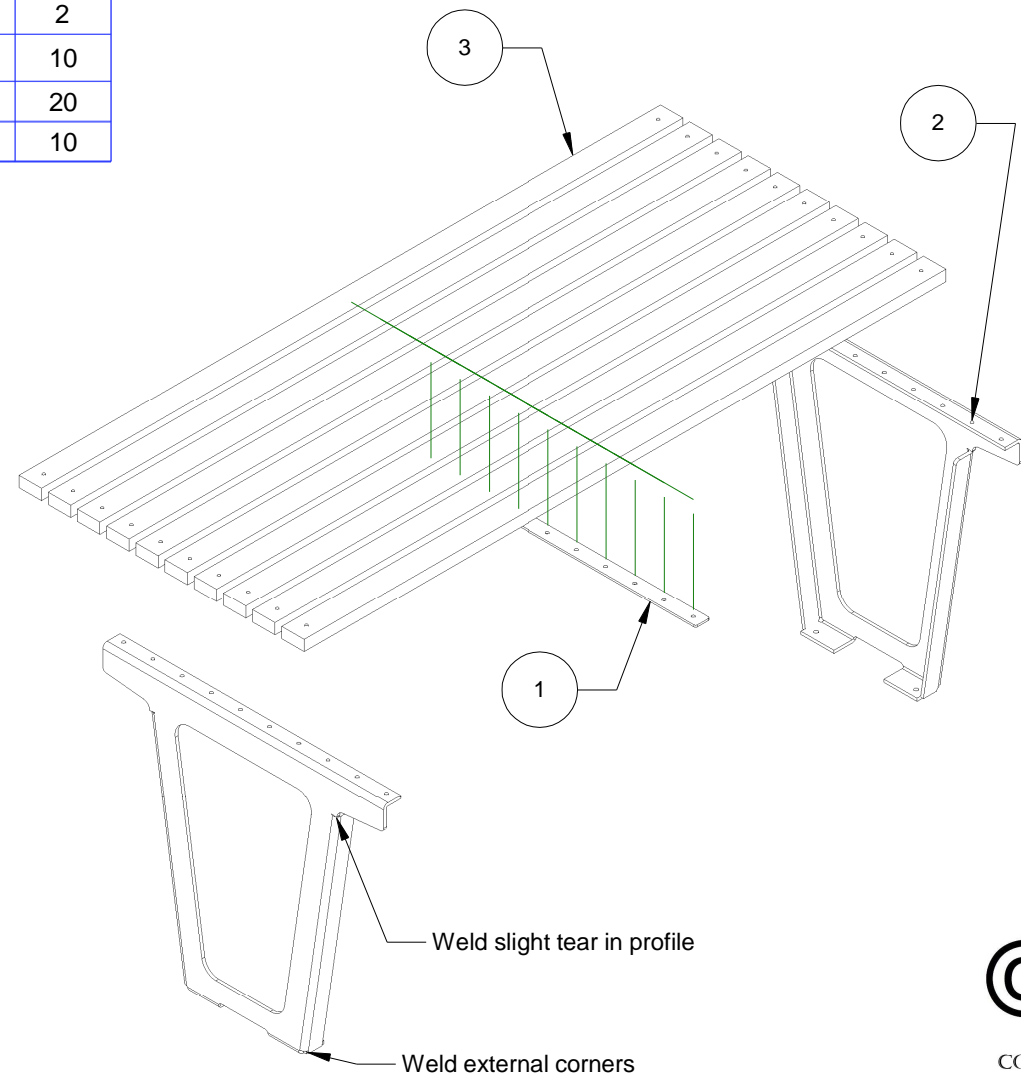

Quality
ISO 9001
SAI GLOBAL



CONFIDENTIAL

REVISION	#	DESCRIPTION	BY	DATE	DRAWN	DRAWN DATE	CHECKED	CHECKED DATE	SCALE	A4			
	1	ORIGINAL DRAWING	DN	11.6.10	R.CRIGTON	17.3.14			N/A				
	2	FULL PRODUCT REVIEW	RBC	17.3.14			CIVIC TABLE BOM & ASSEMBLY						
	3												
	4						FFSB003017				REV. 2	SHEET 2 OF 2	
	5												

ITEM	PART NUMBER	DESCRIPTION	QTY
1	PCOM0900653	511221 CIVIC TABLE CENTRE STRAP	1
2	PCOM0900653	511931 CIVIC TABLE FOLDED END	2
3	TIMCHA63X30X1800	TIMBER SLAT 63x30 1800 LG	10
4	RSAN30X30X5	ANGLE 30x30x5 504 LG	2
5	RSAN40X40X5	ANGLE 40x40x5 790 LG MITRED	1
6	PFIX0900008	COACH BOLT, 5/16" x 2" LG c/w NUT	20
7	PFIX0900029	TIMBER TEKS	20



Quality
ISO 9001
SAI GLOBAL

ASSEMBLY PROCEDURE

TIMBERS:

- Using correct jig, drill timber, through 9/32.
- Ensure you have correct components
- Remove all sharps and debur all laser edges.
- Weld off all designated positions
- Clean all welds back to suit profiles and remove all spatter

Civic Table W.C.A. Outriggers

- Take 40x40 angle @ 790 and using correct jig drill to 5/16" ensuring you drill angle face that is not metered
- Place all components into W.C.A. jig including table profile and tack together
- Remove from jig and weld off clean and remove spatter.

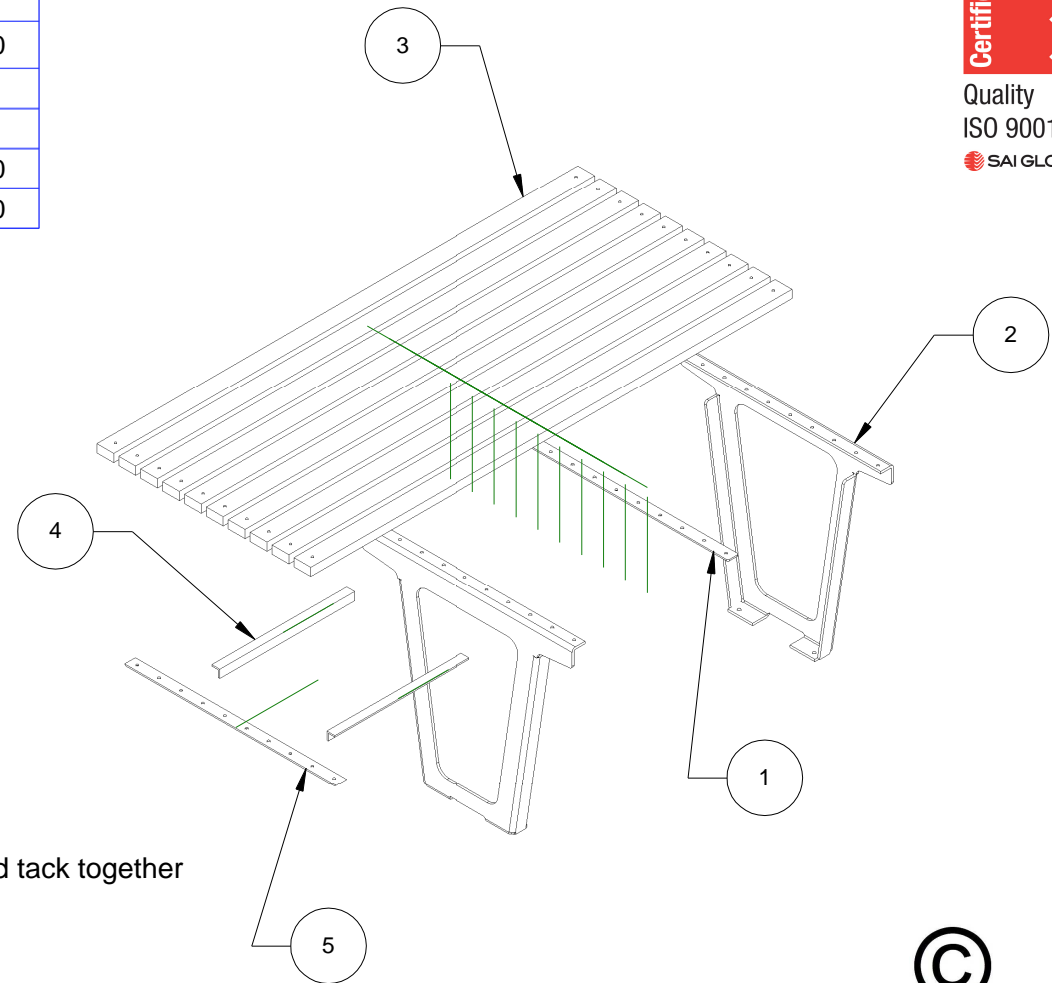

© copyright

CONFIDENTIAL

REVISION	#	DESCRIPTION	BY	DATE	DRAWN	DRAWN DATE	CHECKED	CHECKED DATE	SCALE	A4	
	1	ORIGINAL DRAWING	DN	18.8.10	R.CRIGTON	17.3.14			N/A		
	2	FULL PRODUCT REVIEW	RBC	17.3.14			CIVIC TABLE WCA - ONE END BOM & ASSEMBLY				
	3										
	4						FFSB003018			REV. 2	SHEET 2 OF 2
	5										



Quality
ISO 9001
SAI GLOBAL

SPECIFICATION:

MATERIALS:
Main construction - Steel
Slats - Harwood Timber

DIMENSIONS:
mm unless otherwise stated

FINISH:
Galvanised or Powder coat (optional)
Timbers - Oil Based

GROUND FIXINGS:
Bolt down

WHEEL CHAIR ACCESS:
Both ends

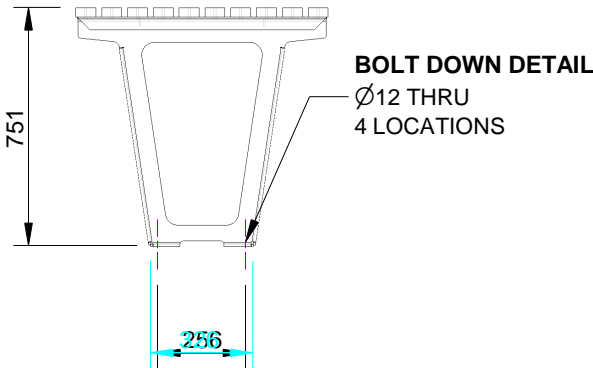
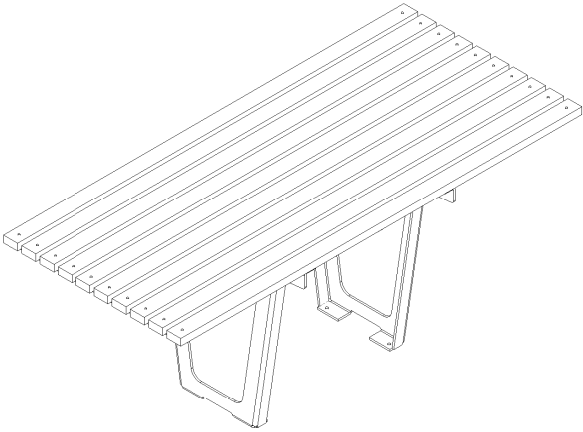
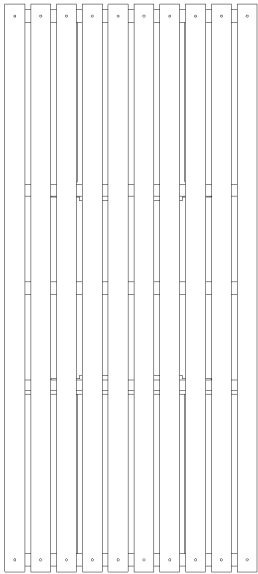

WHEEL CHAIR ACCESS
Dimension A is
variable within
Australian standards.

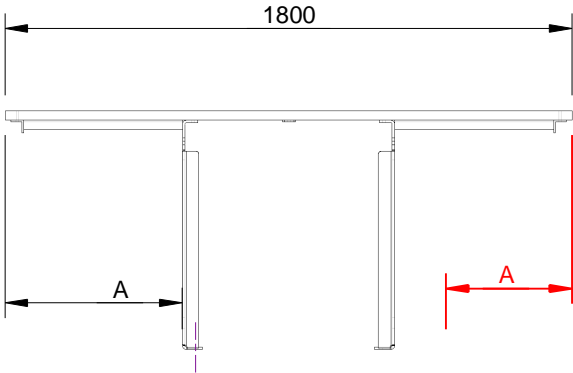

© copyright

CONFIDENTIAL

REVISION	#	DESCRIPTION	BY	DATE	DRAWN	DRAWN DATE	CHECKED	CHECKED DATE	SCALE	A4
	1	ORIGINAL DRAWING	DN	18.8.10	R.CRIGTON	17.3.14			N/A	
	2	FULL PRODUCT REVIEW	RBC	17.3.14						
	3									
	4									
	5									
						CIVIC TABLE WCA - BOTH ENDS SPEC.				
							FFSB003019	REV. 2	SHEET 1 OF 2	

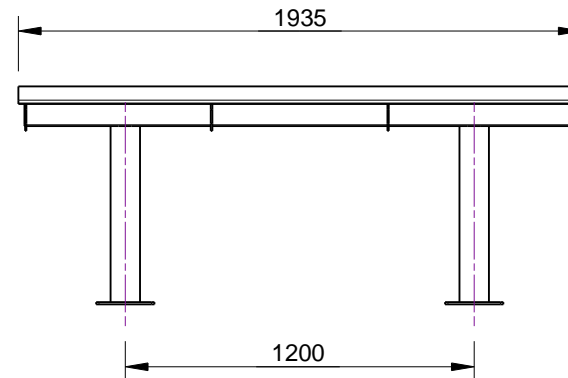
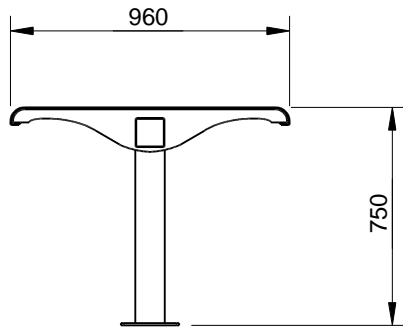
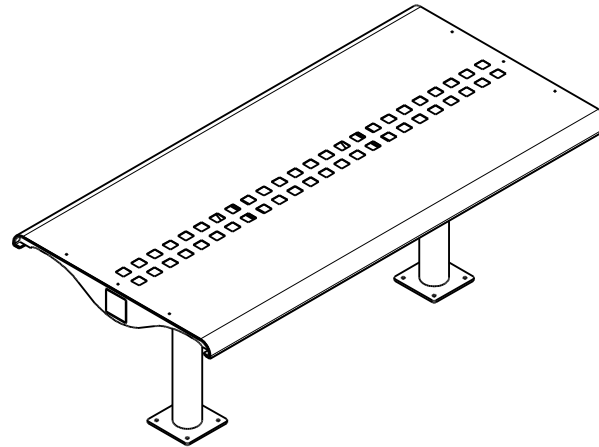
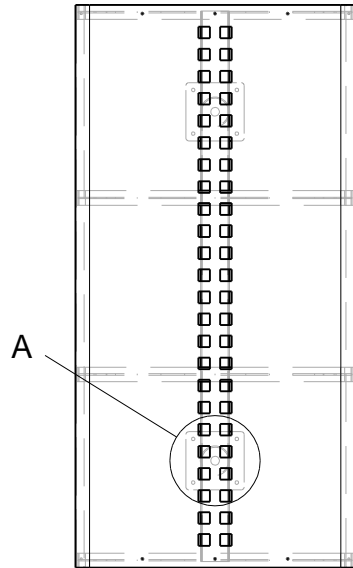

SPECIFICATION:

MATERIAL:

Main construction - Mild steel
Table top - Stainless steel
Fixings - Stainless steel

DIMENSIONS:

mm unless otherwise stated

FINISH:

Table top - No.4 Polished
Body - Galvanised with optional powder coat

GROUND ATTACHEMENT:

Bolt down



Quality
ISO 9001
SAI GLOBAL

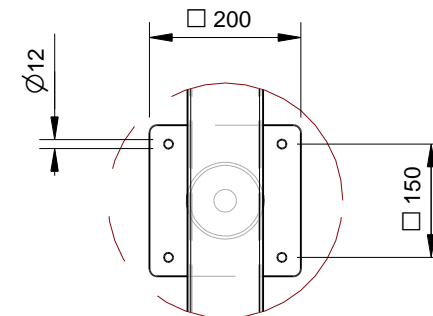

Detail A
BOLT DOWN DETAIL
SLATS REMOVED
FOR CLARITY

© copyright

CONFIDENTIAL

REVISION	#	DESCRIPTION	BY	DATE	DRAWN	DRAWN DATE	CHECKED	CHECKED DATE	SCALE	A4
	1	ORIGINAL DRAWING	RBC	31.3.14	R.CRIGTON	31.3.14			N/A	
	2									
	3									
	4									
	5									
						PARKLANE TABLE - BOLT DOWN SPEC.				
						FFSB003020		REV. 1	SHEET 1 OF 3	

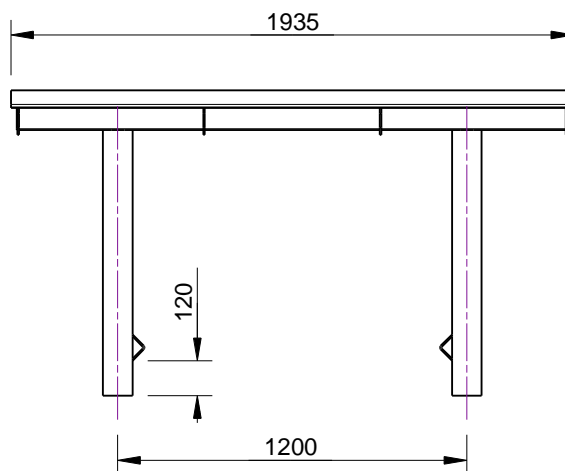
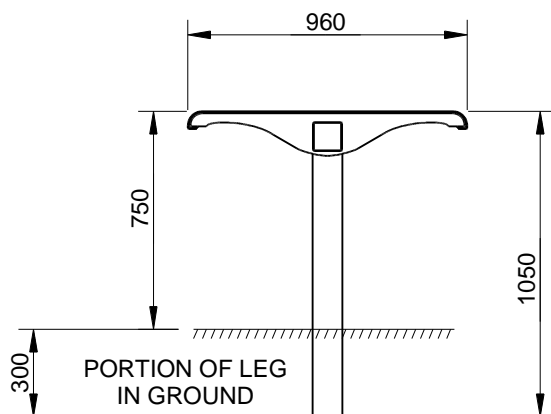
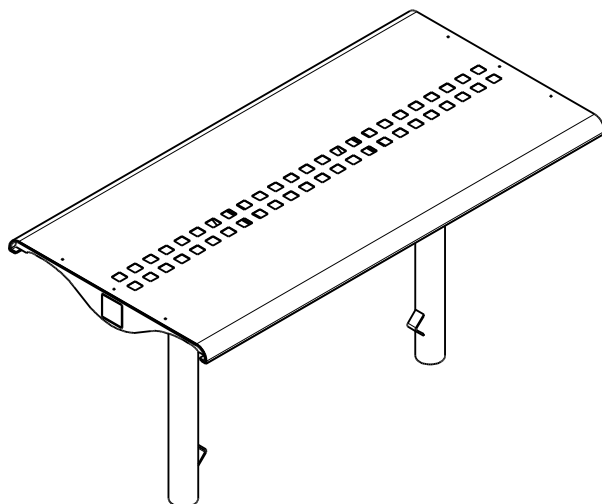

CONFIDENTIAL

REVISION	#	DESCRIPTION	BY	DATE	DRAWN	DRAWN DATE	CHECKED	CHECKED DATE	SCALE	A4
	1	ORIGINAL DRAWING	RBC	1.4.14	R.CRIGTON	1.4.14			N/A	
	2						PARKLANE TABLE - IN GROUND SPEC.			
	3									
	4									
	5									
							FFSB003021		REV. 1	SHEET 1 OF 3

SIGNIFICANT CHARACTERISTICS & DETAIL:

- 1.The drawing shows positioning and orientation of gal holes
- 2.Positioning of pipe in relation to end profile.
- 3.Positioning of slat supports.
- 4.Positioning of cleat. (Base plates removed)

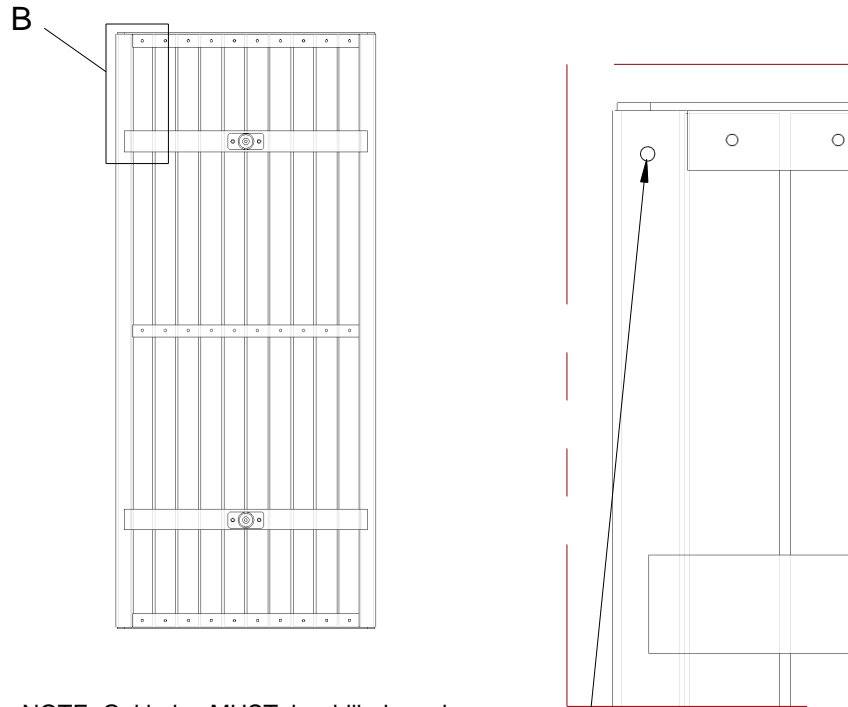

NOTE: Gal holes MUST be drilled on pipe seam for alignment & to avoid the seam being visible after manufacture (it is hidden underneath)

Detail B

ASSEMBLY

1. Inspect table profile for any imperfections
2. Place table profile onto work bench
3. Place all timbers into table and fasten lightly, once all coach bolts are in place tighten all
4. Turn table upside down and fasten centre brace using timber tek screws
5. Place table to side for Final Inspection and packaging.

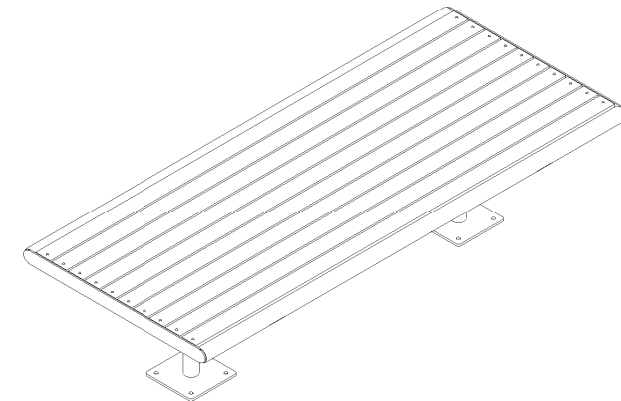

Quality
ISO 9001
SAI GLOBAL

© copyright

CONFIDENTIAL

REVISION	#	DESCRIPTION	BY	DATE	DRAWN	DRAWN DATE	CHECKED	CHECKED DATE	SCALE	A4
	1	ORIGINAL DRAWING	RBC	13.11.13	R.CRIGTON	13.11.13			N/A	
	2									
	3									
	4									
	5									
							WOODGROVE RECTANGULAR PLATFORM - BOLT DOWN - ASSEMBLY			
							FFSB003022	REV. 1	SHEET 3 OF 3	

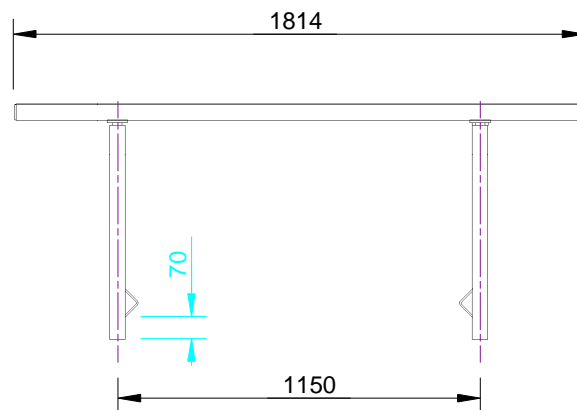
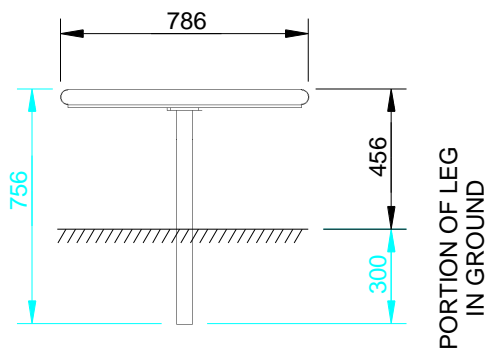
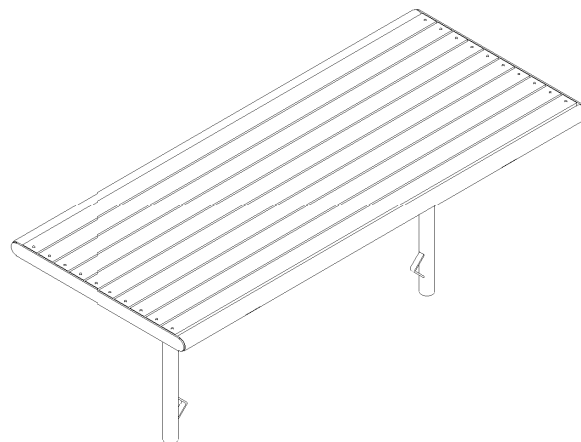
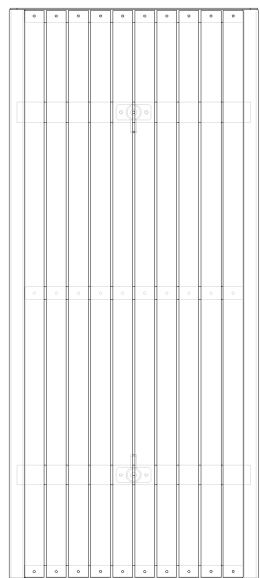

SPECIFICATION:

MATERIAL:

Mild steel unless otherwise stated
Slats - Hardwood timber 63x30mm

DIMENSIONS:

All in mm unless otherwise stated

FINISH:

Steel - Galvanised and optional Powder Coat
Timber - Oil Based

GROUND FIXINGS:

In Ground



Quality
ISO 9001



CONFIDENTIAL

REVISION	#	DESCRIPTION	BY	DATE	DRAWN	DRAWN DATE	CHECKED	CHECKED DATE	SCALE	A4
	1	ORIGINAL DRAWING	RBC	13.11.13	R.CRIGTON	13.11.13			N/A	
	2									
	3									
	4									
	5									
					 	WOODGROVE RECTANGULAR PLATFORM - IN GROUND - SPEC.				
							FFSB003023	REV. 1	SHEET 1 OF 3	

SIGNIFICANT CHARACTERISTICS & DETAIL:

- 1.The drawing shows positioning and orientation of gal holes
- 2.Positioning of pipe in relation to end profile.
- 3.Positioning of slat supports.
- 4.Positioning of cleat, (base plate hidden)

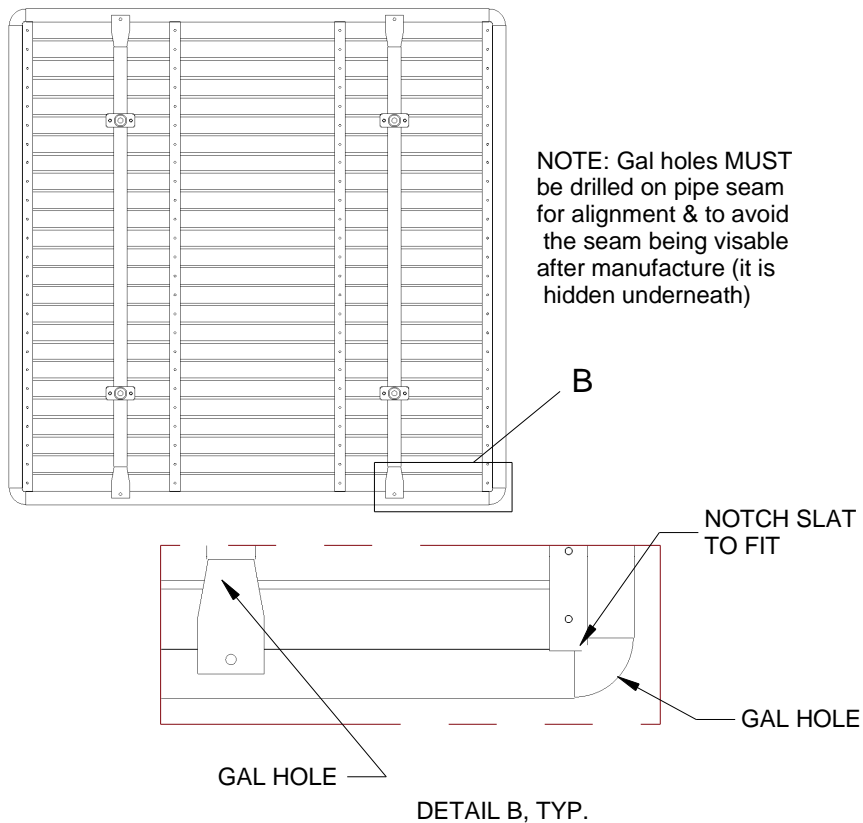

ASSEMBLY

1. Inspect table profile for any imperfections
2. Place table profile onto work bench
3. Place all timbers into table and fasten lightly, once all coach bolts are in place tighten all
4. Turn table upside down and fasten centre braces using timber tek screws
5. Place table to side for Final Inspection and packaging.

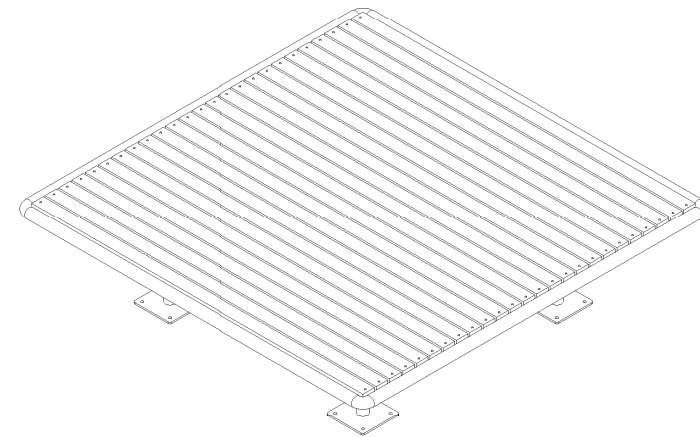

Quality
ISO 9001
SAI GLOBAL

© copyright

CONFIDENTIAL

REVISION	#	DESCRIPTION	BY	DATE	DRAWN	DRAWN DATE	CHECKED	CHECKED DATE	SCALE	A4
	1	ORIGINAL DRAWING	RBC	5.11.13	R.CRIGTON	5.11.13			N/A	
	2									
	3									
	4									
	5									
							WOODGROVE SQUARE PLATFORM - BOLT DOWN ASSEMBLY			
							FFSB003024		REV. 1	SHEET 3 OF 3

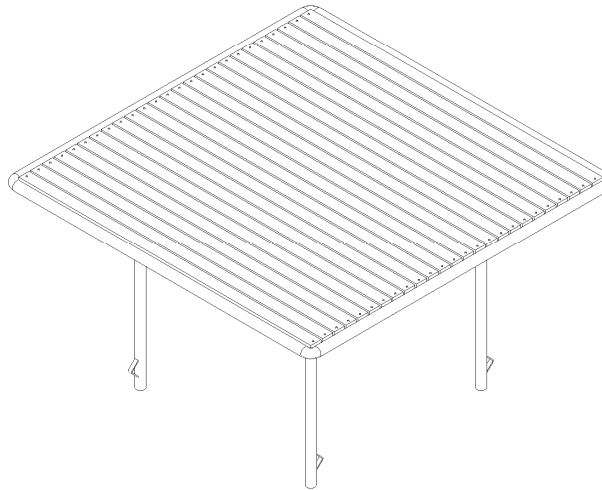
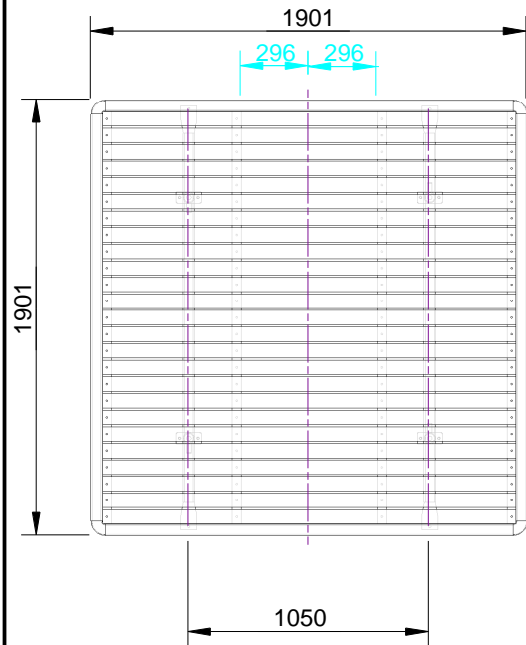

SPECIFICATION:

MATERIAL:

Mild steel unless otherwise stated
Slats - Hardwood timber 63x30mm

DIMENSIONS:

All in mm unless otherwise stated

FINISH:

Steel - Galvanised and optional Powder Coat
Timber - Oil Based

GROUND FIXINGS:

In Ground

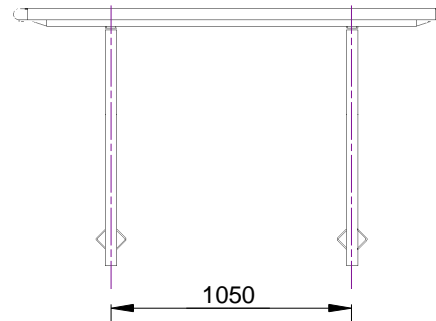
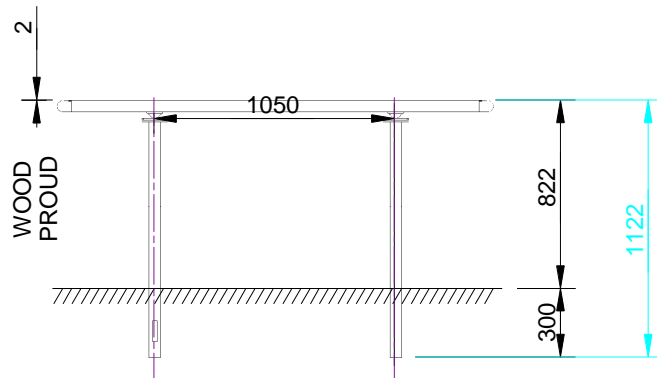

Quality
ISO 9001
SAI GLOBAL

© copyright

CONFIDENTIAL

REVISION	#	DESCRIPTION	BY	DATE	DRAWN	DRAWN DATE	CHECKED	CHECKED DATE	SCALE	A4
	1	ORIGINAL DRAWING	RBC	12.11.13	R.CRIGTON	12.11.13			N/A	
	2									
	3									
	4									
	5									
						WOODGROVE SQUARE TABLE - IN GROUND SPEC.				
						FFSB003027		REV. 1	SHEET 1 OF 3	

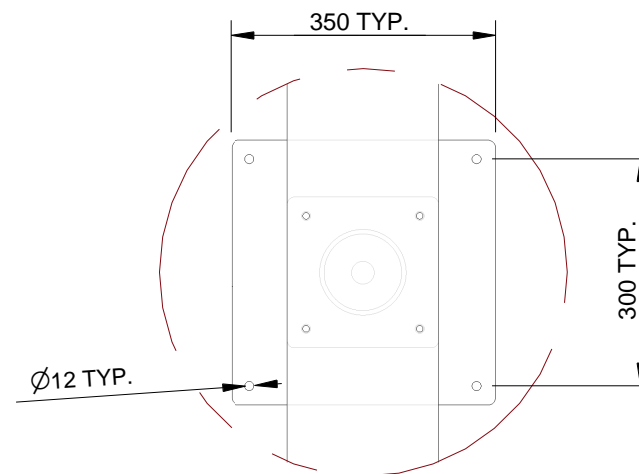
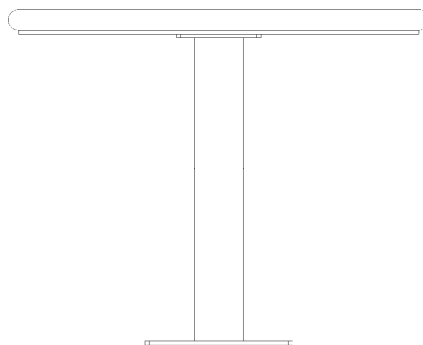
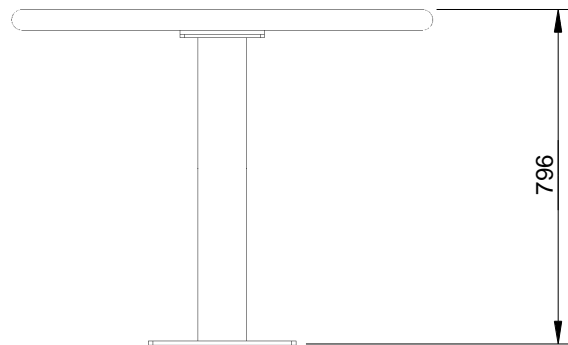
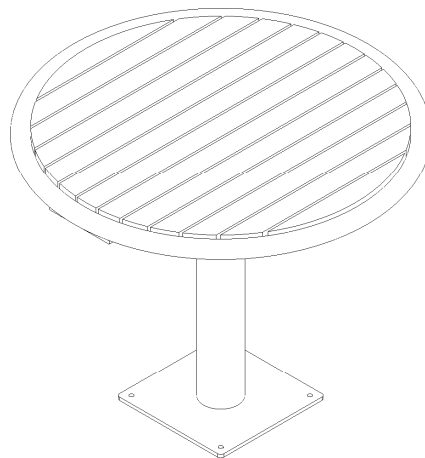
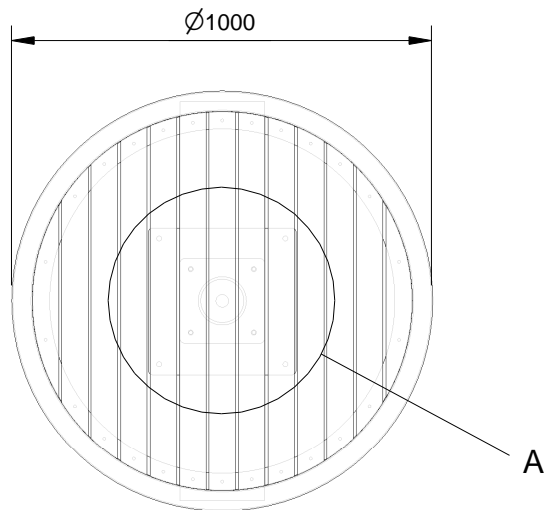

SPECIFICATION:

Material:

Mild steel unless otherwise stated
Slats: Hardwood Timber 63x30mm

Dimensions:

All in mm unless otherwise stated

Finish:

Steel - Galvanised and optional Powder Coat
Timber - Oil Based

Ground Fixings:

Bolt down



Quality
ISO 9001

SAI GLOBAL

© copyright

CONFIDENTIAL

REVISION	#	DESCRIPTION	BY	DATE	DRAWN	DRAWN DATE	CHECKED	CHECKED DATE	SCALE	A4	
	1	ORIGINAL DRAWING	RBC	18.11.13	R.CRIGTON	18.11.13			N/A		
	2						WOODGROVE CIRCULAR TABLE (1000 OD) -BOLT DOWN -SPEC.				
	3										
	4						FFSB003028		REV. 1		SHEET 1 OF 3
	5										



Quality
ISO 9001
SAI GLOBAL

SPECIFICATION:

Material:

Mild steel unless otherwise stated
Slats: Hardwood Timber 63x30mm

Dimensions:

All in mm unless otherwise stated

Finish:

Steel - Galvanised and optional Powder Coat
Timber - Oil Based

Ground Fixings:

Bolt down

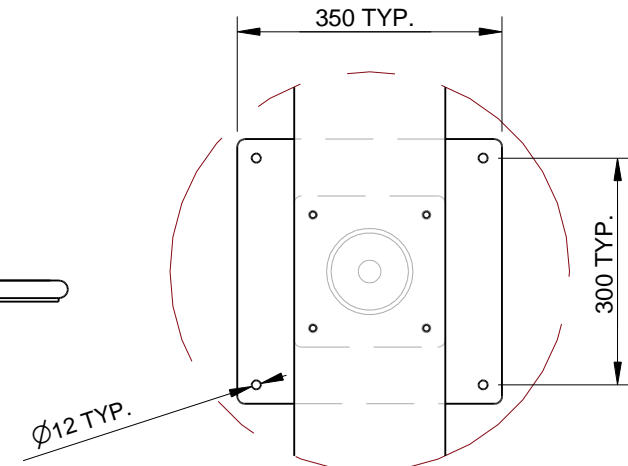
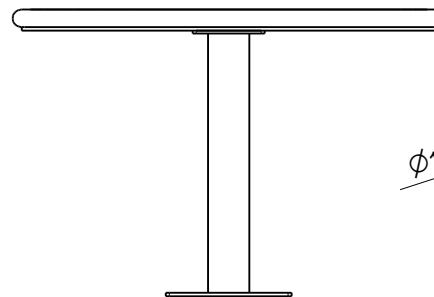
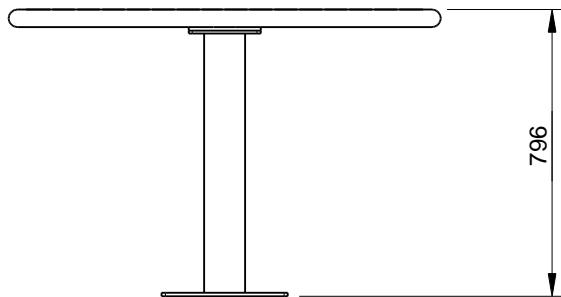
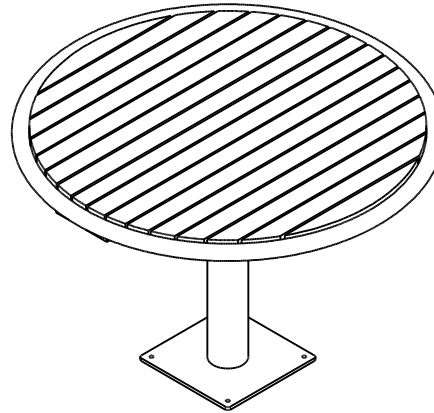
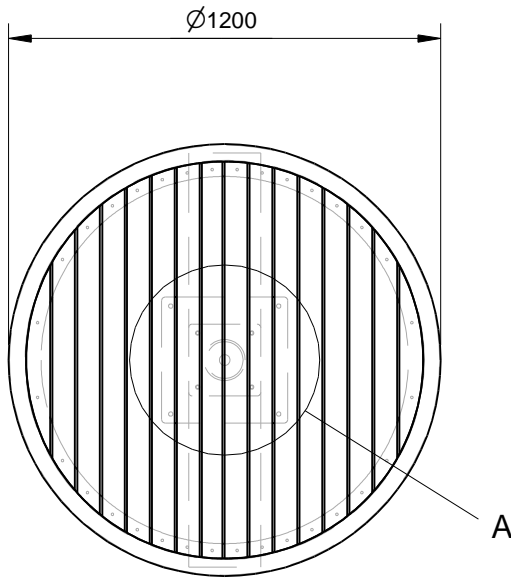

DETAIL A
TIMBER SLATS REMOVED FOR CLARRITY

© copyright

CONFIDENTIAL

REVISION	#	DESCRIPTION	BY	DATE	DRAWN	DRAWN DATE	CHECKED	CHECKED DATE	SCALE	A4		
	1	ORIGINAL DRAWING	RBC	19.11.13	R.CRIGTON	19.11.13			N/A			
	2						WOODGROVE CIRCULAR TABLE (1200 OD) - BOLT DOWN - SPEC.					
	3											
	4						FFSB003029				REV.	SHEET
	5										1	1 OF 3

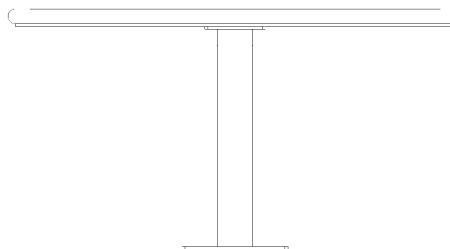
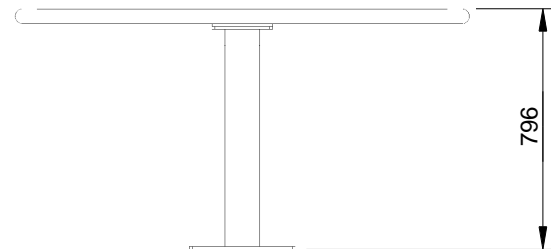
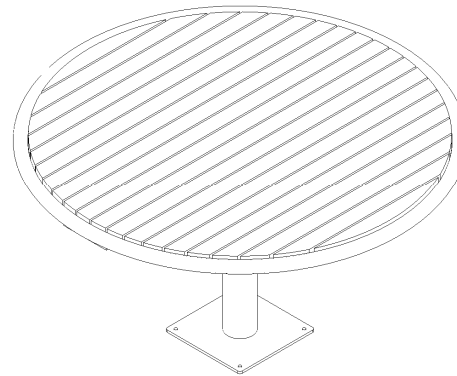
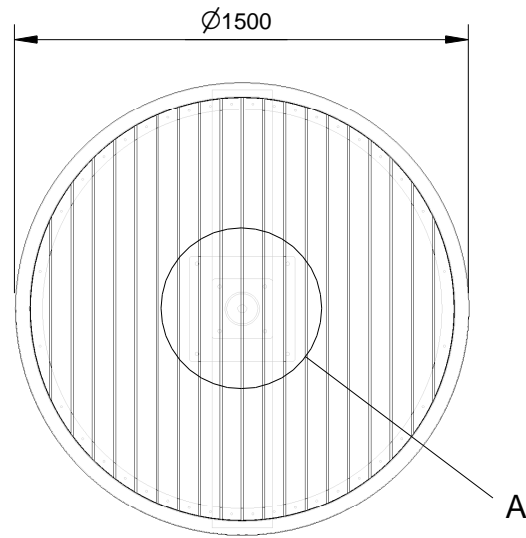

SPECIFICATION:

Material:

Mild steel unless otherwise stated
Slats: Hardwood Timber 63x30mm

Dimensions:

All in mm unless otherwise stated

Finish:

Steel - Galvanised and optional Powder Coat
Timber - Oil Based

Ground Fixings:

Bolt down



Quality
ISO 9001
SAI GLOBAL

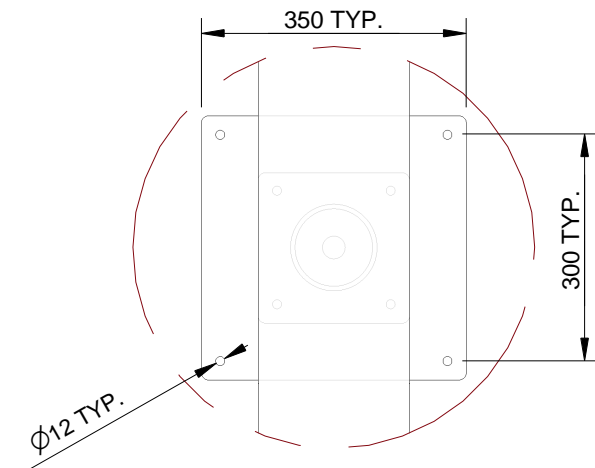

DETAIL A
TIMBER SLATS REMOVED FOR CLARRITY

© copyright

CONFIDENTIAL

REVISION	#	DESCRIPTION	BY	DATE	DRAWN	DRAWN DATE	CHECKED	CHECKED DATE	SCALE	A4
	1	ORIGINAL DRAWING	RBC	19.11.13	R.CRUGHTON	19.11.13			N/A	
	2									
	3									
	4									
	5									
							WOODGROVE CIRCULAR TABLE (1500 OD) - BOLT DOWN - SPEC.			
							FFSB003030	REV. 1	SHEET 1 OF 3	

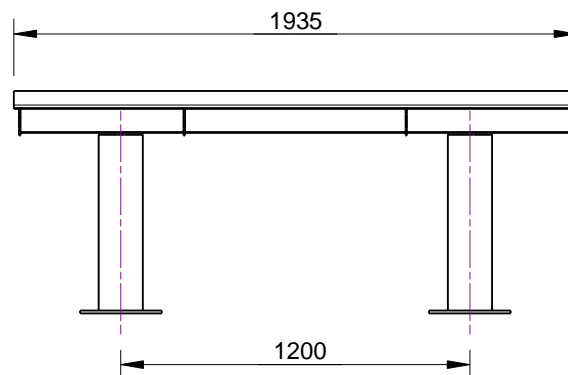
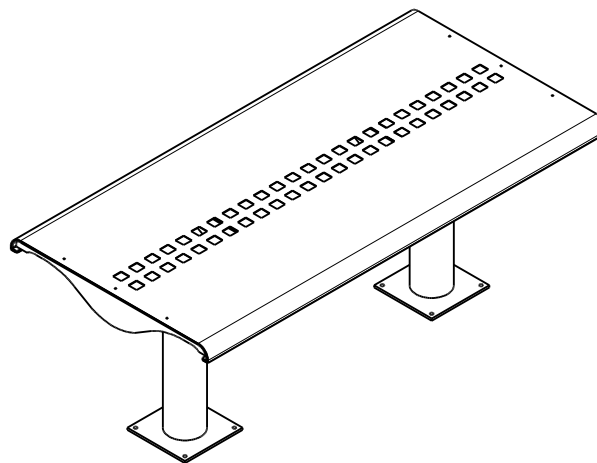
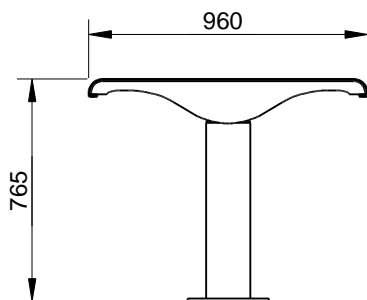
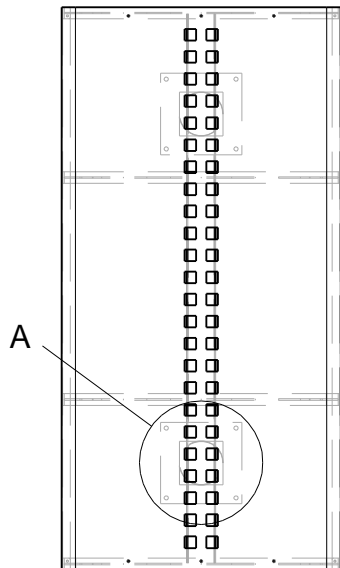

SPECIFICATION:

MATERIAL:

Main construction - 304 Stainless steel
(Also available in MS)
Fixings - Stainless steel

DIMENSIONS:

mm unless otherwise stated

FINISH:

No.4 Polished

GROUND ATTACHEMENT:

Bolt down



Quality
ISO 9001

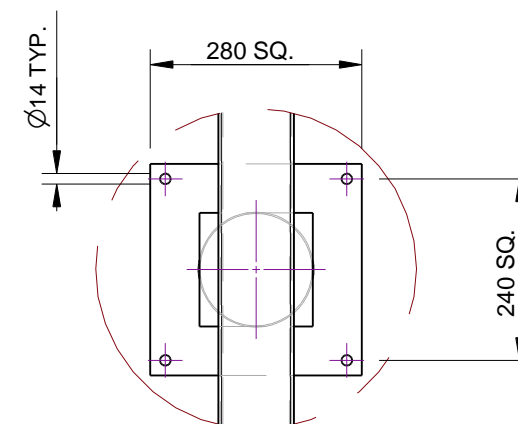

Detail A
BOLT DOWN DETAIL
TOP REMOVED
FOR CLARITY

© copyright
CONFIDENTIAL

REVISION	#	DESCRIPTION	BY	DATE	DRAWN	DRAWN DATE	CHECKED	CHECKED DATE	SCALE	A4
	1	ORIGINAL DRAWING	DN	10.11.10	R.CRIGTON	5.2.14			N/A	
	2	FULL PRODUCT REVIEW	RBC	5.2.14						
	3									
	4									
	5									
							LYNDARUM TABLE - BOLT DOWN SPEC.			
							FFSC003001	REV. 2	SHEET 1 OF 3	

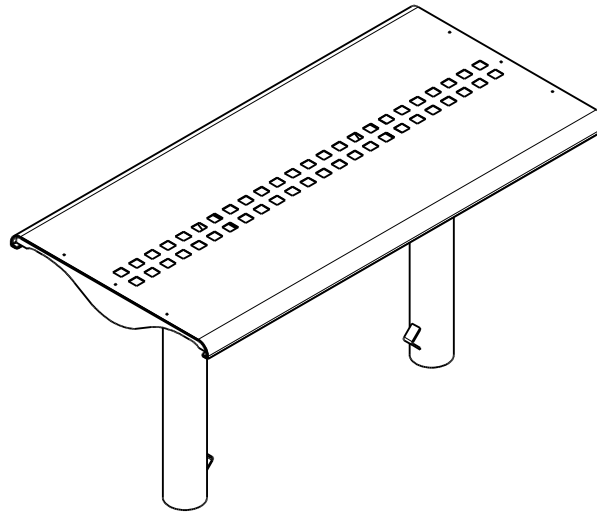
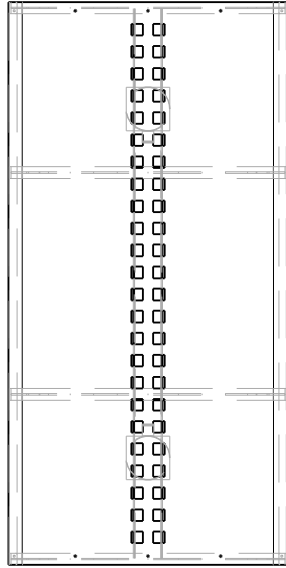

SPECIFICATION:

MATERIAL:

Main construction - 304 Stainless steel
(Also available in MS)
Fixings - Stainless steel

DIMENSIONS:

mm unless otherwise stated

FINISH:

No.4 Polished

GROUND ATTACHEMENT:

In ground



Quality
ISO 9001
SAI GLOBAL

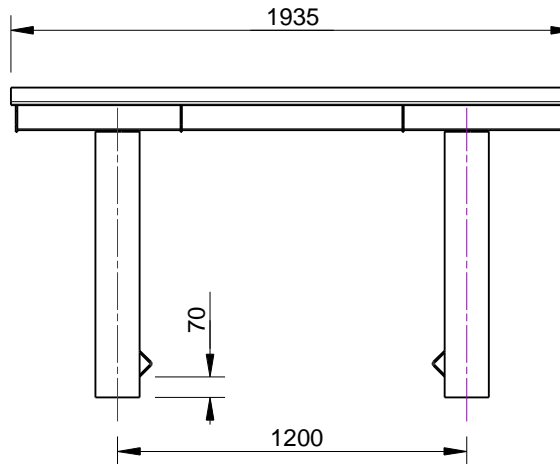
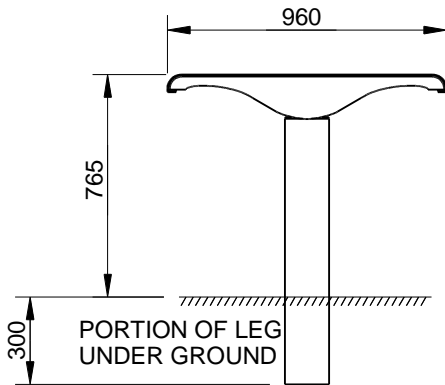

© copyright

CONFIDENTIAL

REVISION	#	DESCRIPTION	BY	DATE	DRAWN	DRAWN DATE	CHECKED	CHECKED DATE	SCALE	A4
	1	ORIGINAL DRAWING	DN	10.11.10	R.CRIGTON	6.2.14			N/A	
	2	FULL PRODUCT REVIEW	RBC	6.2.14						
	3									
	4									
	5									
							LYNDARUM TABLE - IN GROUND SPEC.			
							FFSC003002	REV. 2	SHEET 1 OF 3	