



Quality  
ISO 9001  
SAI GLOBAL

**SPECIFICATION:**

**MATERIALS:**  
 Bench Ends - Recycled Cast Aluminium  
 Timbers - Hardwood Timber  
 Straps - Grade 304 Stainless steel  
 Fixings - Grade 304 Stainless steel

**DIMENSIONS:**  
 All in mm unless otherwise stated

**FINISH:**  
 Castings - Mill Finish or Powdercoat  
 Timber - Oil Based

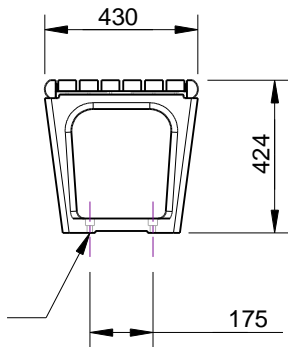
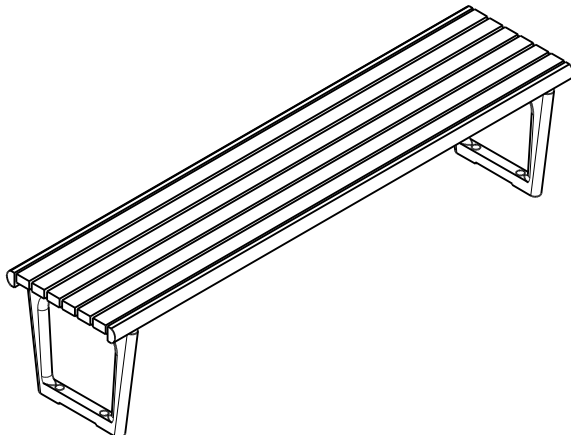
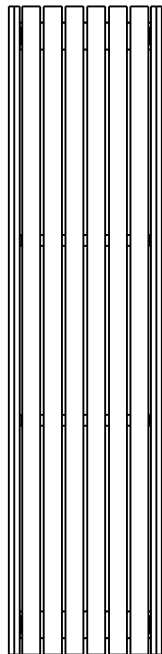

**BOLT DOWN DETAIL**  
 Ø15 THRU  
 Ø25 C.B. 15 DEEP  
 4 LOCATIONS

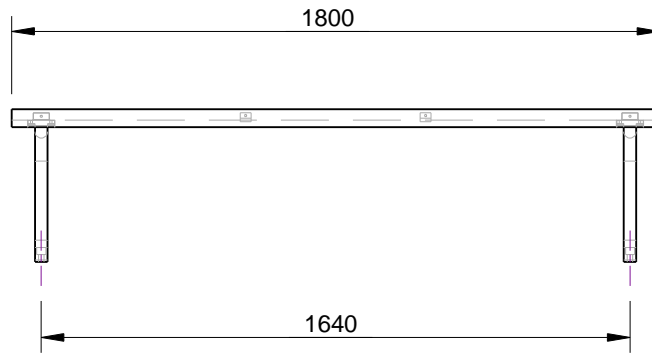

CONFIDENTIAL

REVISION	#	DESCRIPTION	BY	DATE	DRAWN	DRAWN DATE	CHECKED	CHECKED DATE	SCALE	A4
	1	ORIGINAL DRAWING	DN	20.9.10	R.CRIGTON	26.11.13				
2	FULL PRODUCT REVIEW	RBC	26.11.13							
3										
4										
5										

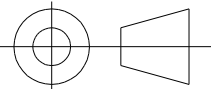

METRO BENCH  
SPEC.

FFSA001001

REV.  
2

SHEET  
1 OF 4

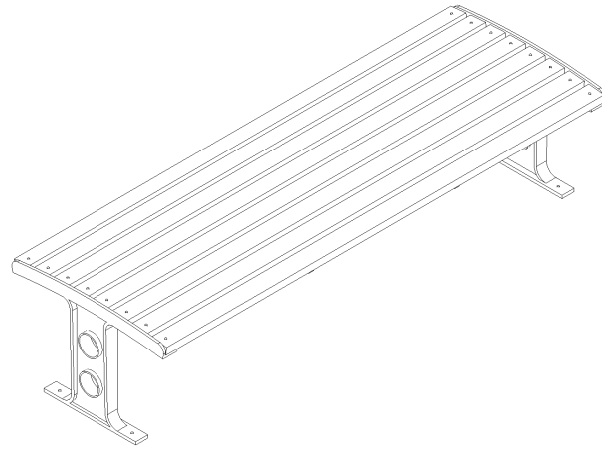
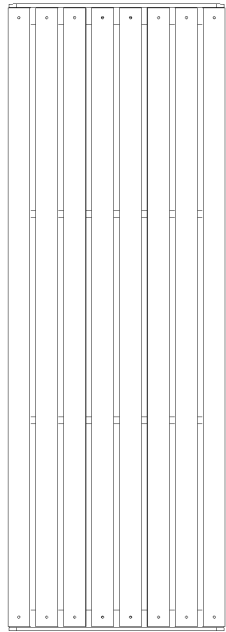

## SPECIFICATION:

### MATERIALS:

Bench Ends - Recycled Cast aluminium  
 Timbers - Hardwood Timber Slats  
 Straps - Mild Steel

### DIMENSIONS:

mm unless otherwise stated

### FINISH:

Castings - Mill Finish or Optional Powder Coat  
 Timber - Oil Based

### GROUND FIXING:

Bolt Down



Quality  
 ISO 9001

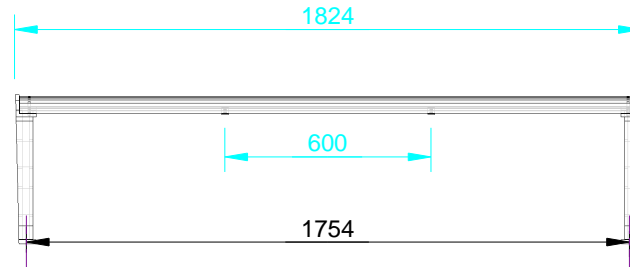
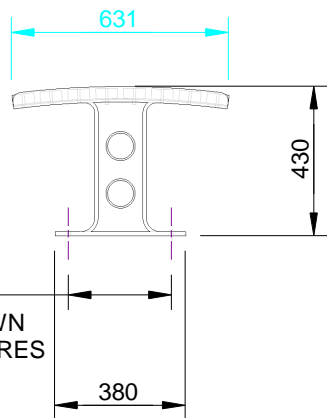

300  
 BOLT DOWN  
 HOLE CENTRES

1754  
 BOLT DOWN  
 HOLE CENTRES



copyright

CONFIDENTIAL

REVISION	#	DESCRIPTION	BY	DATE	DRAWN	DRAWN DATE	CHECKED	CHECKED DATE	SCALE	A4
	1	ORIGINAL DRAWING	DN	5.10.10	R.CRIGTON	27.11.13			N/A	
2	FULL PRODUCT REVIEW	RBC	27.11.13							
3										
4										
5										

FIESTA BENCH  
 SPEC.

FFSA001005

REV.  
2

SHEET  
1 OF 3



Quality  
ISO 9001  
SAI GLOBAL

## SPECIFICATION :

### MATERIAL:

Seat ends - Recycled cast aluminium  
Frame & Slats - Mild Steel construction

### DIMENSIONS:

mm unless otherwise stated

### FINISH:

Castings - Milled or Powder coat (optional)  
Slats - Galvanised with optional powder coat

### GROUND ATTACHMENT:

Bolt down

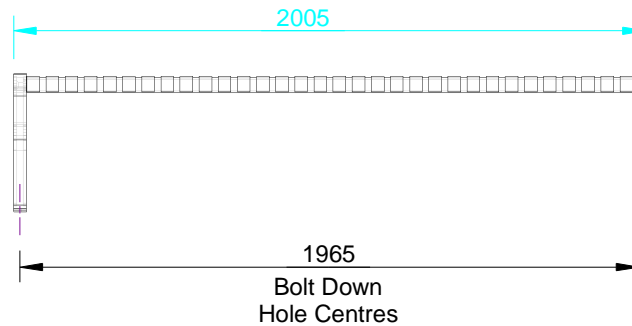
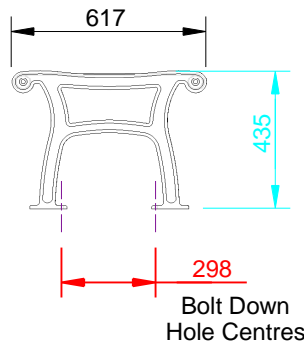
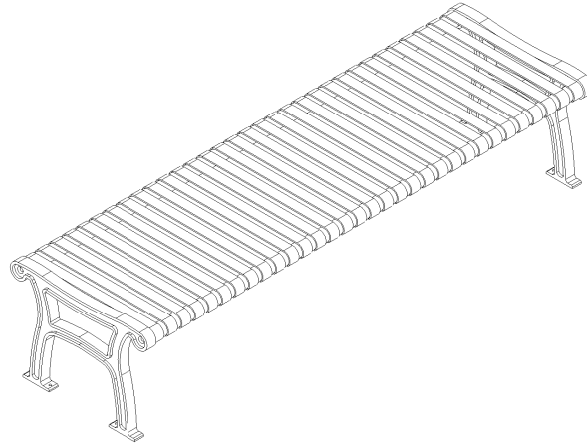
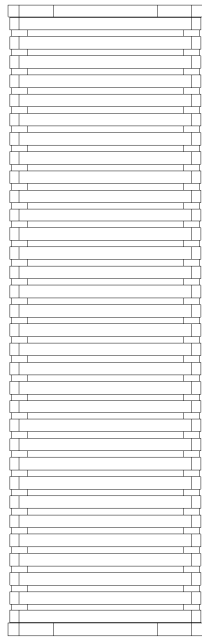

CONFIDENTIAL

REVISION #	DESCRIPTION	BY	DATE	DRAWN	DRAWN DATE	CHECKED	CHECKED DATE	SCALE	A4
								N/A	
1	ORIGINAL DRAWING	DN	12.11.10	R.CRIGTON	27.11.13				
2	FULL PRODUCT REVIEW	RBC	27.11.13						
3									
4									
5									

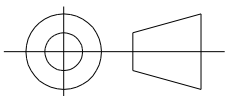

STEEL SLATTED COUNCIL BENCH SPEC.  
FFSA001007 REV. 2 SHEET 1 OF 4



Quality  
ISO 9001  
SAI GLOBAL

**SPECIFICATION:**

**MATERIALS:**  
Bench Ends - Recycled Cast Aluminium  
Timbers Slats - Hardwood Timber  
Strap - Stainless steel

**DIMENSIONS:**  
mm unless otherwise stated

**FINISH:**  
Castings - Mill Finish or Optional Powder Coat  
Timber - Oil Based

**GROUND ATTACHMENT:**  
Bolt down

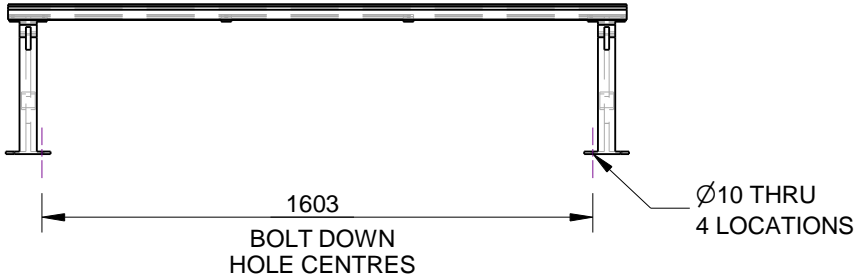
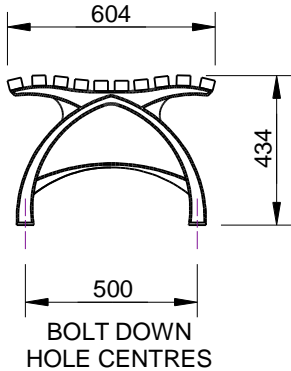
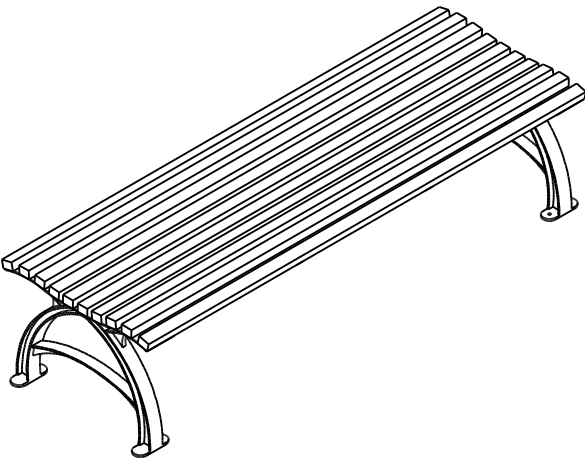
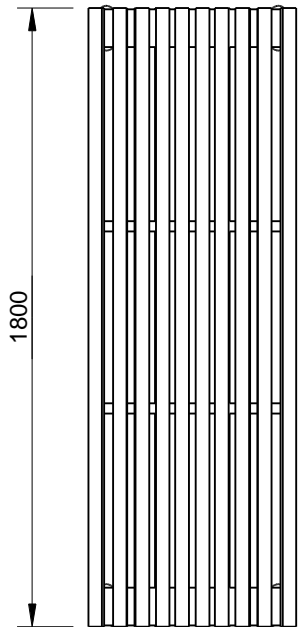

copyright

CONFIDENTIAL

REVISION #	DESCRIPTION	BY	DATE	DRAWN	DRAWN DATE	CHECKED	CHECKED DATE	SCALE	A4
1	ORIGINAL DRAWING	DN	30.11.10	R.CRIGTON	27.11.13			N/A	
2	FULL PRODUCT REVIEW	RBC	27.11.13						
3									
4									
5									

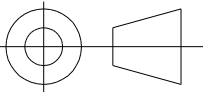

OMEGA BENCH  
SPEC.

FFSA001008

REV.  
2

SHEET  
1 OF 3



Quality  
ISO 9001  
SAI GLOBAL

## SPECIFICATION:

### MATERIALS:

Bench Ends - Recycled Cast aluminium  
Timbers Slats- Hardwood Timber  
Strap - Mild steel

### DIMENSIONS:

mm unless otherwise stated

### FINISH:

Castings - Mill Finish or Optional Powder Coat  
Timber - Oil Based

### GROUND ATTACHMENT:

Bolt down

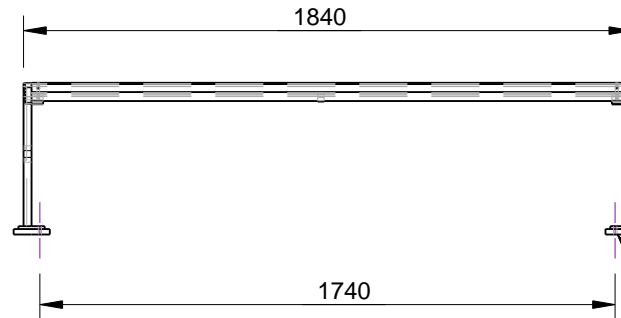
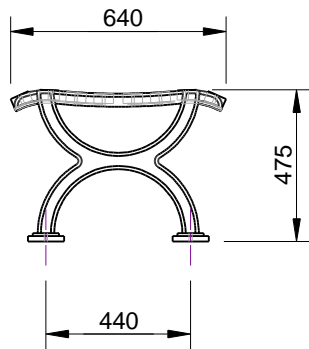
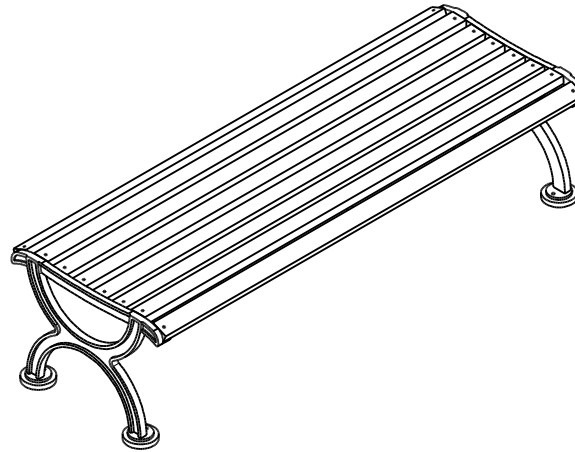
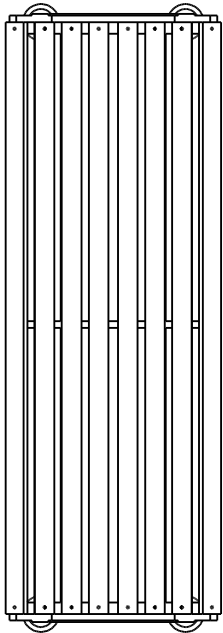

### BOLT DOWN DETAIL

Ø10 THRU  
4 LOCATIONS



CONFIDENTIAL

REVISION #	DESCRIPTION	BY	DATE	DRAWN	DRAWN DATE	CHECKED	CHECKED DATE	SCALE	A4
2	FULL PRODUCT REVIEW	RBC	28.11.13						
3									
4									
5									

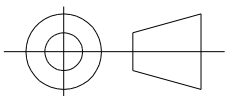

PLAZA BENCH  
SPEC.

FFSA001010

REV.  
2

SHEET  
1 OF 3

# SPECIFICATION:

## MATERIAL:

Bench Ends & Centre Support - Recycled Cast Aluminium  
 Legs - Stainless Steel  
 Timber Slats - Hardwood Timber  
 Fixings - Stainless Steel

## DIMENSIONS:

mm unless otherwise stated

## FINISH:

Castings - Mill Finish  
 Timber - Oil Based

## GROUND FIXING:

Bolt down

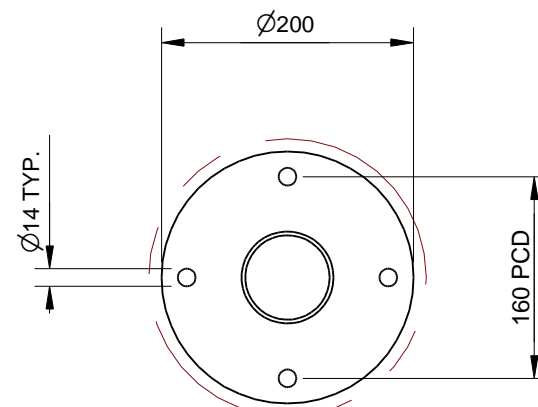
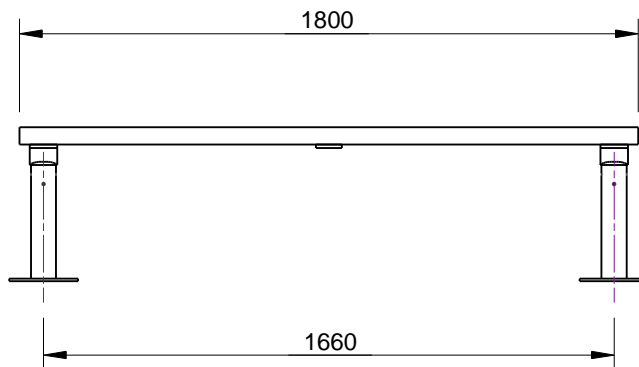
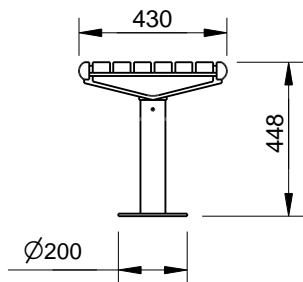
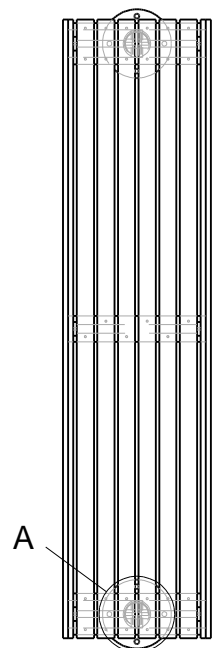
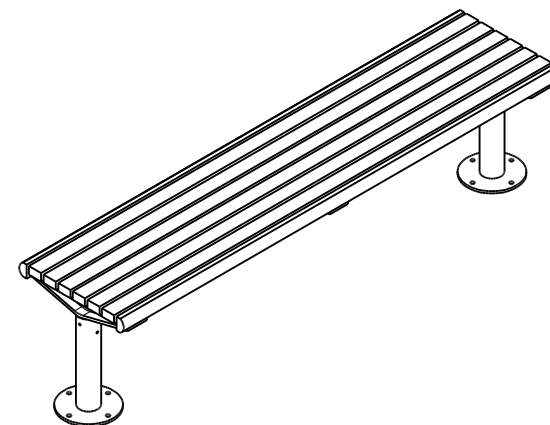

Detail A  
 BOLT DOWN DETAIL  
 TIMBERS & CASTING  
 HIDDEN FOR CLARRITY

© copyright  
 CONFIDENTIAL

REVISION	#	DESCRIPTION	BY	DATE	DRAWN	DRAWN DATE	CHECKED	CHECKED DATE	SCALE	A4
	1	ORIGINAL DRAWING	DN	30.7.10	R.CRIGTON	28.11.13			N/A	
2	FULL PRODUCT REVIEW	RBC	28.11.13							
3										
4										
5										

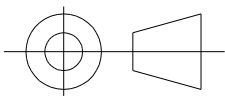

PROMENADE BENCH - BOLT DOWN SPEC.

FFSA001012 REV. 2 SHEET 1 OF 4



Quality  
ISO 9001  
SAI GLOBAL

## SPECIFICATION:

### MATERIAL:

Bench Ends & Centre Support - Recycled Cast Aluminium  
Legs - Stainless Steel  
Timber Slats - Hardwood Timber  
Fixings - Stainless Steel

### DIMENSIONS:

mm unless otherwise stated

### FINISH:

Castings - Mill Finish  
Timber - Oil Based

### GROUND FIXING:

In ground

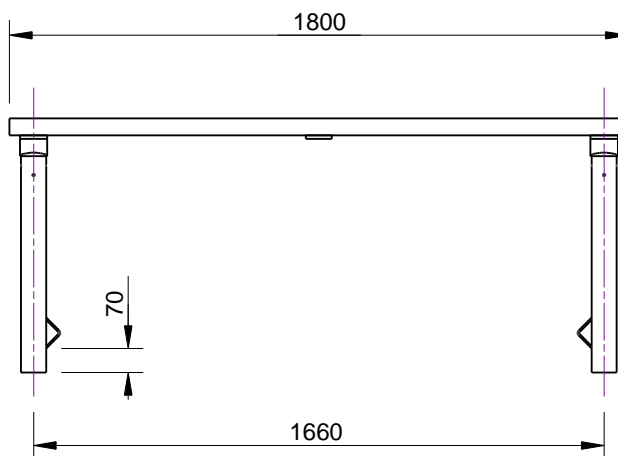
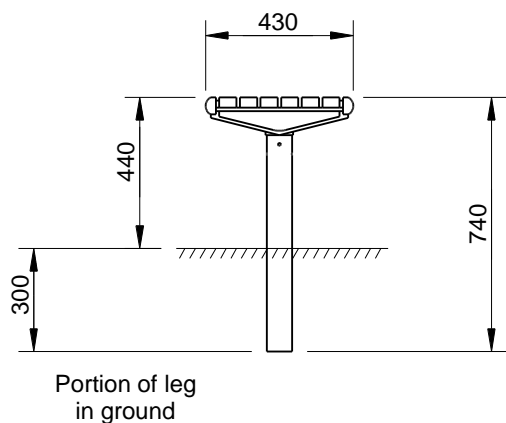
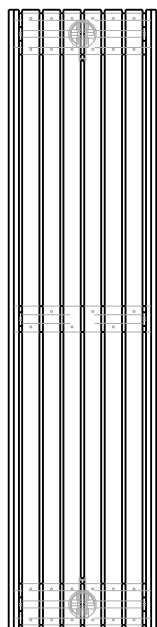
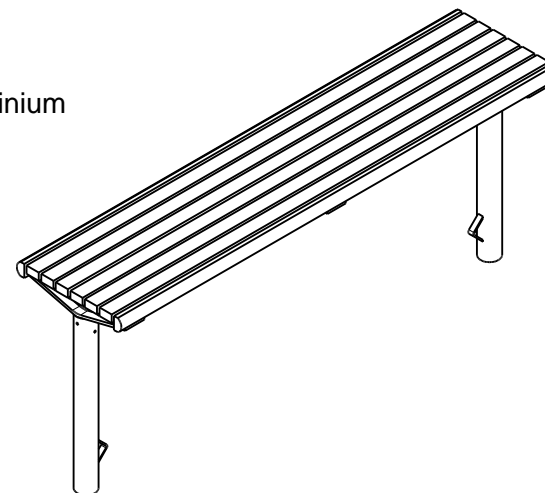

© copyright  
CONFIDENTIAL

REVISION	#	DESCRIPTION	BY	DATE	DRAWN	DRAWN DATE	CHECKED	CHECKED DATE	SCALE	A4
	1	ORIGINAL DRAWING	SJ	6.6.11	R.CRIGTON	28.11.13			N/A	
2	FULL PRODUCT REVIEW	RBC	28.11.13							
3										
4										
5										
							PROMENADE BENCH - IN GROUND SPEC.			
							FFSA001013	REV. 2	SHEET 1 OF 4	

## SPECIFICATION:

### MATERIAL:

Bench Ends & Centre Support - Recycled Cast Aluminium  
 Legs - Stainless Steel  
 Timber Slats - Hardwood Timber  
 Fixings - Stainless Steel

### DIMENSIONS:

mm unless otherwise stated

### FINISH:

Castings - Mill Finish  
 Timber - Oil Based

### GROUND FIXING:

Bolt down

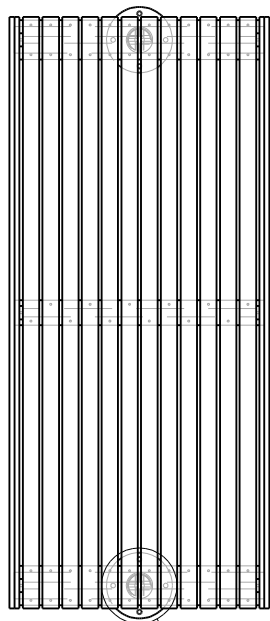

A

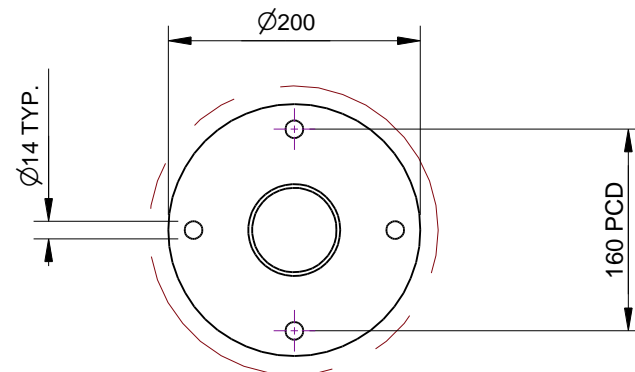
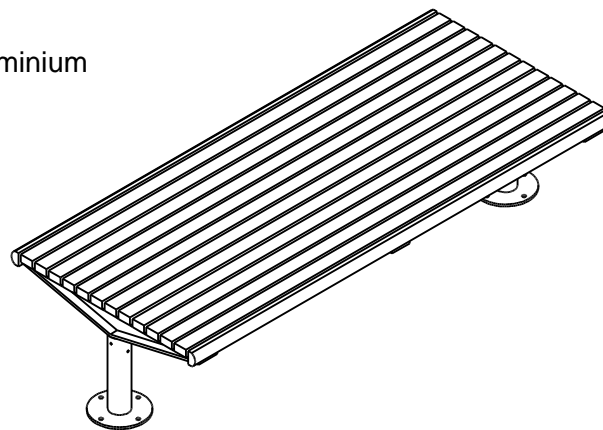
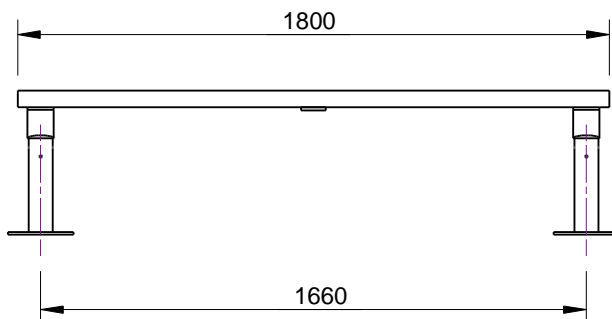
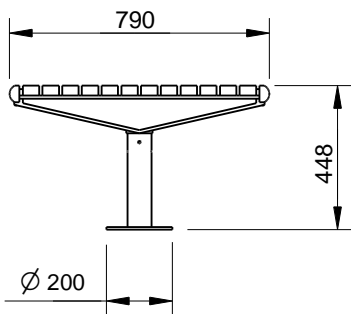

Detail A  
 BOLT DOWN DETAIL  
 TIMBERS & CASTING  
 HIDDEN FOR CLARRITY

© copyright

CONFIDENTIAL

REVISION	#	DESCRIPTION	BY	DATE	DRAWN	DRAWN DATE	CHECKED	CHECKED DATE	SCALE	A4
	1	ORIGINAL DRAWING	DN	17.8.10	R.CRIGTON	29.11.13			N/A	
2	FULL PRODUCT REVIEW	RBC	29.11.13							
3										
4										
5										

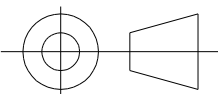

PROMENADE SEATING DECK - BOLT DOWN SPEC.

FFSA001014

REV. 2

SHEET 1 OF 4



# SIGNIFICANT CHARACTERISTICS & DETAIL:

DETAIL A: This shows positioning timbers in relation to casting and positioning of bull nose slat.

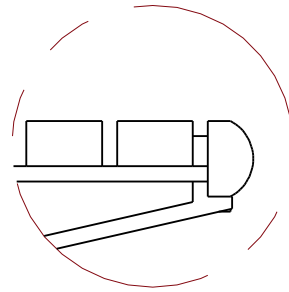
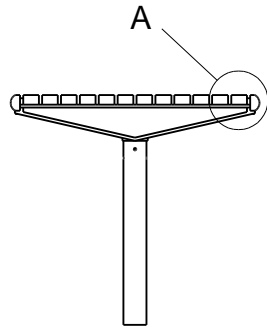

Detail A

**Finish: Mill & Powder coated finishes given as an option, refer to works order for required finish.**

NOTE: For fettling/grinding/finishing refer to - Fettling Procedure (Grinding steps) sheet.

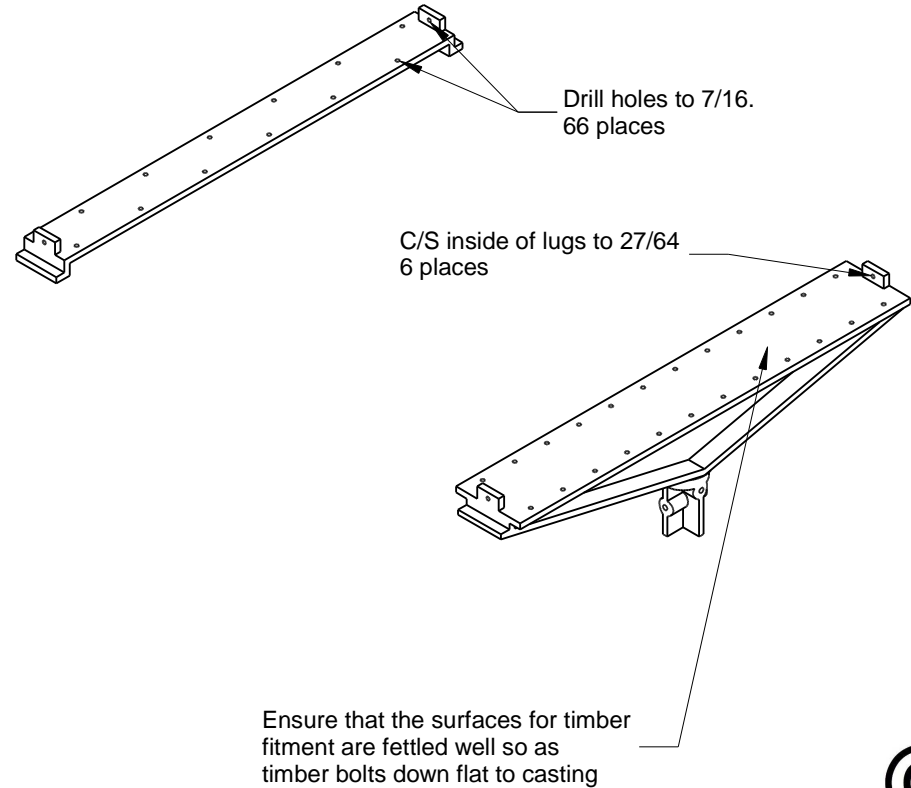

Quality  
ISO 9001  
SAI GLOBAL



CONFIDENTIAL

REVISION	#	DESCRIPTION	BY	DATE	DRAWN	DRAWN DATE	CHECKED	CHECKED DATE	SCALE	A4
	1	ORIGINAL DRAWING	DN	17.8.10	R.CRIGTON	29.11.13			N/A	
2	FULL PRODUCT REVIEW	RBC	29.11.13							
3										
4										
5										

PROMENADE SEATING DECK - IN GROUND  
FETTLING PROCEDURE & DETAILS

FFSA001015

REV. 2

SHEET 4 OF 4





Quality  
ISO 9001  
SAI GLOBAL

## SPECIFICATION:

### MATERIALS:

Bench Ends - Recycled Cast Aluminium  
Timbers - Hardwood Timber  
Straps - Grade 304 Stainless steel

### DIMENSIONS:

mm unless otherwise stated

### FINISH:

Castings - Mill Finish  
Timber - Oil Based

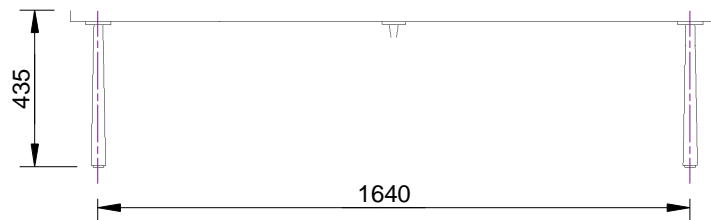
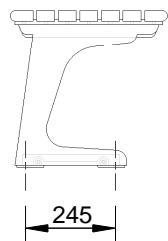
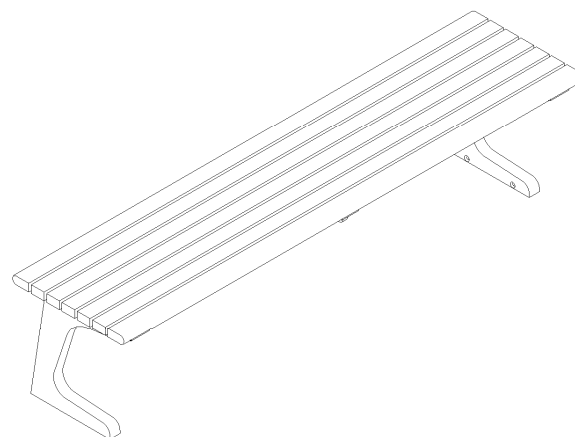
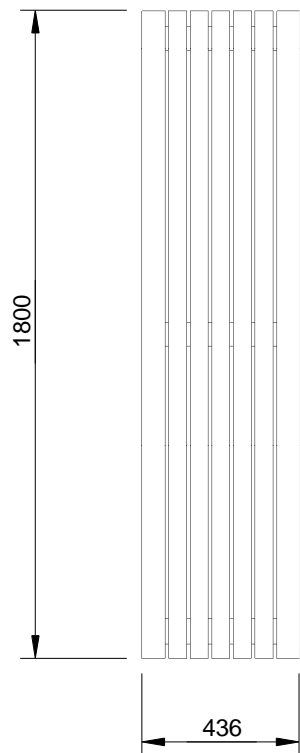

CONFIDENTIAL

REVISION	#	DESCRIPTION	BY	DATE	DRAWN	DRAWN DATE	CHECKED	CHECKED DATE	SCALE	A4
	1	ORIGINAL DRAWING	DN	13.9.10	R.CRIGTON	7.11.13			N/A	
2	FULL PRODUCT REVIEW	RBC	7.11.13							
3										
4										
5										

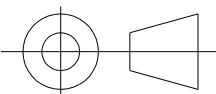

FULCRUM BENCH  
SPEC.

FFSA001017

REV.  
2

SHEET  
1 OF 4



Quality  
ISO 9001  
SAI GLOBAL

# SPECIFICATION:

**Material:**  
Frame & Slats: Mild Steel Construction

**Dimensions:**  
All in mm unless otherwise stated

**Finish:**  
Steel - Galvanised and optional Powder Coat

**Ground Fixings:**  
Bolt Down

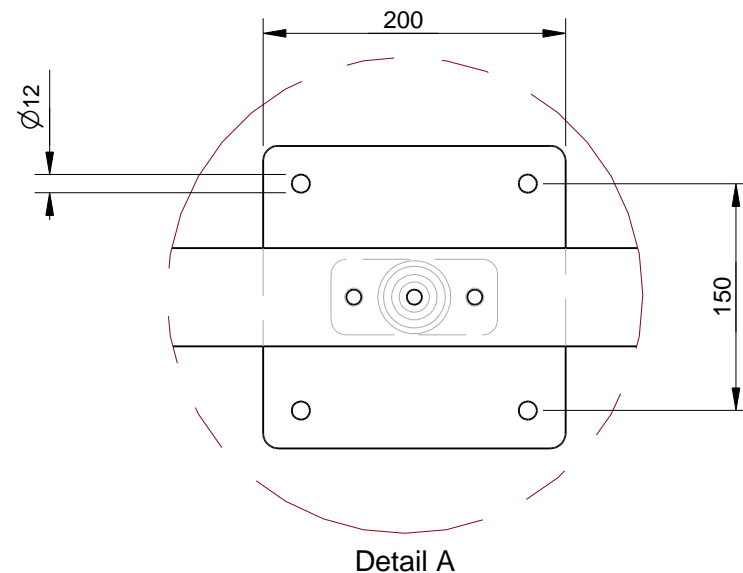
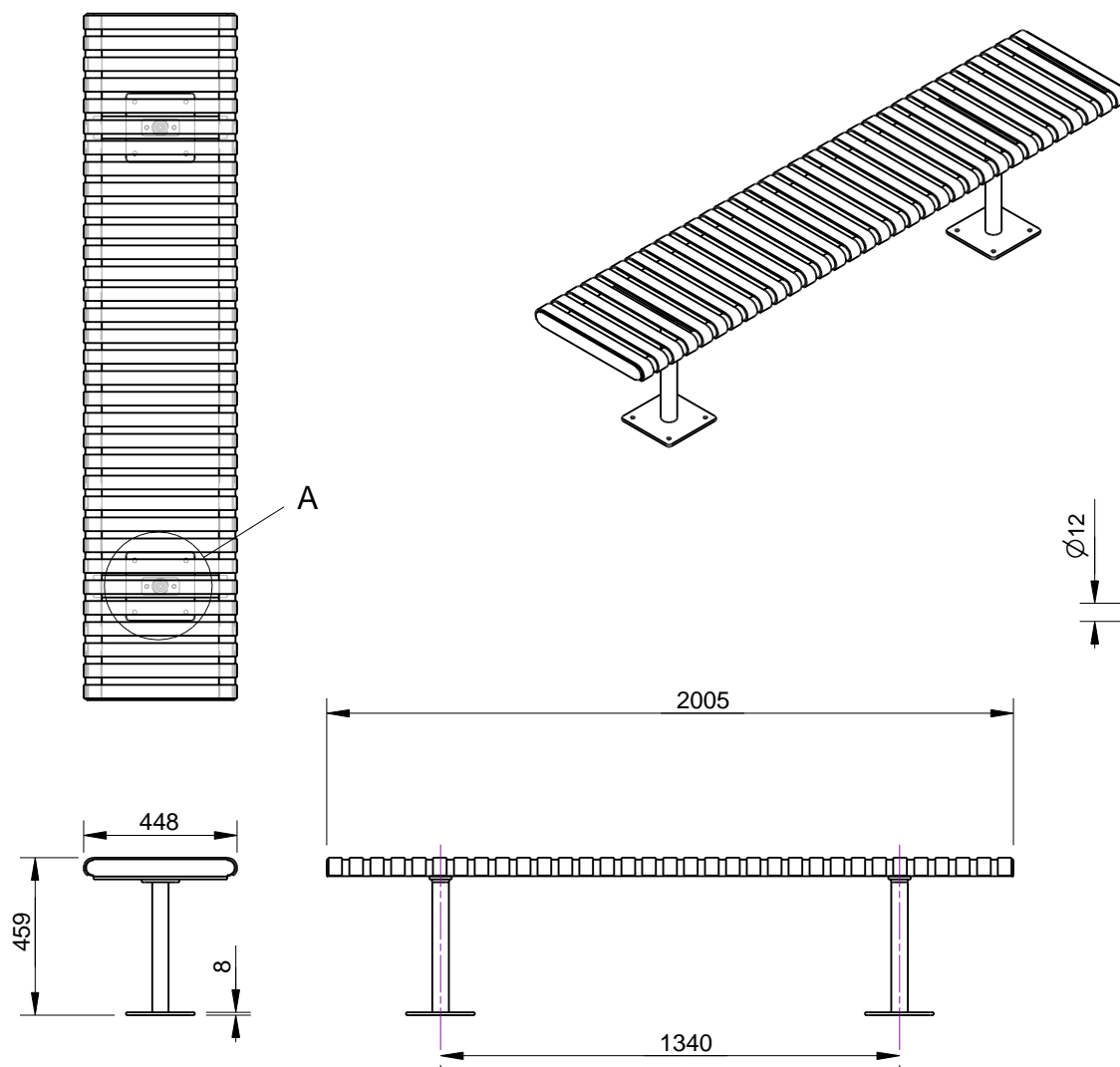

© copyright  
CONFIDENTIAL

REVISION #	DESCRIPTION	BY	DATE	DRAWN	DRAWN DATE	CHECKED	CHECKED DATE	SCALE	
								N/A	
1	ORIGINAL DRAWING	SJ	25.5.10	R.CRIGTON	10.12.13			A4	
2	FULL PRODUCT REVIEW	RBC	10.12.13					STEEL SLATTED BENCH - BOLT DOWN SPEC.	
3								FFSB001001	REV. 2
4									SHEET 1 OF 2
5									

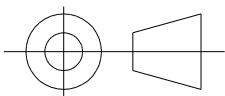

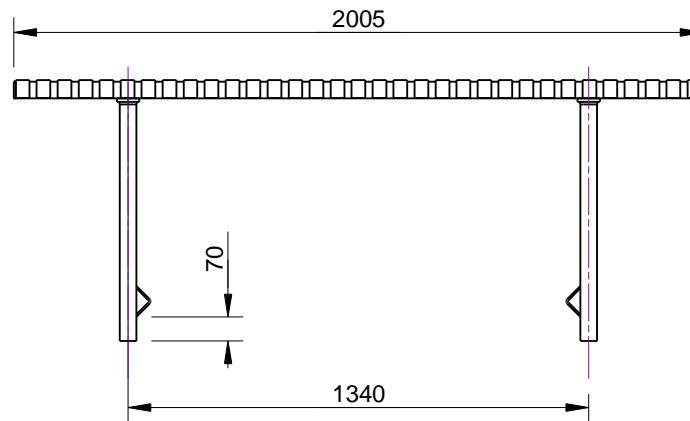
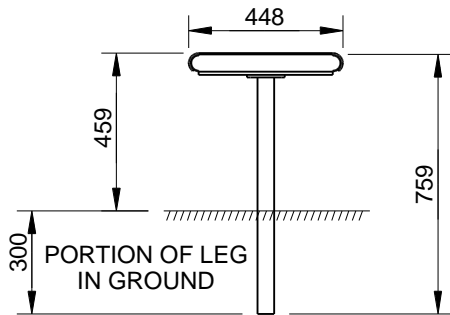
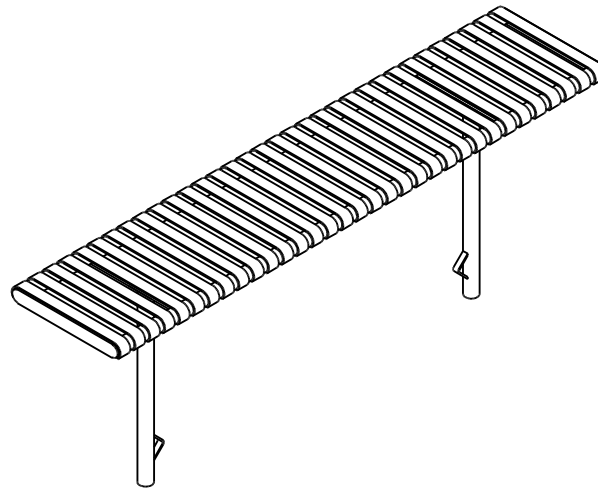
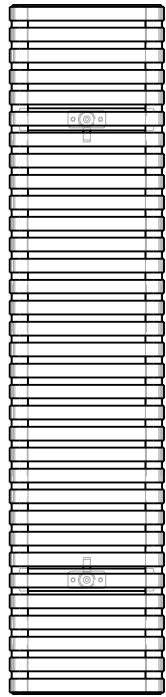

# SPECIFICATION:

**Material:**  
Frame & Slats: Mild Steel Construction

**Dimensions:**  
All in mm unless otherwise stated

**Finish:**  
Steel - Galvanised and optional Powder Coat

**Ground Fixings:**  
In ground



Quality  
ISO 9001  
SAI GLOBAL

© copyright  
CONFIDENTIAL

REVISION	#	DESCRIPTION	BY	DATE	DRAWN	DRAWN DATE	CHECKED	CHECKED DATE	SCALE	A4
	1	ORIGINAL DRAWING		SJ	25.5.10	R.CRIGTON	11.12.13			
2	FULL PRODUCT REVIEW		RBC	11.12.13						
3										
4										
5										
							STEEL SLATTED BENCH - IN GROUND SPEC.			
							FFSB001003	REV. 2	SHEET 1 OF 2	



Quality  
ISO 9001



# SPECIFICATION:

**Material:**

Frame: Mild Steel Construction  
Slats: Hardwood Timber 63x30mm

**Dimensions:**

All in mm unless otherwise stated

**Finish:**

Steel - Galvanised and optional Powder Coat  
Timber - Oil Based

**Ground Fixings:**

Bolt Down

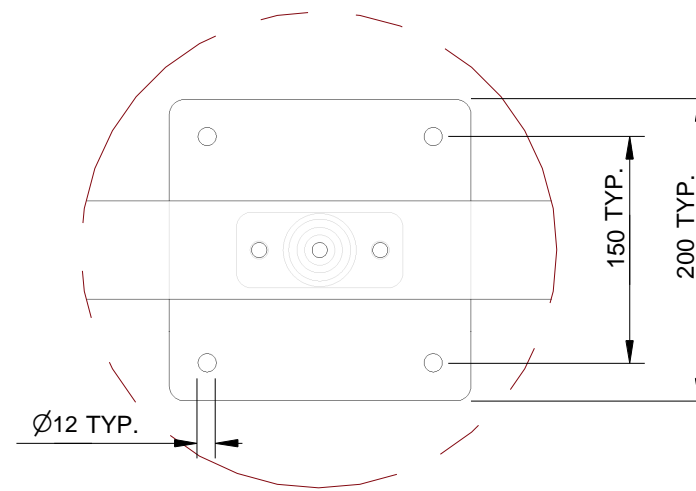
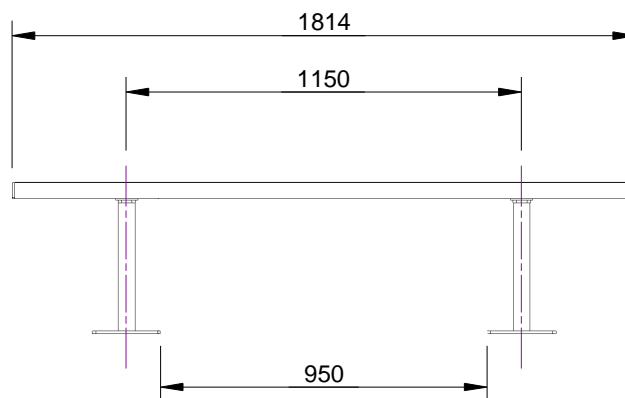
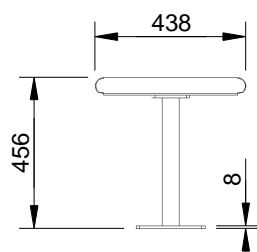
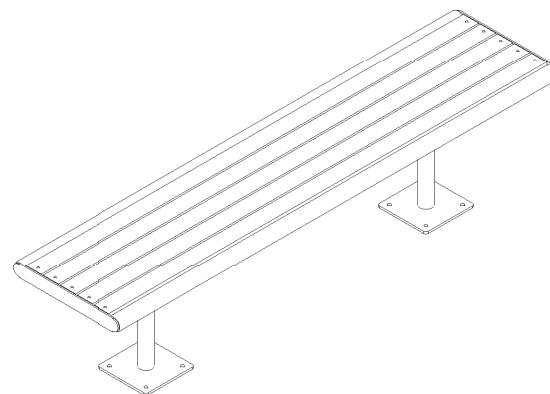
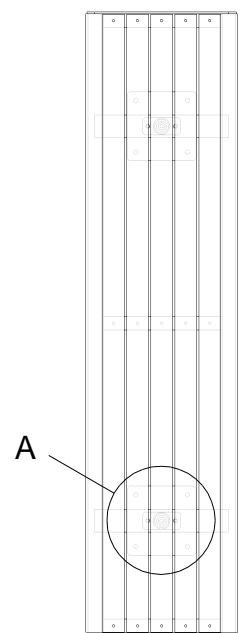

DETAIL A  
TIMBER SLATS REMOVED FOR CLARRITY



copyright

CONFIDENTIAL

REVISION #	DESCRIPTION	BY	DATE	DRAWN	DRAWN DATE	CHECKED	CHECKED DATE	SCALE	A4
2	FULL PRODUCT REVIEW	RBC	3.11.13						
3									
4									
5									

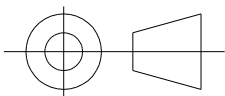

WOODGROVE BENCH - BOLT DOWN SPEC.

FFSB001004

REV. 2

SHEET 1 OF 3



Quality  
ISO 9001  
SAI GLOBAL

# SPECIFICATION:

**Material:**  
Frame & Slats: Mild Steel Construction

**Dimensions:**  
All in mm unless otherwise stated

**Finish:**  
Steel - Galvanised and optional Powder Coat

**Ground Fixings:**  
Bolt Down

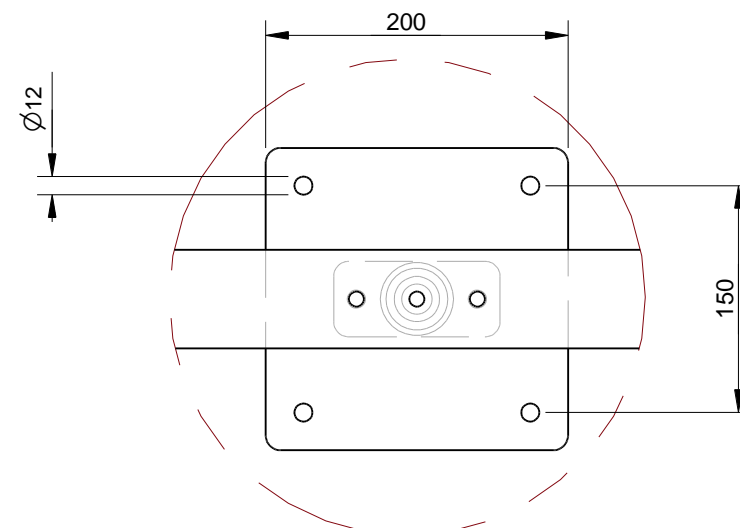
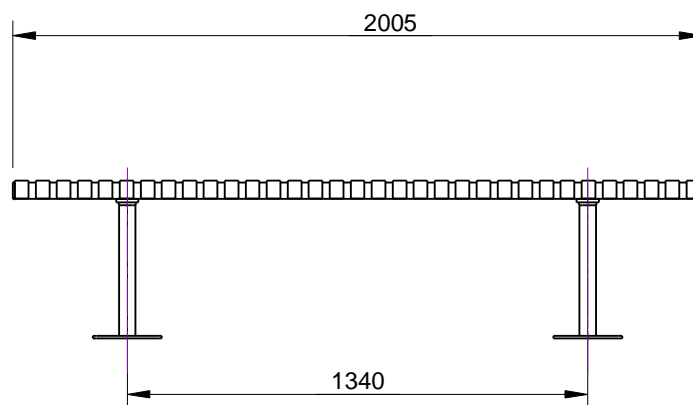
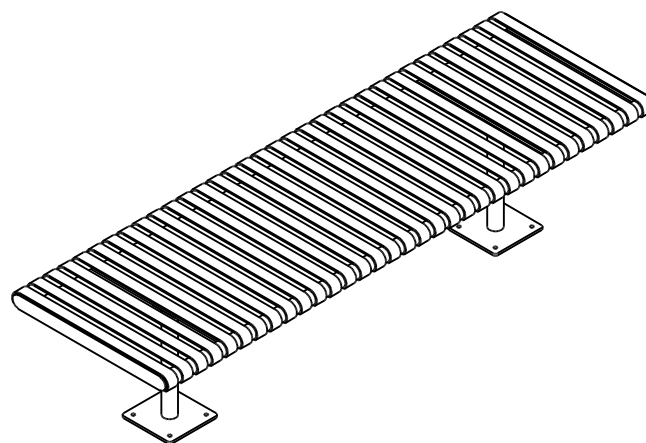
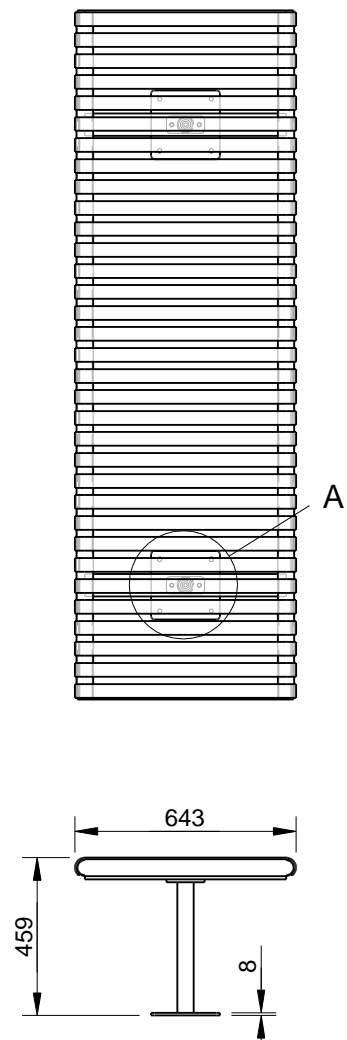

Detail A  
SLATS REMOVED  
FOR CLARITY

© copyright  
CONFIDENTIAL

REVISION #	DESCRIPTION	BY	DATE	DRAWN	DRAWN DATE	CHECKED	CHECKED DATE	SCALE	A4
2	FULL PRODUCT REVIEW	RBC	11.12.13						
3									
4									
5									

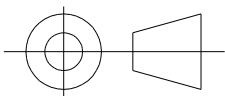

STEEL SLATTED BENCH - BOLT DOWN SPEC.

FFSB001005

REV. 2 SHEET 1 OF 2



Quality  
ISO 9001



# SPECIFICATION:

**Material:**  
Frame & Slats: Mild Steel Construction

**Dimensions:**  
All in mm unless otherwise stated

**Finish:**  
Steel - Galvanised and optional Powder Coat

**Ground Fixings:**  
In ground

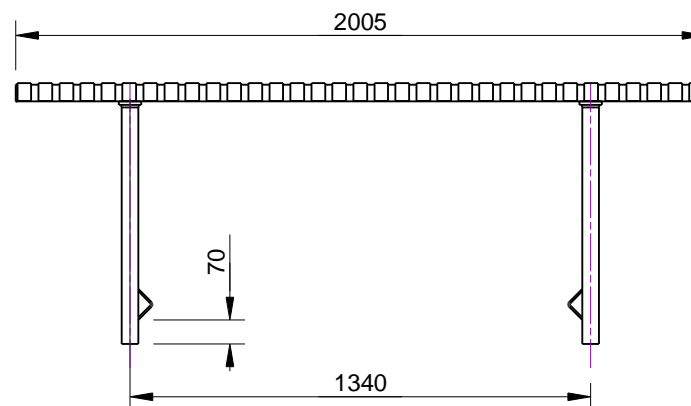
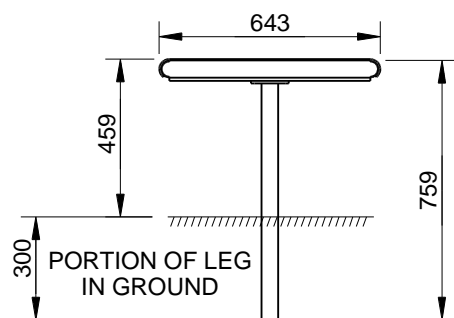
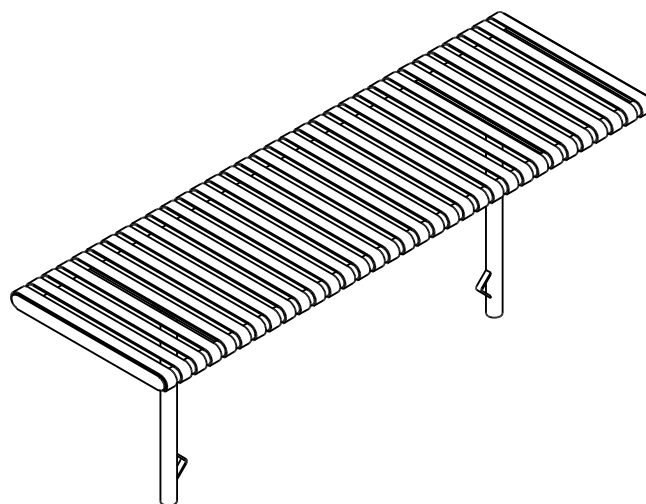
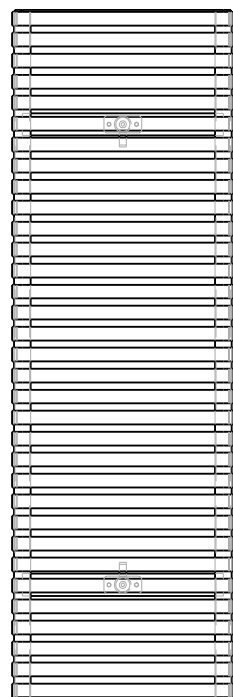

CONFIDENTIAL

REVISION	#	DESCRIPTION	BY	DATE	DRAWN	DRAWN DATE	CHECKED	CHECKED DATE	SCALE	A4
	1	ORIGINAL DRAWING	DN	19.7.10	R.CRIGTON	11.12.13			N/A	
2	FULL PRODUCT REVIEW	RBC	11.12.13							
3										
4										
5										

STEEL SLATTED BENCH - IN GROUND SPEC.

FFSB001007

REV. 2

SHEET 1 OF 2





Quality  
ISO 9001  
SAI GLOBAL

# SPECIFICATION:

**Material:**

Frame: Mild Steel Construction  
Slats: Hardwood Timber 63x30mm

**Dimensions:**

All in mm unless otherwise stated

**Finish:**

Steel - Galvanised and optional Powder Coat  
Timber - Oil Based

**Ground Fixings:**

In Ground



CONFIDENTIAL

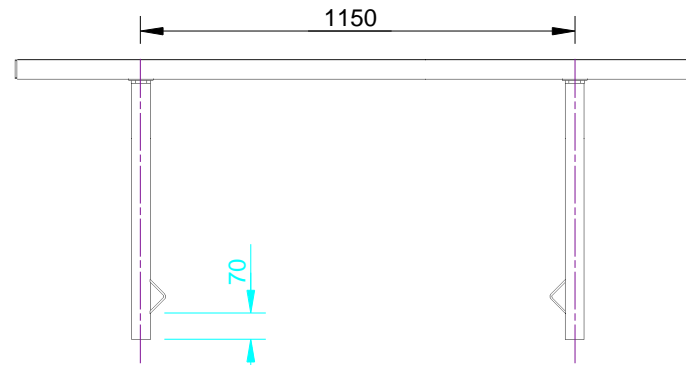
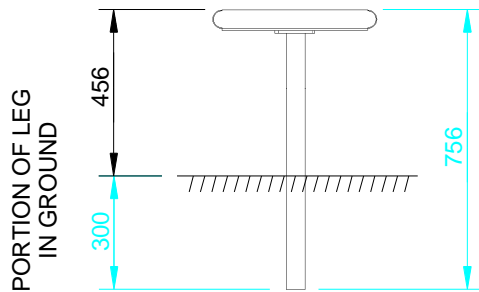
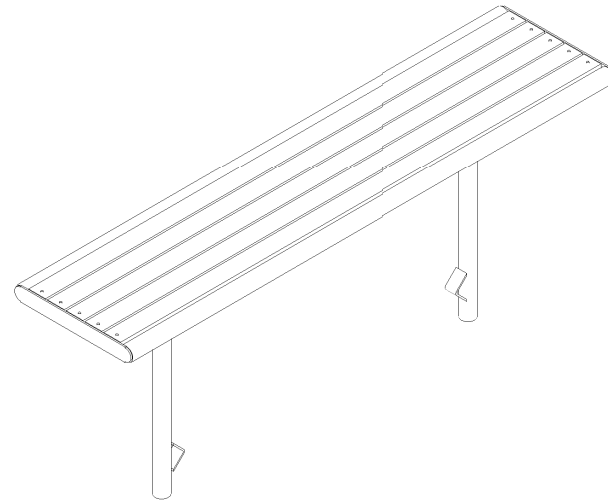
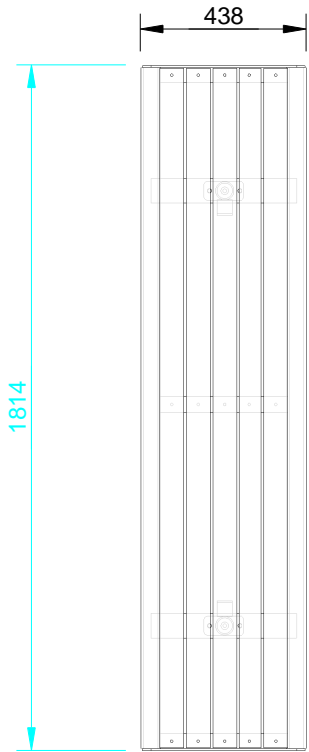

REVISION #	DESCRIPTION	BY	DATE	DRAWN	DRAWN DATE	CHECKED	CHECKED DATE	SCALE	A4
								N/A	
1	ORIGINAL DRAWING	SJ	26.5.10	R.CRIGTON	2.11.13				
2	FULL PRODUCT REVIEW	RBC	2.11.13						
3									
4									
5									

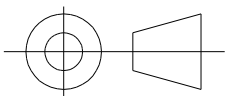

WOODGROVE BENCH - IN GROUND SPEC.

FFSB001008 REV. 2 SHEET 1 OF 3

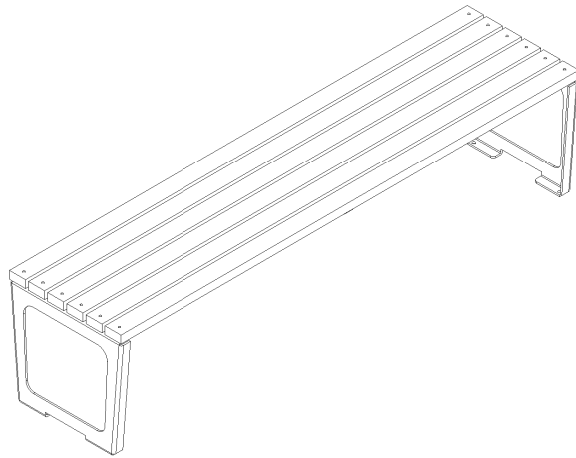
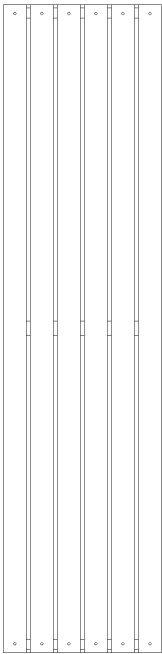

## SPECIFICATION:

### MATERIALS:

Main construction - Mild Steel  
Timbers Slats - Hardwood Timber

### DIMENSIONS:

mm unless otherwise stated

### FINISH:

Galvanised or Optional Powder Coat  
Timber - Oil Based

### GROUND ATTACHMENT:

Bolt down

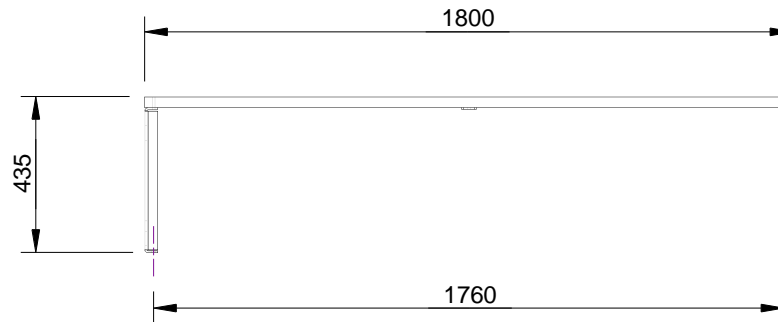
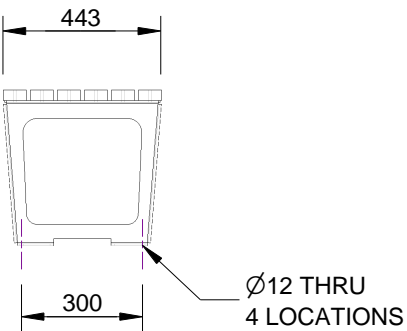

Quality  
ISO 9001  
SAI GLOBAL



CONFIDENTIAL

REVISION #	DESCRIPTION	BY	DATE	DRAWN	DRAWN DATE	CHECKED	CHECKED DATE	SCALE	A4
								N/A	
1	ORIGINAL DRAWING	DN	10.6.10	R.CRIGTON	17.3.14				
2	FULL PRODUCT REVIEW	RBC	17.3.14						
3									
4									
5									
						CIVIC BENCH SPEC.			
					FFSB001017		REV. 2	SHEET 1 OF 2	



Quality  
ISO 9001  
SAI GLOBAL

# SPECIFICATION:

**MATERIAL:**  
Frame: Mild Steel Construction  
Slats: Hardwood Timber 63x30mm

**DIMENSIONS:**  
All in mm unless otherwise stated

**FINISH:**  
Steel - Galvanised and optional Powder Coat  
Timber - Oil Based

**GROUND FIXINGS:**  
Bolt Down

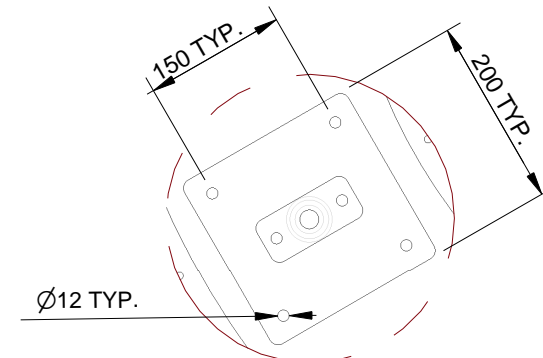
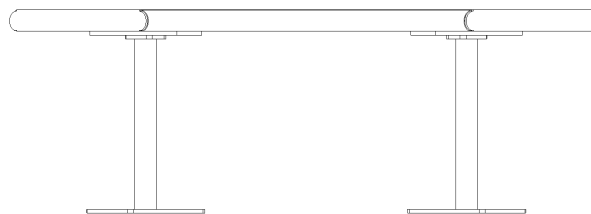
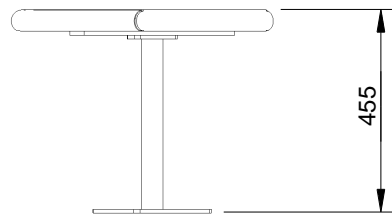
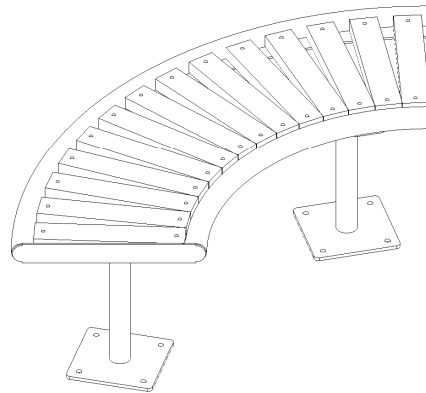
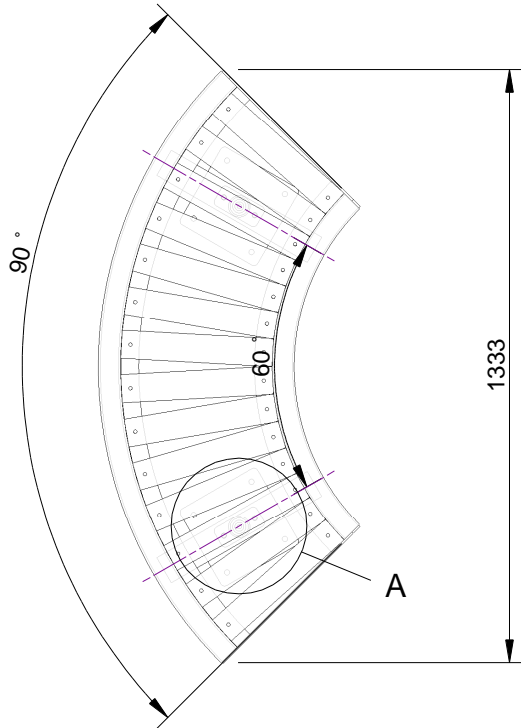

Detail A  
TIMBER SLATS REMOVED FOR CLARRITY



CONFIDENTIAL

REVISION #	DESCRIPTION	BY	DATE	DRAWN	DRAWN DATE	CHECKED	CHECKED DATE	SCALE
								A4
1	ORIGINAL DRAWING	RBC	18.11.13	R.CRIGTON	18.11.13			N/A
2								
3								
4								
5								

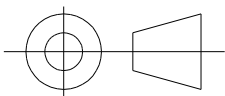

WOODGROVE CIRCULAR BENCH (1800 OD)  
- BOLT DOWN - SPEC.

FFSB001018

REV. 1

SHEET 1 OF 3

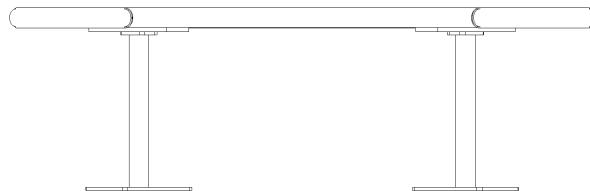
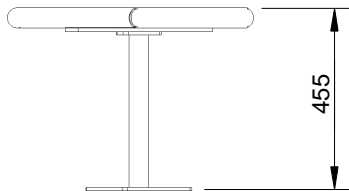
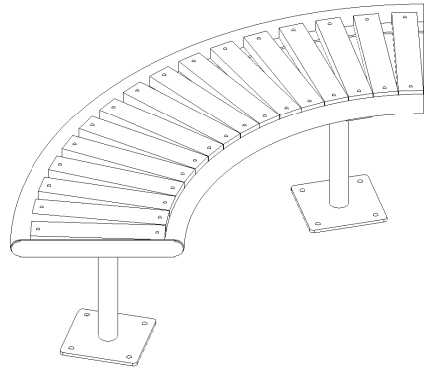
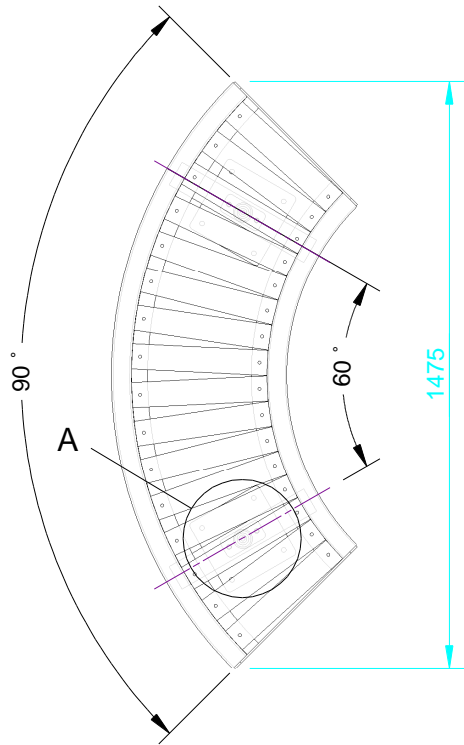

## SPECIFICATION:

### MATERIAL:

Frame: Mild Steel Construction  
Slats: Hardwood Timber 63x30mm

### DIMENSIONS:

All in mm unless otherwise stated

### FINISH:

Steel - Galvanised and optional Powder Coat  
Timber - Oil Based

### GROUND FIXINGS:

Bolt Down

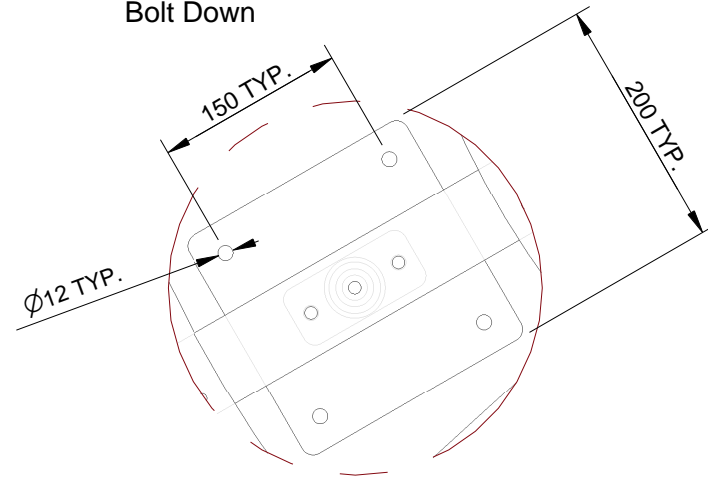

Detail A  
TIMBER SLATS REMOVED  
FOR CLARRITY



Quality  
ISO 9001



copyright

CONFIDENTIAL

REVISION	#	DESCRIPTION	BY	DATE	DRAWN	DRAWN DATE	CHECKED	CHECKED DATE	SCALE	A4
	1		ORIGINAL DRAWING	RBC	19.11.13	R.CRIGTON	19.11.13			
2										
3										
4										
5										

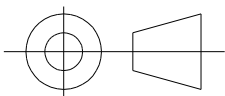

WOODGROVE CIRCULAR BENCH (2080 OD)  
- BOLT DOWN - SPEC.

FFSB001019

REV.  
1

SHEET  
1 OF 3

## SPECIFICATION:

### MATERIALS:

Main Construction - Mild Steel  
Timbers Slats - Hardwood Timber

### DIMENSIONS:

mm unless otherwise stated

### FINISH:

Galvanised with optional powder coat  
Timber - Oil Based

### GROUND ATTACHMENT:

Bolt down

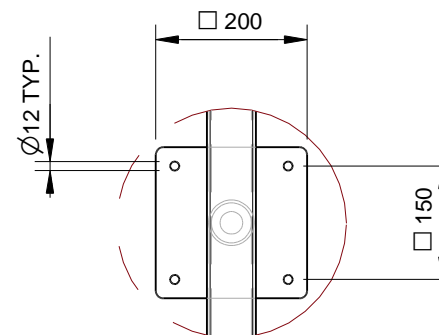
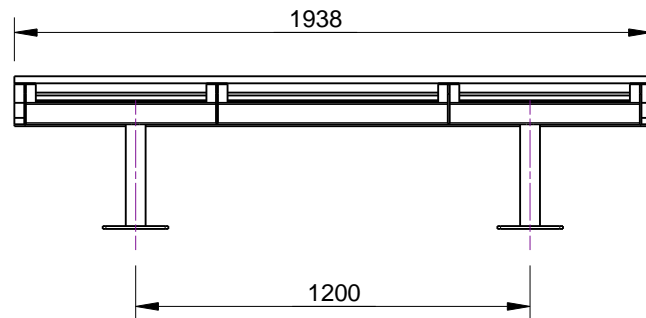
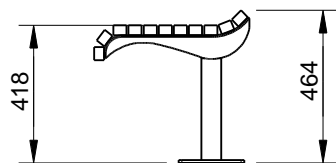
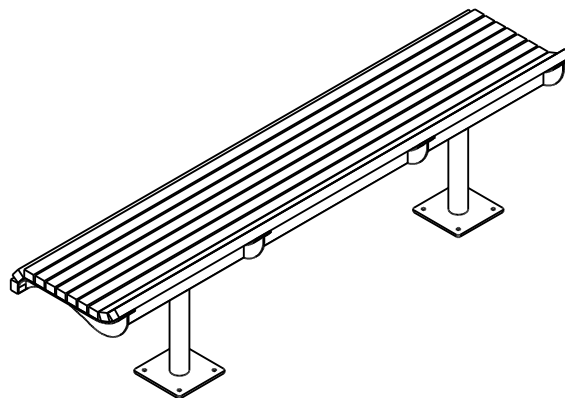
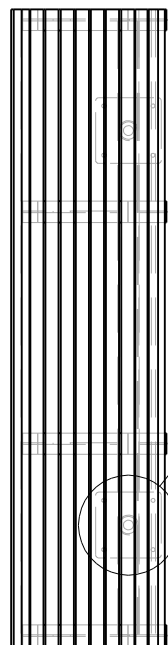

Detail A  
TIMBER SLAT REMOVED  
FOR CLARRITY

© copyright

CONFIDENTIAL

REVISION	#	DESCRIPTION	BY	DATE	DRAWN	DRAWN DATE	CHECKED	CHECKED DATE	SCALE	A4
	1	1	ORIGINAL DRAWING	RBC	1.4.14	R.CRIGTON	1.4.14			
2	2									
3	3									
4	4									
5	5									

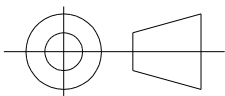

PARKLANE BENCH (DUCK TAIL) - BOLT DOWN SPEC.

FFSB001020

REV. 1

SHEET 1 OF 2

## SPECIFICATION:

### MATERIALS:

Main Construction - Mild Steel  
Timbers Slats - Hardwood Timber

### DIMENSIONS:

mm unless otherwise stated

### FINISH:

Galvanised with optional powder coat  
Timber - Oil Based

### GROUND ATTACHMENT:

Bolt down

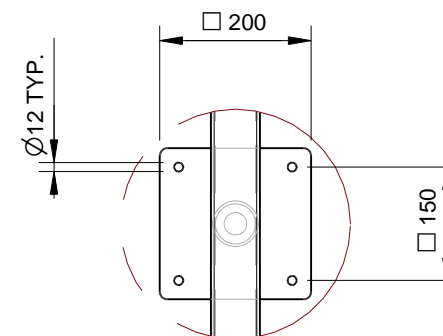
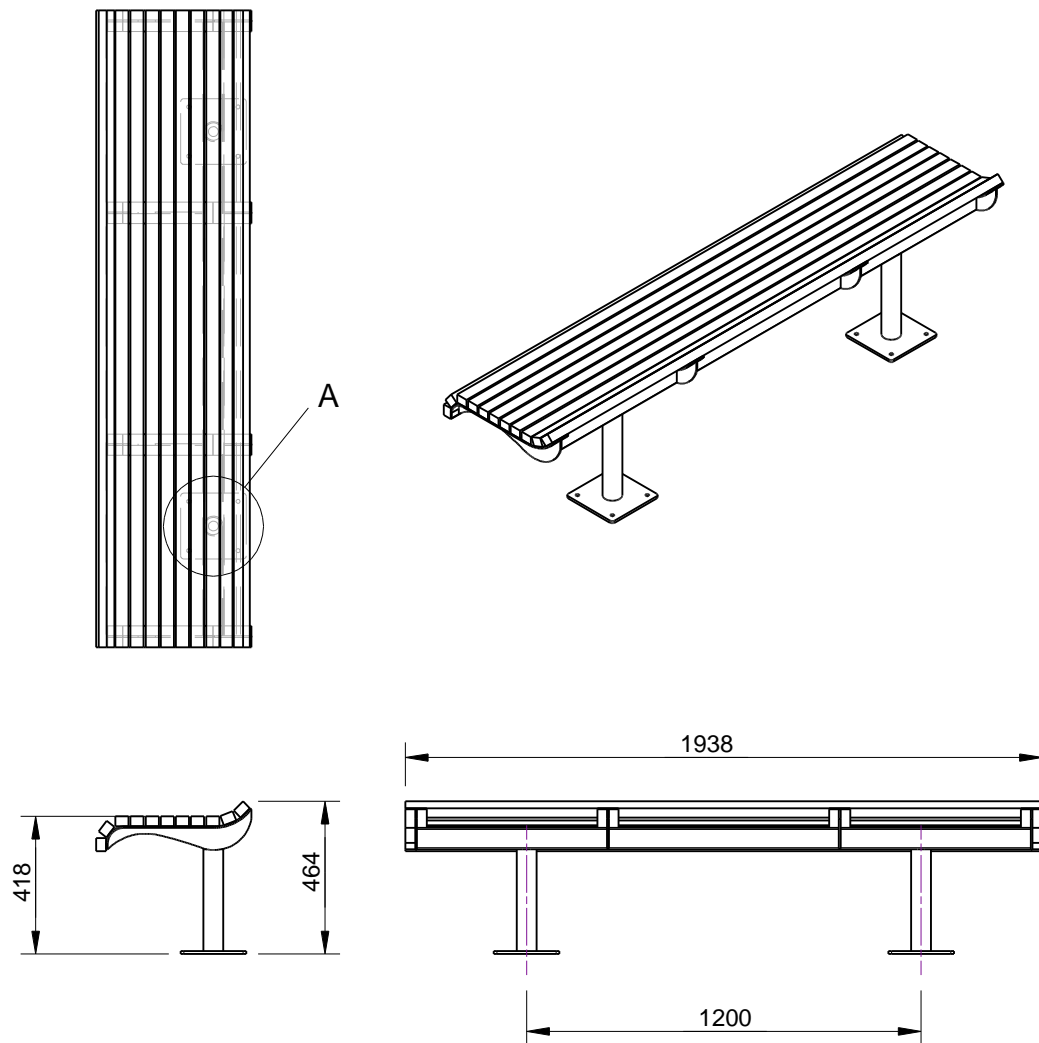

Detail A  
TIMBER SLAT REMOVED  
FOR CLARRITY

REVISION	#	DESCRIPTION	BY	DATE	DRAWN	DRAWN DATE	CHECKED	CHECKED DATE	SCALE	A4
	1		ORIGINAL DRAWING	RBC	1.4.14	R.CRIGTON	1.4.14			
2										
3										
4										
5										

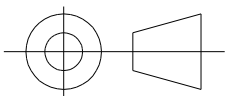

PARKLANE BENCH (DUCK TAIL) - BOLT DOWN SPEC.

FFSB001020

REV. 1

SHEET 1 OF 2

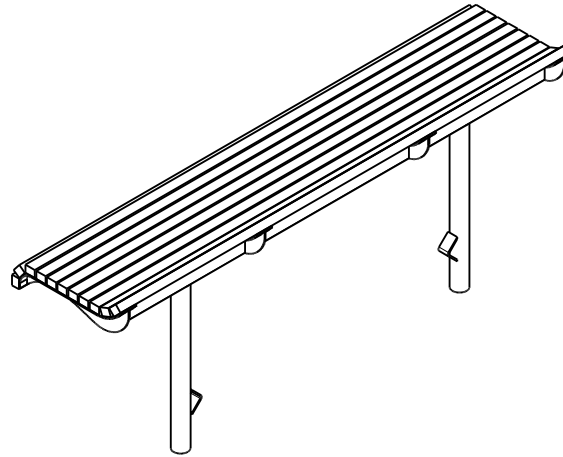
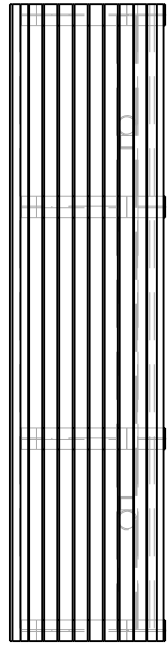

## SPECIFICATION:

### MATERIALS:

Main Construction - Mild Steel  
Timbers Slats - Hardwood Timber

### DIMENSIONS:

mm unless otherwise stated

### FINISH:

Galvanised with optional powder coat  
Timber - Oil Based

### GROUND ATTACHMENT:

In ground



Quality  
ISO 9001  
SAI GLOBAL

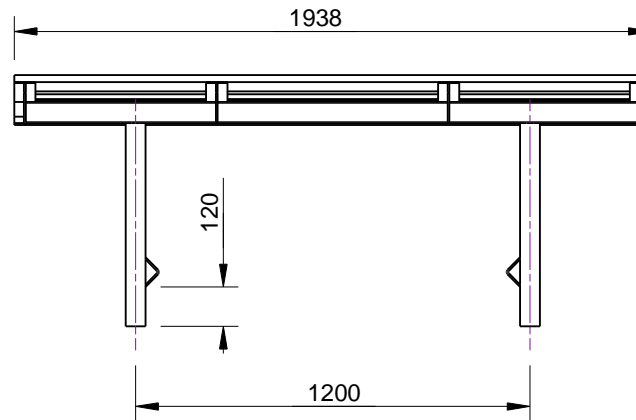
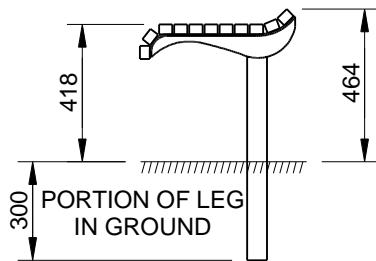

CONFIDENTIAL

REVISION #	DESCRIPTION	BY	DATE	DRAWN	DRAWN DATE	CHECKED	CHECKED DATE	SCALE
								A4
1	ORIGINAL DRAWING	RBC	1.4.14	R.CRIGTON	1.4.14			N/A
2								
3								
4								
5								

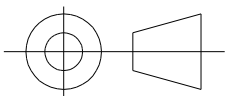

PARKLANE BENCH (DUCK TAIL) - IN GROUND SPEC.

FFSB001021

REV. 1 SHEET 1 OF 2

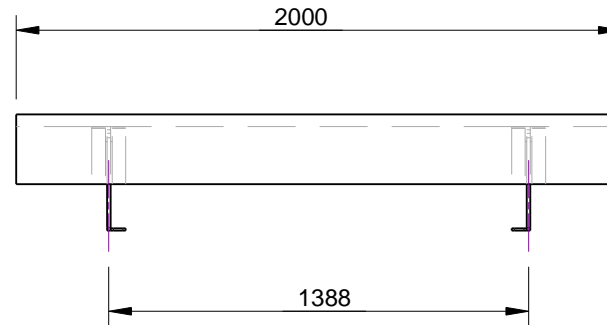
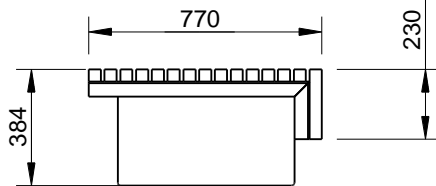
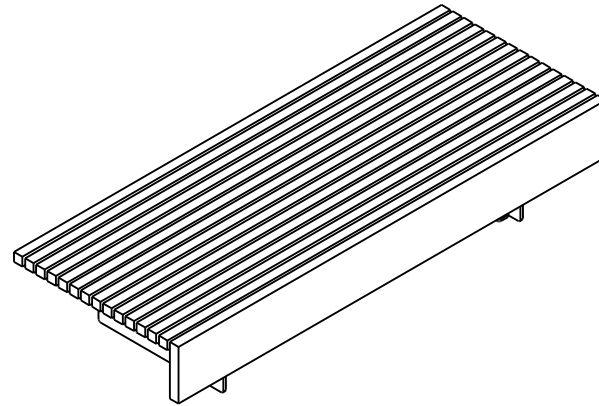
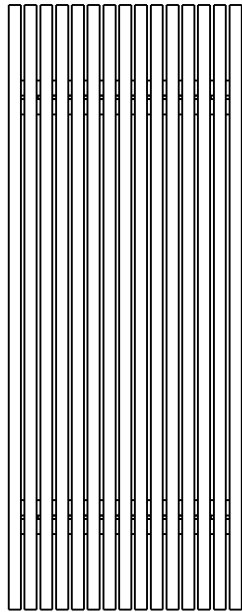

## SPECIFICATION:

### MATERIALS:

Main Construction - Mild Steel  
Timbers Slats - Hardwood Timber

### DIMENSIONS:

mm unless otherwise stated

### FINISH:

Galvanised with optional powder coat  
Timber - Oil Based

### GROUND ATTACHMENT:

Bolt down



Quality  
ISO 9001



CONFIDENTIAL

REVISION	#	DESCRIPTION	BY	DATE	DRAWN	DRAWN DATE	CHECKED	CHECKED DATE	SCALE	A4
	1	1	ORIGINAL DRAWING	RBC	2.4.14	R.CRIGTON	2.4.14			
2	2						ERCILDOUNE BENCH - BOLT DOWN SPEC.			
3	3									
4	4						FFSB001024			
5	5									

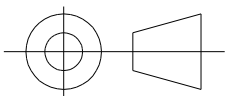

REV. 1 SHEET 1 OF 2



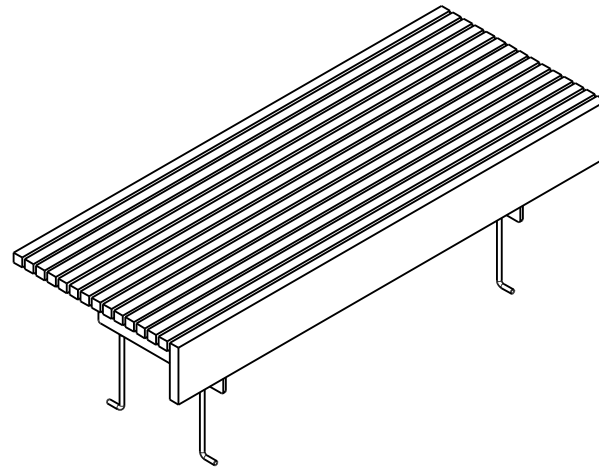
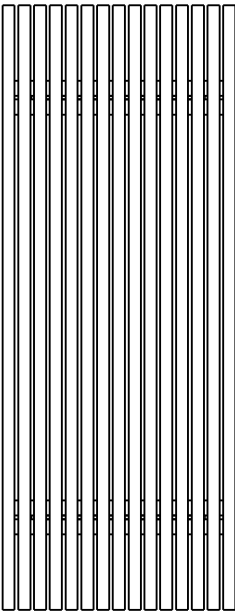

**SPECIFICATION:**

**MATERIALS:**

Main Construction - Mild Steel  
Timbers Slats - Hardwood Timber

**DIMENSIONS:**

mm unless otherwise stated

**FINISH:**

Galvanised with optional powder coat  
Timber - Oil Based

**GROUND ATTACHMENT:**

In ground



Quality  
ISO 9001  
SAI GLOBAL

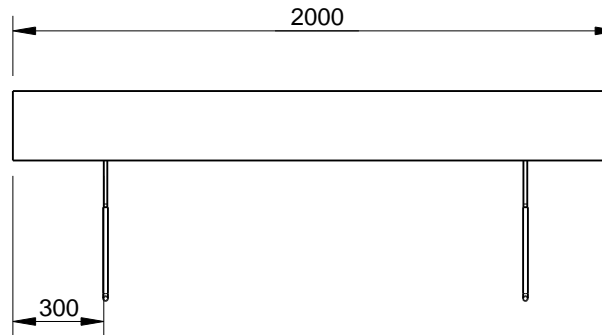
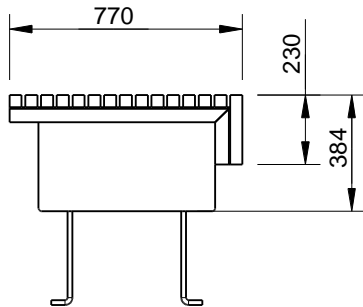

CONFIDENTIAL

REVISION #	DESCRIPTION	BY	DATE	DRAWN	DRAWN DATE	CHECKED	CHECKED DATE	SCALE	
								A4	
1	ORIGINAL DRAWING	SJ	3.11.10	R.CRIGTON	2.4.14			N/A	
2	FULL PRODUCT REVIEW	RBC	2.4.14					ERCILDOUNE BENCH - IN GROUND SPEC.	
3									
4									
5									

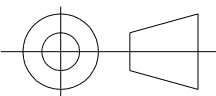

FFSB001025

REV. 2

SHEET 1 OF 2



Quality  
ISO 9001  
SAI GLOBAL

# SPECIFICATION:

## MATERIAL:

Main construction - 304 Stainless steel  
Slats - Hardwood timber  
Fixings - Stainless steel

## DIMENSIONS:

mm unless otherwise stated

## FINISH:

Stainless steel components - Polished  
Timbers - Oil based

## GROUND ATTACHEMENT:

Bolt down

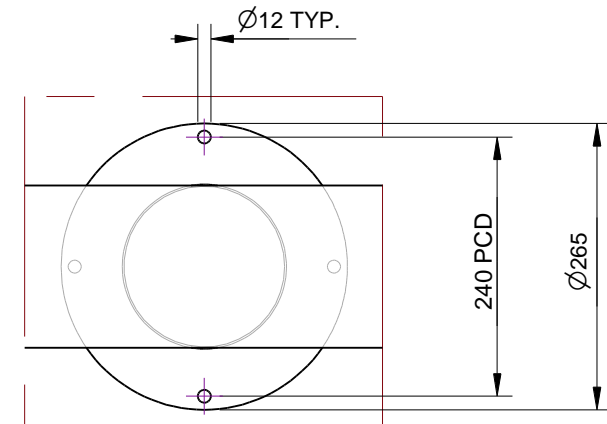
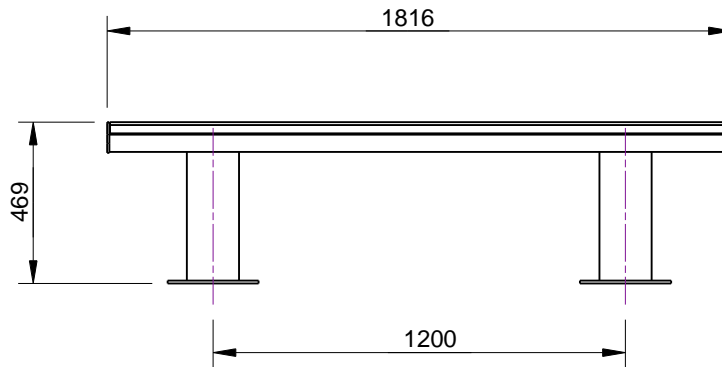
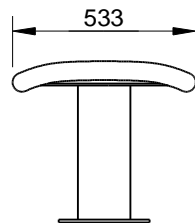
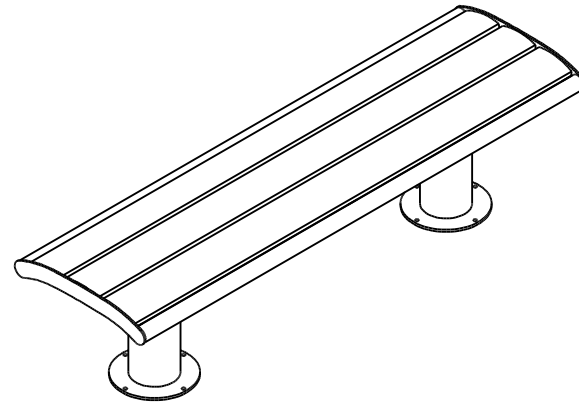
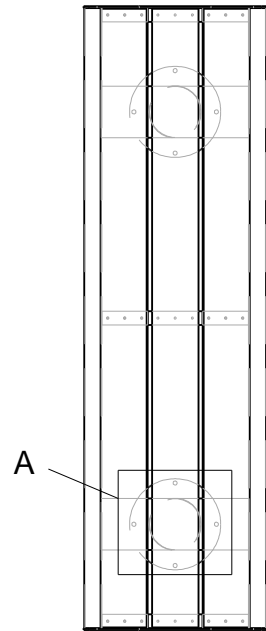

Detail A  
BOLT DOWN DETAIL  
SLATS REMOVED  
FOR CLARITY



CONFIDENTIAL

REVISION #	DESCRIPTION	BY	DATE	DRAWN	DRAWN DATE	CHECKED	CHECKED DATE	SCALE	A4
								N/A	
1	ORIGINAL DRAWING	DN	4.11.10	R.CRIGTON	3.2.14				
2	FULL PRODUCT REVIEW	RBC	3.2.14						
3									
4									
5									
						LYNDARUM BENCH - BOLT DOWN SPEC.			
							FFSC001001	REV. 2	SHEET 1 OF 2

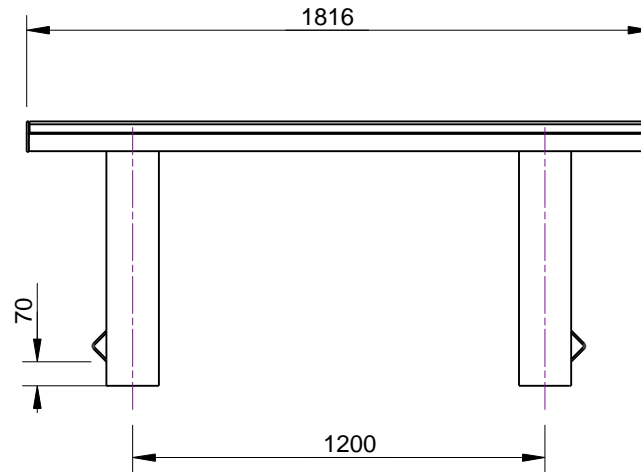
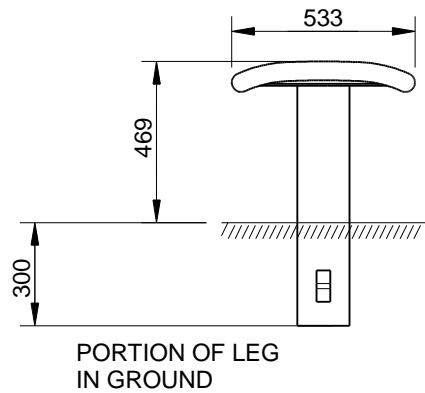
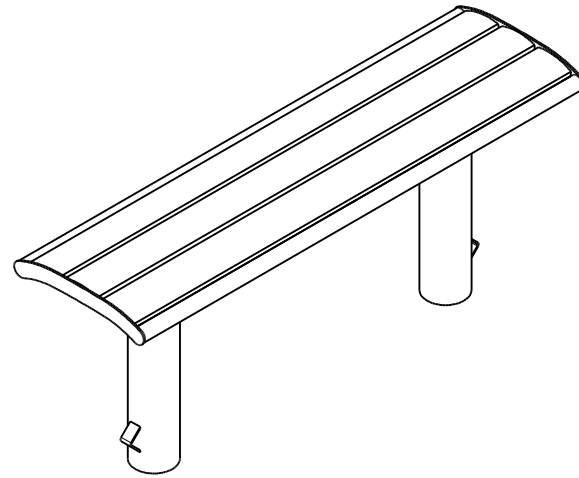
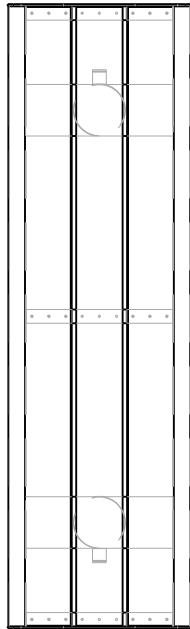

## SPECIFICATION:

### MATERIAL:

Main construction - 304 Stainless steel  
Slats - Hardwood timber  
Fixings - Stainless steel

### DIMENSIONS:

mm unless otherwise stated

### FINISH:

Stainless steel components - Polished  
Timbers - Oil based

### GROUND ATTACHEMENT:

In ground



Quality  
ISO 9001  
SAI GLOBAL



CONFIDENTIAL

REVISION	#	DESCRIPTION	BY	DATE	DRAWN	DRAWN DATE	CHECKED	CHECKED DATE	SCALE	A4
	1	ORIGINAL DRAWING	DN	4.11.10	R.CRIGTON	4.2.14			N/A	
2	FULL PRODUCT REVIEW	RBC	4.2.14							
3										
4										
5										

LYNDARUM BENCH - IN GROUND  
SPEC.

FFSC001002

REV. 2

SHEET 1 OF 2